

SUBJECT: PLANS AND PROPOSAL ADDENDUMS

PROJECT: BR 2023(064)

CONTROL: 0917-17-076

COUNTY: GRIMES

LETTING: 08/02/2023

REFERENCE NO: 0724

PROPOSAL ADDENDUMS

- PROPOSAL COVER
- BID INSERTS (SH. NO.:)
- GENERAL NOTES (SH. NO.:)
- SPEC LIST (SH. NO.:)
- SPECIAL PROVISIONS:
- ADDED:

DELETED:

- SPECIAL SPECIFICATIONS:
- ADDED:

DELETED:

X OTHER: PLAN SHEET CHANGES

DESCRIPTION OF ABOVE CHANGES
(INCLUDING PLANS SHEET CHANGES)

***** PLAN SHEETS *****

SHEET 3 (INDEX): ADDED SHEET 17A

SHEET 17A: ADDED ADVANCED WARNING SIGNS - CR 215 SHEET

SHEET 18: REVISED TRAFFIC CONTROL PLAN & SEQUENCE OF CONSTRUCTION - CR 215

SHEET 19: REVISED DETOUR SIGNAGE FOR CR 412

REV DATE: 12-6-2022
 CSJ: 0917-17-076.ETC
 FILENAME: p:\Project\Wise\AMER\jacobs.com\jacobs_US_B_L_SSA\Documents\WJXN4000_BRY_Bridge_Program\WJXN4000\91717076_CR201700 CADD\SH\GENR\CR201_CR215_CR412_INDEX_01.dgn

SHEET	DESCRIPTION
GENERAL	
1	TITLE SHEET
2	PROJECT LOCATION MAP
3	INDEX OF SHEETS
4	EXISTING TYPICAL SECTIONS - CR 201
5	PROPOSED TYPICAL SECTIONS - CR 201
6	EXISTING TYPICAL SECTIONS - CR 215
7	PROPOSED TYPICAL SECTIONS - CR 215
8	EXISTING TYPICAL SECTIONS - CR 412
9	PROPOSED TYPICAL SECTIONS - CR 412
10, 10A - 10C	GENERAL NOTES
11, 11A	ESTIMATE AND QUANTITIES
QUANTITY SUMMARY SHEETS	
12	ROADWAY & TCP SUMMARY
13	SUMMARY OF SMALL SIGNS
14	SUMMARY OF SW3P QUANTITIES
TRAFFIC CONTROL PLAN	
15	SEQUENCE OF CONSTRUCTION - CR 201
16	TRAFFIC CONTROL PLAN PHASE 1 - CR 201
17	TRAFFIC CONTROL PLAN PHASE 2 - CR 201
17A	ADVANCED WARNING SIGNS - CR 215
18	TRAFFIC CONTROL PLAN & SEQUENCE OF CONSTRUCTION - CR 215
19	ADVANCED WARNING SIGNS - CR 412
20	TRAFFIC CONTROL PLAN & SEQUENCE OF CONSTRUCTION - CR 412
TRAFFIC CONTROL PLAN STANDARDS	
21 - 32	BC(1)-(12)-21*
33	TCP(1-2)-18*
34	TCP(2-8)-18*
35	WZ(RCD)-13*
36 - 37	LPCB-13*
38	TREATMENT FOR VARIOUS EDGE CONDITIONS
ROADWAY	
39 - 40	SURVEY CONTROL - CR 201
41 - 42	SURVEY CONTROL - CR 215
43 - 44	SURVEY CONTROL - CR 412
45	HORIZONTAL ALIGNMENT DATA - CR 201
46	HORIZONTAL ALIGNMENT DATA - CR 215
47	HORIZONTAL ALIGNMENT DATA - CR 412
48	PLAN AND PROFILE - CR 201
49	PLAN AND PROFILE - CR 215
50	PLAN AND PROFILE - CR 412
51	TREE REMOVAL LAYOUT - CR 215
52	TREE REMOVAL LAYOUT - CR 412
53	SIGNS AND OBJECT MARKERS - CR 201
54	SIGNS AND OBJECT MARKERS - CR 215
55	SIGNS AND OBJECT MARKERS - CR 412
ROADWAY STANDARDS	
56	CRR*
57	GF(31)-19*
58	GF(31)TRTL2-19*
59	BED-14*
60	SGT(10S)31-16*
61	SGT(11S)31-18*
62	SGT(12S)31-18*
63	SGT(15)31-20*
64 - 66	D&OM(1)-20 TO D&OM(3)-20*
67	D&OM(5)-20*
68	D&OM(VIA)-20*
69	SMD(GEN)-08*
70 - 72	SMD(SLIP-1)-08 TO SMD(SLIP-3)-08*

SHEET	DESCRIPTION
BRIDGE	
73	CR 201 AT MILL CREEK
74	DRAINAGE AREA MAP
75	HYDRAULIC DATA SHEET
76	SCOUR DATA SHEET
77	BRIDGE LAYOUT
78	TEST HOLE DATA
79	ESTIMATED QUANTITIES
	TOP OF CAP ELEVATIONS
CR 215 AT BUMS CREEK	
80	DRAINAGE AREA MAP
81	HYDRAULIC DATA SHEET
82	SCOUR DATA SHEET
83	BRIDGE LAYOUT
84	TEST HOLE DATA
85	ESTIMATED QUANTITIES
86	TOP OF CAP ELEVATIONS
CR 412 AT GRASSY CREEK	
87	DRAINAGE AREA MAP
88	HYDRAULIC DATA SHEET
89	SCOUR DATA SHEET
90	BRIDGE LAYOUT
91	TEST HOLE DATA
92	ESTIMATED QUANTITIES
93	TOP OF CAP ELEVATIONS
BRIDGE STANDARDS	
94	NBI NUMBER LABELS
95 - 96	SBBS-B20-24 (MOD)
97	SPSB-24 (MOD)
98 - 99	ABB-24*
100	AJ*
101	APSB-24*
102	APSB-24-15*
103 - 105	BB-B20*
106	BBEB*
107	BBRAS*
108	BBSDS-B20-24*
109	BPSB-24-15*
110 - 111	CSAB*
112 - 113	FD*
114 - 115	PBC-RC*
116	PSB-5SB12*
117	PSB-5SB15*
118	PSBEB*
119	PSBRA*
120	PSBSD*
121	SPSB-24-15*
122 - 123	SRR*
124 - 126	T223*
SW3P	
127 - 128	STORM WATER POLLUTION PREVENTION PLAN (SWP3) - CR 201
129 - 130	STORM WATER POLLUTION PREVENTION PLAN (SWP3) - CR 215
131 - 132	STORM WATER POLLUTION PREVENTION PLAN (SWP3) - CR 412
133	EPIC - CR 201
134	EPIC - CR 215
135	EPIC - CR 412
136	SW3P LAYOUT - CR 201
137	SW3P LAYOUT - CR 215
138	SW3P LAYOUT - CR 412
SW3P STANDARDS	
139	EC(1)-16*
140	EC(2)-16*
141	EC(3)-16*

* THE STANDARD SPECIFICALLY IDENTIFIED HAVE BEEN SELECTED BY ME OR UNDER MY RESPONSIBLE SUPERVISION AS BEING APPLICABLE TO THIS PROJECT.

JAMIE M. FURNEY, P.E. 7/17/2023

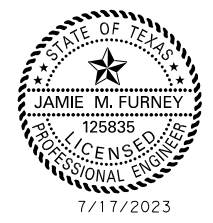

NO.	DATE	REVISION	BY
6	7/17/2023	ROAD CLOSURE AND DETOUR	JIA

Jacobs 2705 BEE CAVE RD, SUITE 300
 AUSTIN TX 78746
 FIRM REGISTRATION F-2966

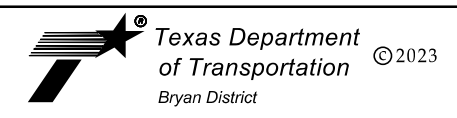

INDEX OF SHEETS

FED. RD. DIV. NO.	PROJECT NUMBER	HIGHWAY NUMBER	
6	BR 2023(064).ETC.	CR	
STATE	DISTRICT	COUNTY	
TEXAS	BRY	GRIMES	
CONTROL	SECTION	JOB	SHEET NO.
0917	17	076.ETC	3

REV DATE: 7/18/2023
 CSJ: 0917-17-076.ETC
 FILENAME: p:\Project\Wise\AMER\jacobs_US_B_I_SSA\Documents\WJXN4000_BRY_Bridge_Program\WJXN4000\1717077_CR215\700_CADD\SH\T\RD\WV\CR215_AWS.dgn

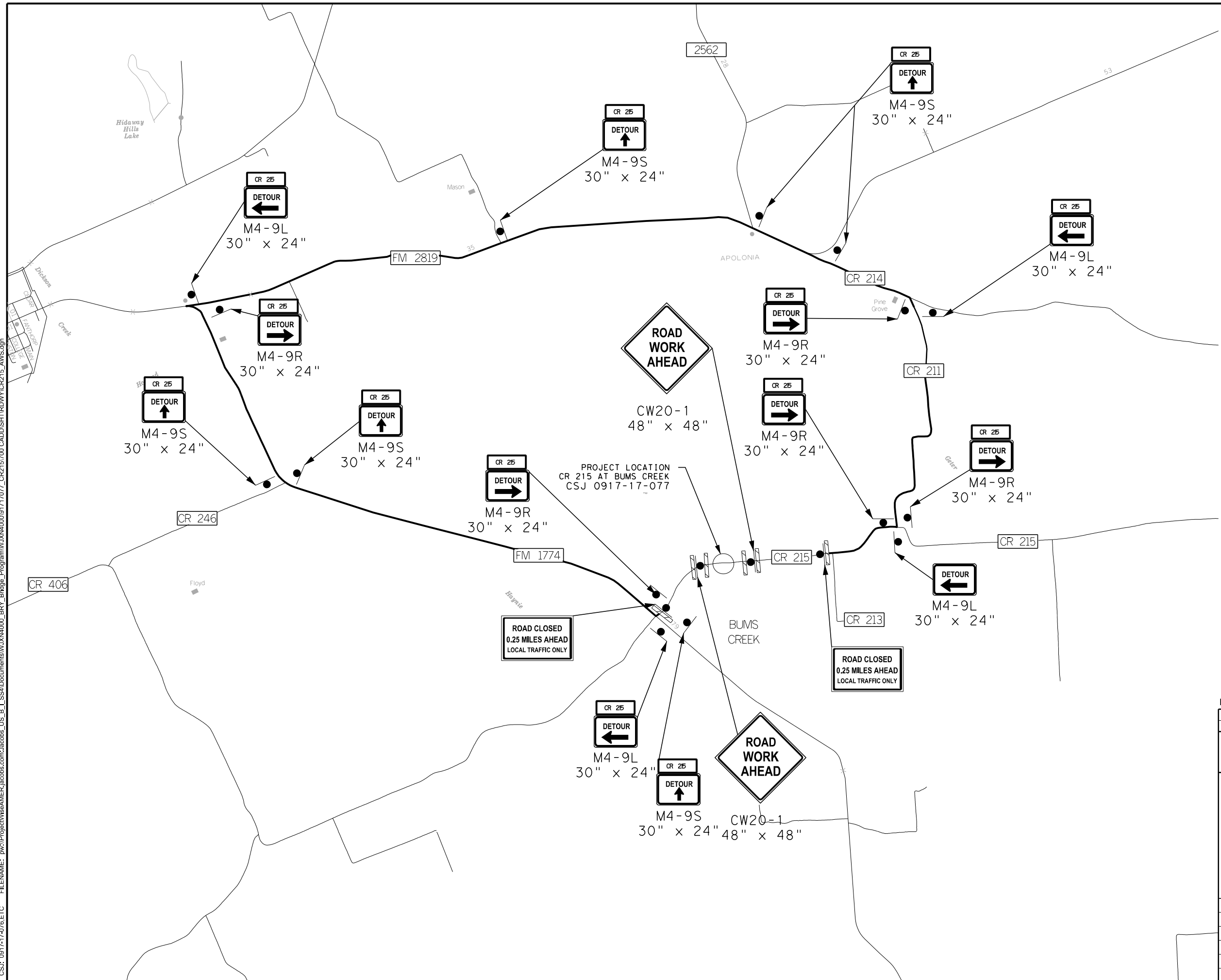

- NOTES:
1. PLACE SIGNS IN ACCORDANCE WITH TXDOT STANDARDS BC(1)-BC(12)-21, WZ(RCD) AND TEXAS MANUAL ON UNIFORM TRAFFIC CONTROL DEVICES.
 2. ADJUST SIGNING AS NECESSARY TO FIT FIELD CONDITIONS OR AS DIRECTED.
 3. SEE TRAFFIC CONTROL PLAN FOR PLACEMENT OF ADDITIONAL SIGNS.

- LEGEND
- TYPE III BARRICADE
 - DETOUR SIGN
 - DETOUR ROUTE

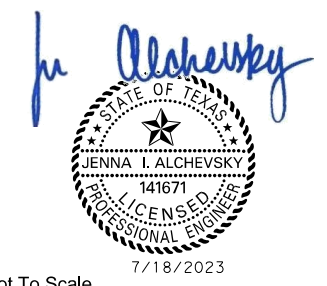

Drawings Not To Scale

NO.	DATE	REVISION	BY
1	7/18/2023	ROAD CLOSURE AND DETOUR	JIA

Jacobs 2705 BEE CAVE RD, SUITE 300
 AUSTIN TX 78746
 FIRM REGISTRATION F-2966



**ADVANCED WARNING SIGNS
 CR 215**

FED. RD. DIV. NO.	PROJECT NUMBER	HIGHWAY NUMBER	
6	BR 2023(064).ETC.	CR	
STATE	DISTRICT	COUNTY	
TEXAS	BRY	GRIMES	
CONTROL	SECTION	JOB	SHEET NO.
0917	17	076.ETC	17A

SEQUENCE OF CONSTRUCTION

MAINTAIN TEMPORARY DRAINAGE AT ALL TIMES. TEMPORARY DRAINAGE SHALL BE CONSIDERED SUBSIDIARY TO THE OTHER BID ITEMS. EXISTING SIGNS THAT CONFLICT WITH THE TEMPORARY TRAFFIC CONTROL PLAN SHALL BE REMOVED OR COVERED AS DIRECTED.

PHASE 1:
ONE WEEK PRIOR TO CONSTRUCTION, SET UP ONE PORTABLE CHANGEABLE MESSAGE SIGN (PCMS) AT THE INTERSECTION OF CR 215 & FM 1774 AND CR 215 & CR 213 TO ALERT PUBLIC TO UPCOMING CONSTRUCTION. INSTALL ADVANCED WARNING SIGNS IN ACCORDANCE WITH STANDARD BC(2)-21 AND ROAD CLOSURE SIGNS IN ACCORDANCE WITH STANDARD WZ(RCD)-13.

PHASE 2:
CLOSE CR 215 TO THRU TRAFFIC, SET UP DETOUR, AND INSTALL TEMPORARY SW3P DEVICES.



PHASE 3:
DEMOLISH EXISTING BRIDGE, CONSTRUCT NEW ROADWAY, GRADING, AND BRIDGE, AND TIE TO EXISTING PAVEMENT.

PHASE 4:
INSTALL METAL BEAM GUARD FENCE, GUARDRAIL END TREATMENTS, AND DELINEATORS/OBJECT MARKERS. COMPLETE PERMANENT SEEDING AND PLACE SIGNING. REMOVE ADVANCED WARNING SIGNS AND BARRICADES, AND OPEN ROADWAY.

PHASE 5:
RESTORE ROW BACK TO PRE-CONSTRUCTION CONDITIONS AND COMPLETE FINAL SITE CLEAN UP.



LEGEND

-  TRAFFIC SIGN
-  TYPE III BARRICADE
-  DIRECTION OF CREEK FLOW

NOTES:

1. LOCAL ACCESS SHALL BE MAINTAINED FOR THE EXISTING COUNTY ROADS, CROSS STREETS, AND DRIVEWAYS.
2. CONTRACTOR SHALL BE RESPONSIBLE FOR TEMPORARY DRAINAGE AT ALL TIMES, TO BE SUBSIDIARY TO OTHER BID ITEMS.
3. INSTALL ADVANCED WARNING SIGNS IN ACCORDANCE WITH TXDOT STANDARD BC(2)-21.
4. UTILIZE CHANNELING DEVICES TO CLOSE DRIVEWAYS UNDER CONSTRUCTION, ONCE AN ALTERNATE ACCESS IS PROVIDED.
5. SPACE CHANNELIZING DEVICES IN ACCORDANCE WITH TXDOT STANDARD BC(9)-21.

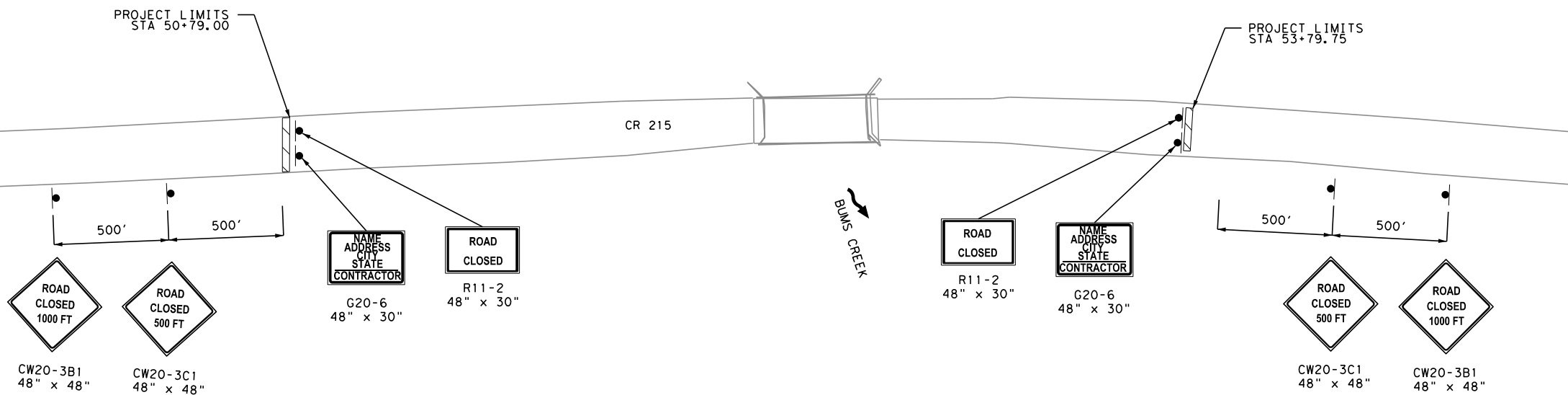

Drawings Not To Scale

NO.	DATE	REVISION	BY
1	7/17/2023	ROAD CLOSURE AND DETOUR	JIA

Jacobs 2705 BEE CAVE RD, SUITE 300
AUSTIN TX 78746
FIRM REGISTRATION F-2966



TRAFFIC CONTROL PLAN & SEQUENCE OF CONSTRUCTION
CR 215

FED. RD. DIV. NO.	PROJECT NUMBER	HIGHWAY NUMBER	
6	BR 2023(064),ETC.	CR	
STATE	DISTRICT	COUNTY	
TEXAS	BRY	GRIMES	
CONTROL	SECTION	JOB	SHEET NO.
0917	17	076,ETC	18

REV DATE: 12-6-2022
CSJ: 0917-17-076.ETC
FILENAME: p:\Project\Bry\AMER\jacobs\US_B_I_SSA\Documents\WJXN4000_BRY_Bridge_Program\WJXN4000\91717077_CR2151700_CADD\SH\TRD\WYCR215_TCP

REV DATE: 7/18/2023
 CSJ: 0917-17-076.ETC
 FILENAME: p:\Project\Wise\AMER\jacobs_US_B_L_SSA\Documents\WJXN4000_BRY_Bridge_Program\WJXN4000_91717078_CR412700_CADD\SH\TRD\WYCR412_AWS.dgn

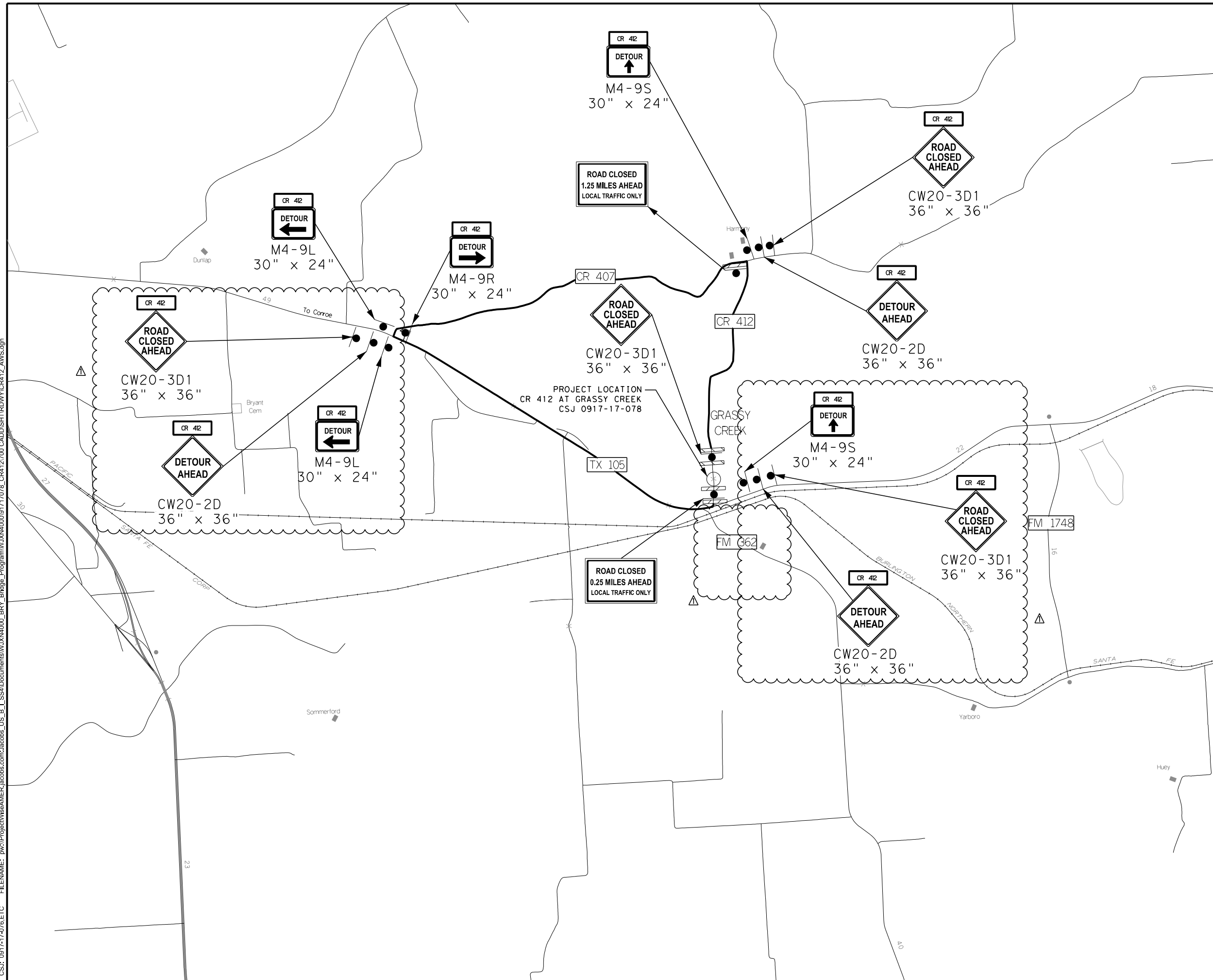

- NOTES:
1. PLACE SIGNS IN ACCORDANCE WITH TXDOT STANDARDS BC(1)-BC(12)-21, WZ(RCD) AND TEXAS MANUAL ON UNIFORM TRAFFIC CONTROL DEVICES.
 2. ADJUST SIGNING AS NECESSARY TO FIT FIELD CONDITIONS OR AS DIRECTED.
 3. SEE TRAFFIC CONTROL PLAN FOR PLACEMENT OF ADDITIONAL SIGNS.

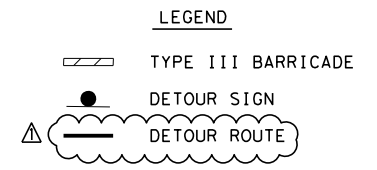

Drawings Not To Scale

NO.	DATE	REVISION	BY
6	7/18/2023	REVISED DETOUR SIGNS	JIA

Jacobs 2705 BEE CAVE RD, SUITE 300
 AUSTIN TX 78746
 FIRM REGISTRATION F-2966



**ADVANCED WARNING SIGNS
 CR 412**

FED. RD. DIV. NO.	PROJECT NUMBER	HIGHWAY NUMBER	
6	BR 2023(064).ETC.	CR	
STATE	DISTRICT	COUNTY	
TEXAS	BRY	GRIMES	
CONTROL	SECTION	JOB	SHEET NO.
0917	17	076.ETC	19