

SUBJECT: PLANS AND PROPOSAL ADDENDUMS

PROJECT: STP 2023 (698) HES

CONTROL: 0402-03-042

COUNTY: HARRISON

LETTING: 05/05/2023

REFERENCE NO: 0421

PROPOSAL ADDENDUMS

PROPOSAL COVER

BID INSERTS (SH. NO.:

GENERAL NOTES (SH. NO.:

SPEC LIST (SH. NO.:

SPECIAL PROVISIONS:

ADDED:

DELETED:

SPECIAL SPECIFICATIONS:

ADDED:

DELETED:

X OTHER: PLAN SHEETS 2 AND 47

DESCRIPTION OF ABOVE CHANGES

(INCLUDING PLANS SHEET CHANGES)

*****PLAN SHEETS*****

SHEET 2 (INDEX OF SHEETS) REPLACED SHEET 47

SHEET 47 REPLACED STANDARD SHEET

GENERAL

- 1 TITLE SHEET
- 2 INDEX OF SHEETS
- 3 LOCATION MAP
- 4,4A-4C GENERAL NOTES
- 5 ESTIMATE & QUANTITY
- 6-7 PREP ROW SUMMARIES
- 8-14 DRIVEWAY AND SIDE ROAD PIPE SUMMARIES
- 15-21 EROSION CONTROL SUMMARIES

TRAFFIC CONTROL PLAN STANDARDS

- # 22-33 BC (1)-21 THRU BC (12)-21
- # 34 TCP (ATL 10)-14
- # 35 TCP (ATL 11)-14
- # 36 TCP (ATL 12)-14
- # 37 TCP (ATL 21)-14
- # 38 TCP (1-1)-18
- # 39 TCP (1-2)-18
- # 40 TCP (2-1)-18
- # 41 WZ (RS)-22
- 42 TREATMENT FOR VARIOUS EDGE CONDITIONS

ROADWAY DETAILS

- 43-44 ROADWAY DETAILS
- 45 TREE REMOVAL AND TRIMMING DETAILS

DRAINAGE DETAILS STANDARDS

- # 46 SETP-PD
- 1 # 47 PSET-SP
- 48 CONCRETE CURB AND DRIVEWAYS DETAIL

ENVIRONMENTAL ISSUES

- 49 ENVIRONMENTAL PERMITS, ISSUES AND COMMITMENTS EPIC

ENVIRONMENTAL ISSUES STANDARDS

- # 50 EC (1)-16

1 Addendum No 1, 4/21/23

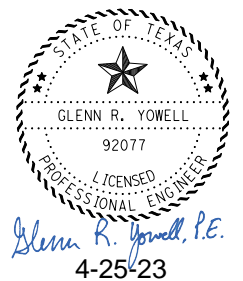

INDEX
OF
SHEETS

CONT	SECT	JOB	HIGHWAY
0402	03, etc.	042, etc.	SH 154
DIST	COUNTY		SHEET NO.
ATL	HARRISON, etc.		2

THE STANDARD SHEETS SPECIFICALLY IDENTIFIED ABOVE BY A '#' HAVE BEEN ISSUED BY ME AND ARE APPLICABLE TO THIS PROJECT.

DATE:
FILE:

DATE: 4/18/2023 11:30:03 AM
 FILE: \\txdot.projectwiseonline.com:txdot15\Documents\19 - ATL\Design\Projects\19-04-STDARDS\pset spss-21.dgn
 PROJECT: 19-04-STDARDS\pset spss-21.dgn
 DRAWING: 19-04-STDARDS\pset spss-21.dgn
 DISCLAIMER: The use of this standard is governed by the "Texas Engineering Practice Act". No warranty of any kind is made by TxDOT for any purpose whatsoever. TxDOT assumes no responsibility for the conversion of units or the accuracy of the information presented herein.

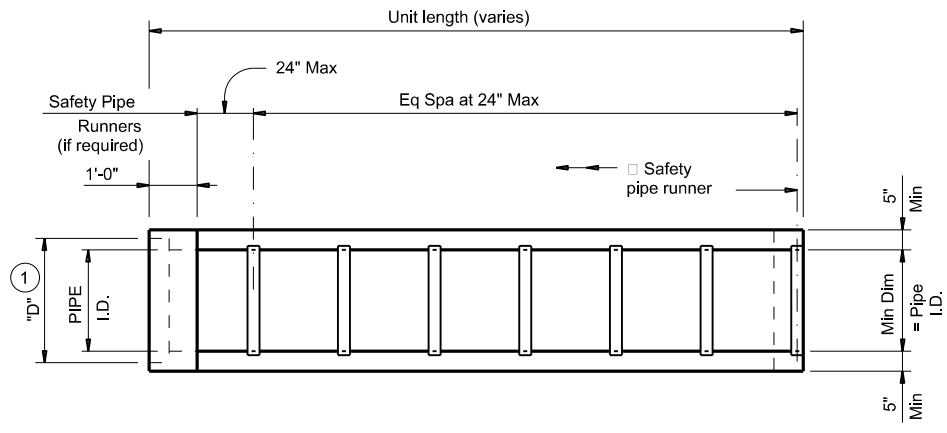

PLAN
(Showing bell end connection.)

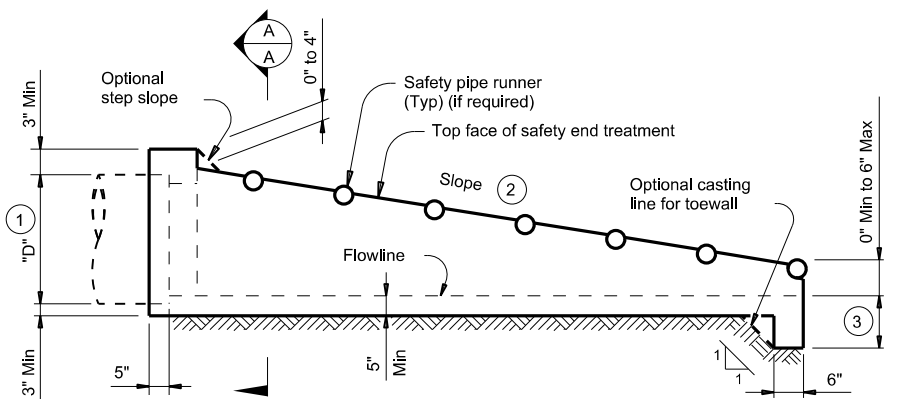

LONGITUDINAL ELEVATION
(Showing bell end connection.)

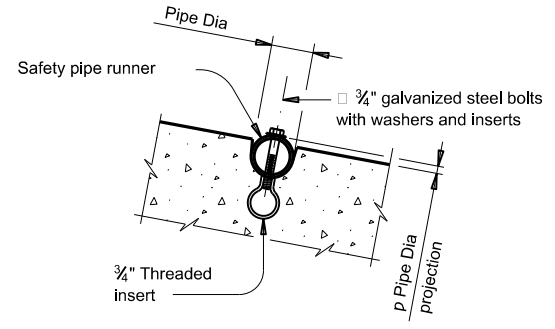

INSTALLATION DETAIL FOR SAFETY PIPE RUNNERS
(If required)

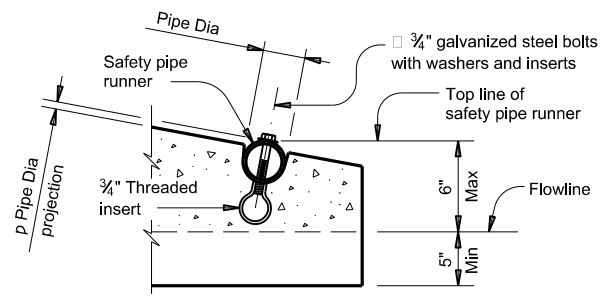

OPTION A

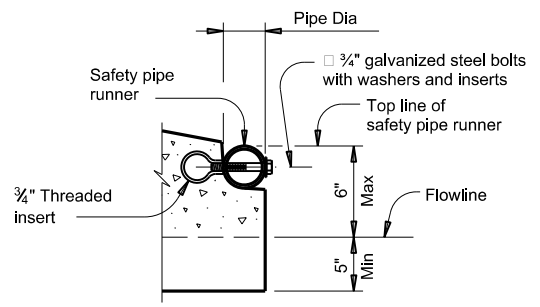

OPTION B

END DETAILS FOR INSTALLATION OF SAFETY PIPE RUNNERS
(If required)

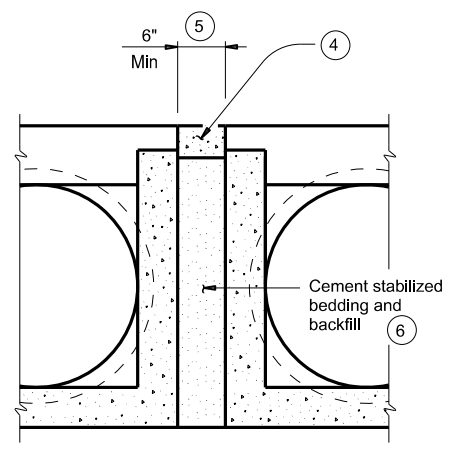

MULTIPLE PIPE INSTALLATION

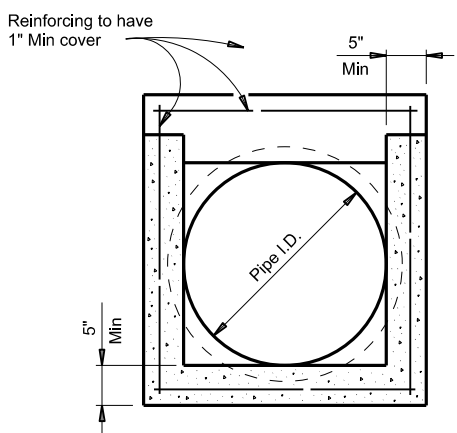

OPTION WITH SQUARE BOTTOM

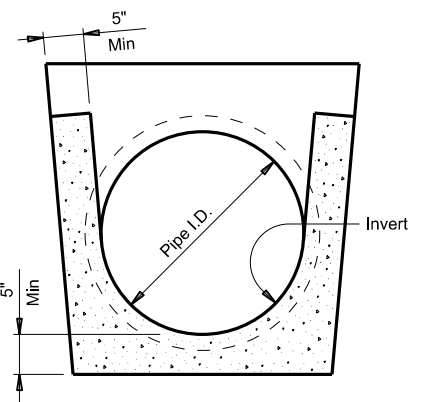

OPTION WITH INVERT BOTTOM

SECTION A-A

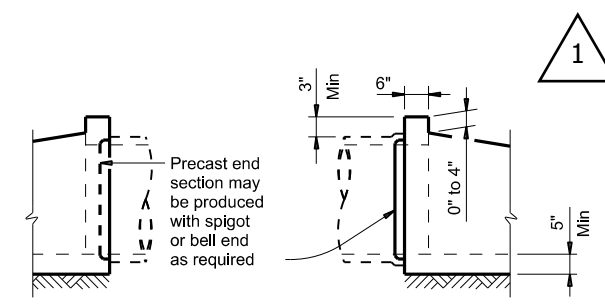

OPTIONAL JOINT FOR RCP

(Showing joint between RCP and precast safety end treatment.)

REQUIREMENTS FOR CULVERT PIPES AND SAFETY PIPE RUNNERS

Pipe I.D.	RCP Wall "B" Thickness	TP Wall Thickness	"D"	Slope	Min Length	Pipe Runners Required		Required Pipe Runner Size		
						Single Pipe	Multiple Pipe	Nominal Dia.	O.D.	I.D.
12"	2"	1.15"	17.00"	6:1	4' - 9"	No	Yes, for > 2 pipes	3" STD	3.500"	3.068"
15"	2 1/4"	1.30"	20.50"	6:1	6' - 5"	No	Yes, for > 2 pipes	3" STD	3.500"	3.068"
18"	2 1/2"	1.60"	24.00"	6:1	8' - 0"	No	Yes, for > 2 pipes	3" STD	3.500"	3.068"
24"	3"	1.95"	31.00"	6:1	11' - 3"	No	Yes, for > 2 pipes	3" STD	3.500"	3.068"
30"	3 1/2"	2.65"	38.50"	6:1	14' - 8"	No	Yes	4" STD	4.500"	4.026"
36"	4"	2.75"	45.50"	6:1	17' - 11"	Yes	Yes	4" STD	4.500"	4.026"
42"	4 1/2"	2.7"	52.50"	6:1	21' - 2"	Yes	Yes	4" STD	4.500"	4.026"

- Dimension "D" is based on reinforced concrete pipe (RCP) meeting the requirements of ASTM C-76, Class III, (RCP Wall "B" thickness). Adjust "D" for any other wall thickness used. For thermoplastic pipe (TP) take into account the annular space requirements for grouted connections.
- Slope as shown elsewhere in the plans. Slope of 6:1 or flatter is required for vehicle safety.
- Toewall to be used only when dimension is shown elsewhere in the plans.
- Fill the top 4" of void between precast end treatments with concrete riprap. Concrete riprap is considered subsidiary to the Item 467, "Safety End Treatment".
- Adjust clear distance between pipes to provide for the minimum distance between safety end treatments.
- Provide cement stabilized bedding and backfill in accordance with the Item 400, "Excavation and Backfill for Structures". Bedding and backfill is considered subsidiary to the Item 467, "Safety End Treatment". When concrete riprap is specified around the safety end treatment, backfill as directed by Engineer.
- Thermoplastic pipe wall thickness may vary. Adjust accordingly. Thermoplastic pipe requires the safety end treatments to have a bell end for grouted connections.

GENERAL NOTES:

Precast safety end treatment for reinforced concrete pipe (RCP), and thermoplastic pipe (TP) may be used for TYPE II end treatment as specified in Item "Safety End Treatment".

When precast safety end treatment is used as a Contractor's alternate to mitered RCP, riprap will not be required unless noted otherwise on the plans.

Synthetic fibers listed on the "Fibers for Concrete" Material Producer List (MPL) may be used in lieu of steel reinforcing in riprap concrete unless noted otherwise.

Manufacture this product in accordance with Item 467, "Safety End Treatment" except as noted below:

A. Provide minimum reinforcing of #4 at 6" (Grade 40) or #4 at 9" (Grade 60) each way or 6"x6" - D12 x D12 or 5"x5" - D10 x D10 welded wire reinforcement (WWR).

B. For precast (steel formed) sections, provide Class "C" concrete (f_c = 3,600 psi).

At the option and expense of the Contractor the next larger size of safety end treatment may be furnished; as long as the "D" dimension cast is that of the required size of pipe.

Pipe runners are designed for a traversing load of 10,000 Lbs at yield as recommended by Research Report 280-2F, "Safety Treatment of Roadside Parallel-Drainage Structures", Texas Transportation Institute, March 1981.

Provide pipe runners meeting the requirements of ASTM A53 (Type E or S, Grade B), ASTM A500 (Grade B), or API 5LX52.

Galvanize all steel components except reinforcing steel after fabrication. Repair galvanizing damaged during transport or construction in accordance with the specifications.

Connect RCP using the Optional Joint for RCP detail shown or in accordance with Item 464, "Reinforced Concrete Pipe". Connect TP by grouting. See Pipe and Box Grouted Connections (PBGC) standard for grouted connections with TP and precast safety end treatment.

NEW STANDARD SHEET
4/21/2023

				Bridge Division Standard	
PRECAST SAFETY END TREATMENT TYPE II ~ PARALLEL DRAINAGE					
PSET-SP					
FILE: psetspss-21.dgn	DN: RLW	CK: KLR	DW: JTR	CK: GAF	
©TxDOT February 2020	CONT	SECT	JOB	HIGHWAY	
REVISIONS	0402	03	042	SH 154	
12-21: Added 42" TP	DIST	COUNTY	SHEET NO.		
	ATL	HARRISON			47