

SUBJECT: PLANS AND PROPOSAL ADDENDUMS

PROJECT: C 1226-2-16

CONTROL: 1226-02-016

COUNTY: TITUS

LETTING: 01/05/2023

REFERENCE NO: 0104

PROPOSAL ADDENDUMS

PROPOSAL COVER

X BID INSERTS (SH. NO.: 2-11, 3-11, 10-11)

X GENERAL NOTES (SH. NO.: SHEETS C,D AND E)

X SPEC LIST (SH. NO.: .)

X SPECIAL PROVISIONS:

ADDED: 000--1314

DELETED: 000--1314

SPECIAL SPECIFICATIONS:

ADDED:

DELETED:

X OTHER: PLAN SHEETS: 007-010, 012A, 012B, 013, 013B, 013C, 015, 016,
114-117

DESCRIPTION OF ABOVE CHANGES
(INCLUDING PLANS SHEET CHANGES)

****BID INSERTS****

REVISED QUANTITIES FOR BID ITEMS 316-6017, 316-6224, 3077-6065,
and 3077-6075.

****GENERAL NOTES****

REVISED GENERAL NOTES FOR ITEMS 105, 160 & 164.

****SPECIAL PROVISIONS****

000--1314 ADDED BOWIE CASS TO UNCLEAR UTILITIES LIST.

****PLAN SHEETS****

SHEETS 007-010 - REVISED PROPOSED TYPICAL SECTIONS, DETAIL
A-A AND LEGEND.

SHEETS 12A & 12B SEE GENERAL NOTE CHANGES ABOVE.

DESCRIPTION OF ABOVE CHANGES
(INCLUDING PLANS SHEET CHANGES)

(CONTINUED)

SHEETS 13 & 13B & 13C SEE BID INSERT CHANGES ABOVE.

SHEET 15 ADDED NOTE TO SUMMARY OF REMOVAL ITEMS.

SHEET 16 REVISED SUMMARY OF ROADWAY ITEMS.

SHEET 114-117 REVISED PLAN VIEW SURFACE CALL OUT NOTE.

DATE: 1/4/2023 TIME: 10:26:27 AM

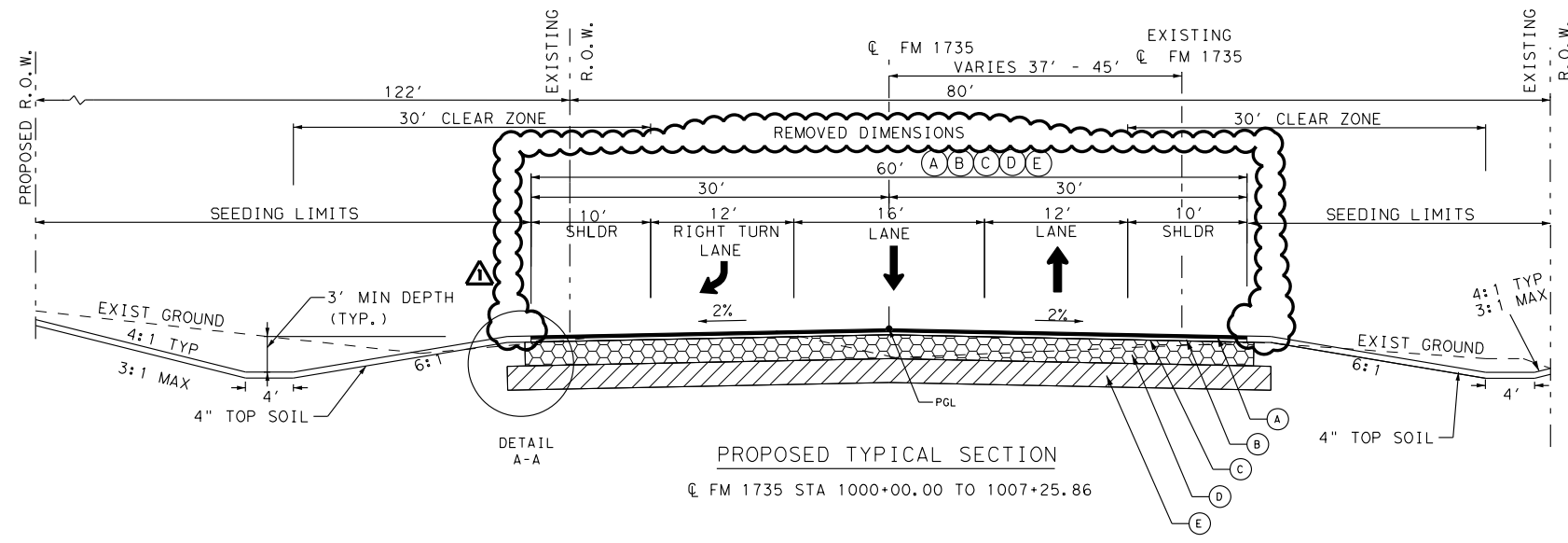

PROPOSED TYPICAL SECTION
 ☉ FM 1735 STA 1000+00.00 TO 1007+25.86

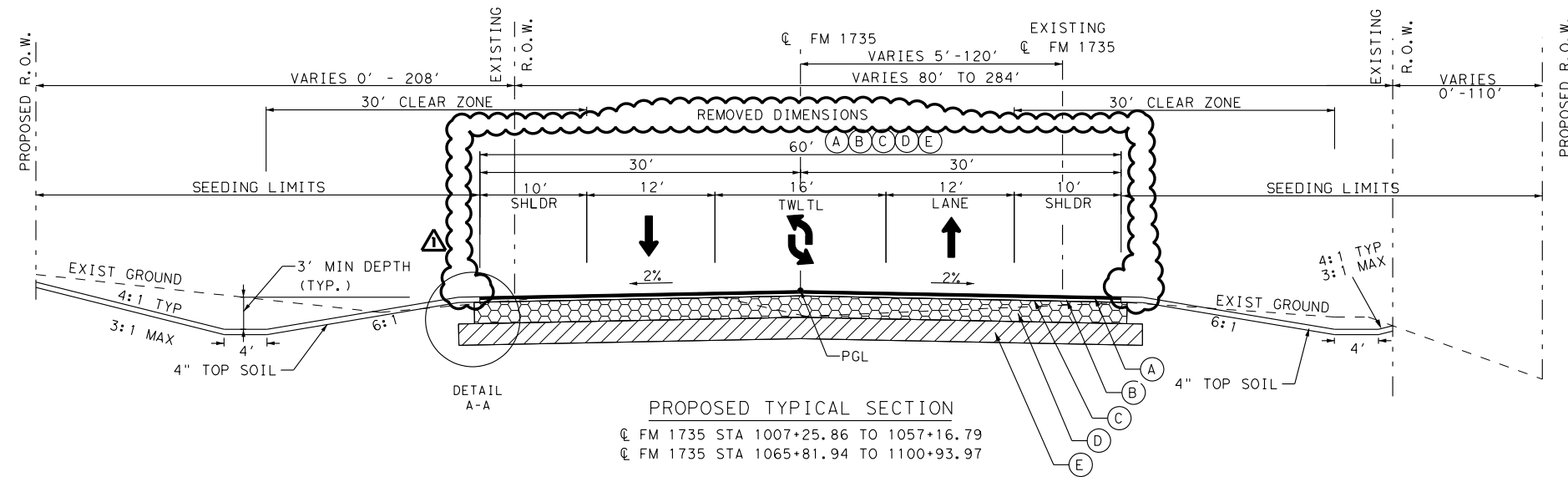

PROPOSED TYPICAL SECTION
 ☉ FM 1735 STA 1007+25.86 TO 1057+16.79
 ☉ FM 1735 STA 1065+81.94 TO 1100+93.97

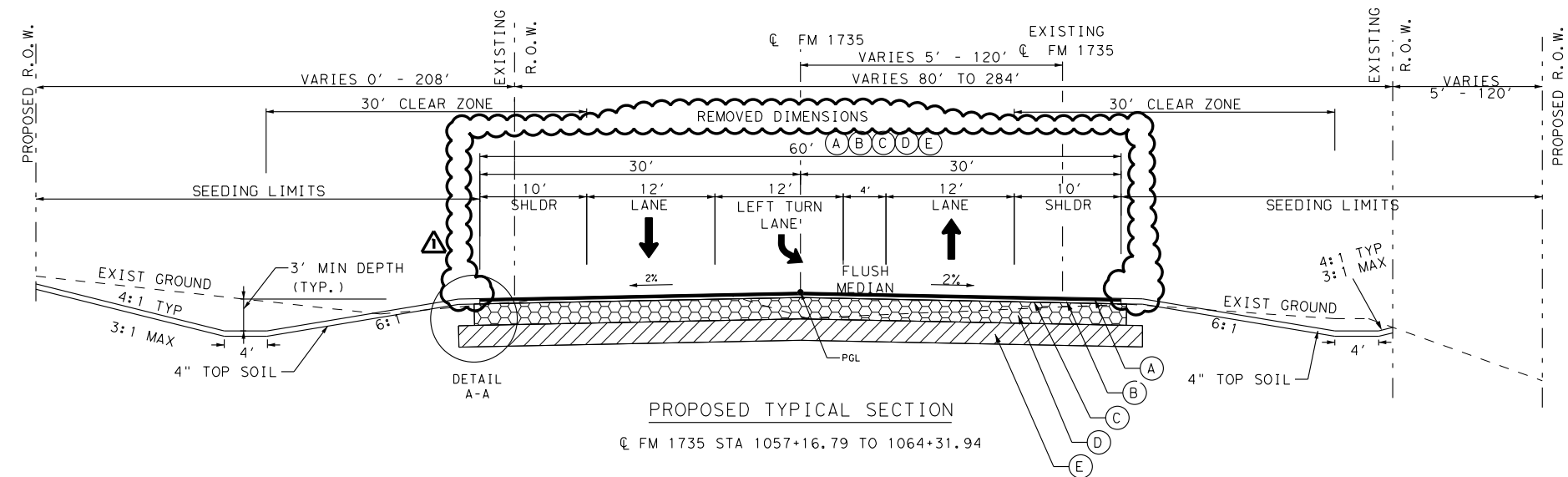

PROPOSED TYPICAL SECTION
 ☉ FM 1735 STA 1057+16.79 TO 1064+31.94

LEGEND

- (A) ITEM 3077: 2" SP MIXES SP-D SAC-A PG 76-22
- (B) ITEM 316: OCST TY B GR 3 & TY PB GR 4 INCLUDED GR 4
- (C) ITEM 310: PRIME COAT MC-30
- (D) ITEM 247: 8" CEMENT TREATED BASE (DC) TY D GR 1-2
- (E) ITEM 275: 10" CEMENT TREATED SUBGRADE

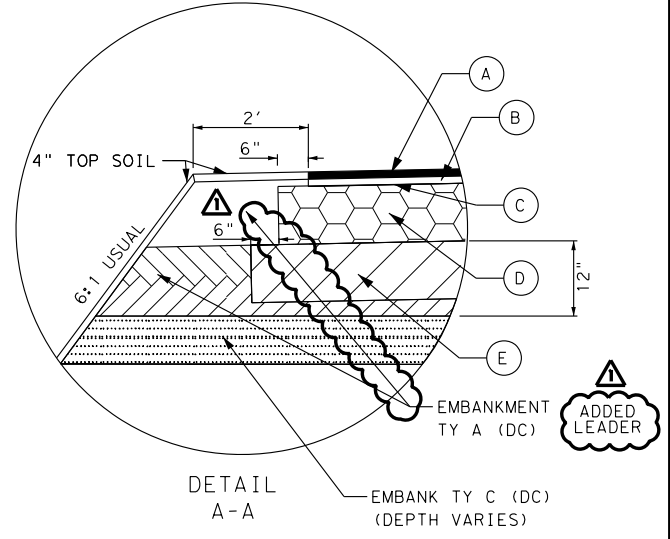

1/4/2023
DATE

DAVID M. JAMES, P.E.

REV. No.	DATE	REVISION	BY
1	1/4/23	ADDENDUM #1	DMJ

ATKINS
MEMBER OF THE SNC-LAVALIN GROUP
TBP REG. # F-474



FM 1735 & SH 49
TYPICAL SECTIONS

NOT TO SCALE SHEET 4 OF 8

FED. RD DIV. No.	STATE	PROJECT No.	HIGHWAY No.		
19	TEXAS		FM 1735		
STATE DISTRICT	COUNTY	CONTROL No.	SECTION No.	JOB No.	SHEET No.
ATL	TITUS	1226	02	016	7

PLOT DRIVER: RD_11x17_PDF.plt
 PEN TABLE: FM1735--transportation.tbl
 FILE: FM1735_04_TYPICALS.dgn

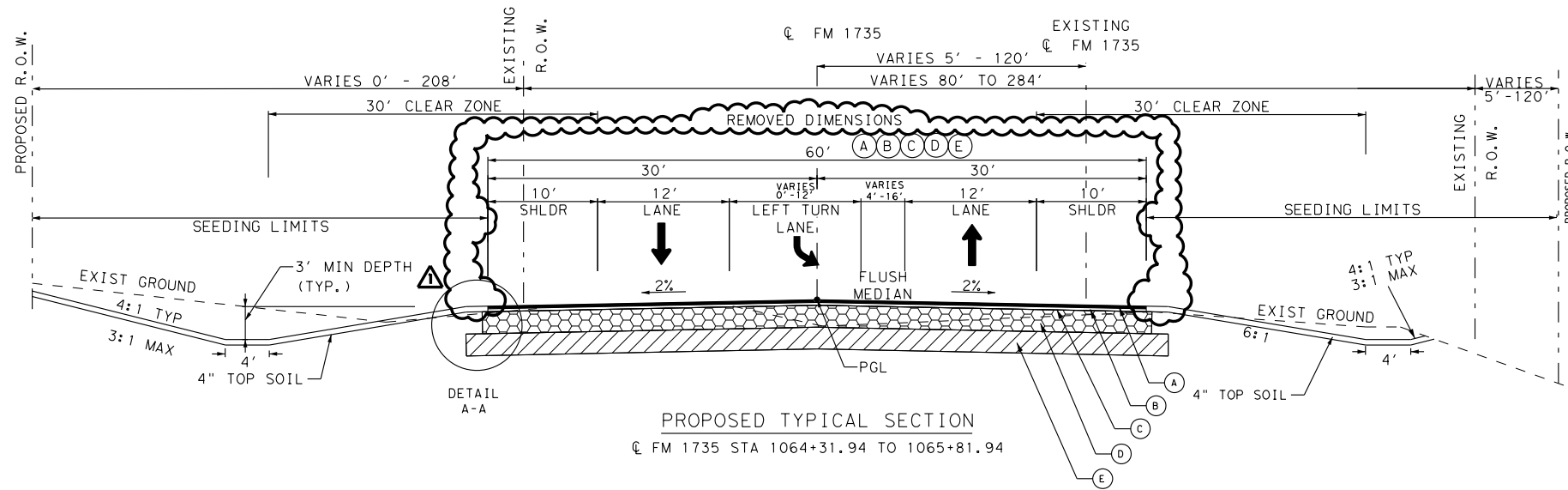

PROPOSED TYPICAL SECTION
 ☉ FM 1735 STA 1064+31.94 TO 1065+81.94

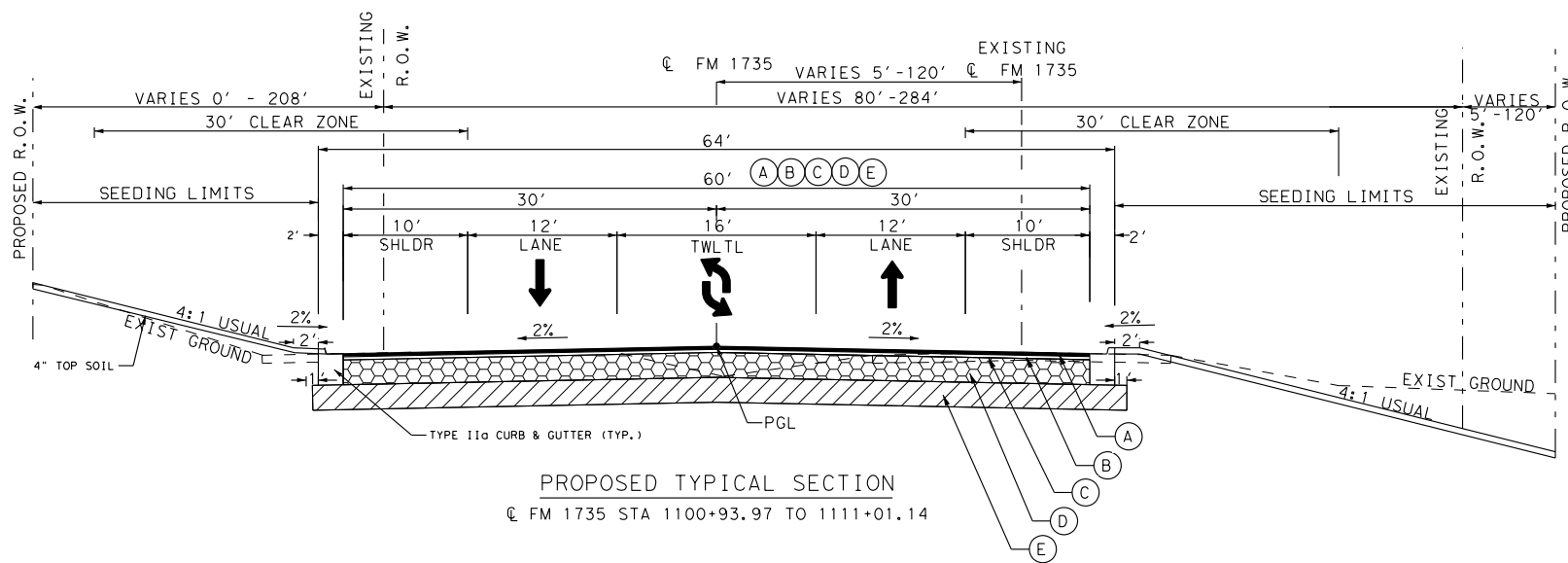

PROPOSED TYPICAL SECTION
 ☉ FM 1735 STA 1100+93.97 TO 1111+01.14

LEGEND

- (A) ITEM 3077: 2" SP MIXES SP-D SAC-A PG 76-22
- (B) ITEM 316: OCST TY B GR 3 & TY PB GR 4 INCLUDED GR 4
- (C) ITEM 310: PRIME COAT MC-30
- (D) ITEM 247: 8" CEMENT TREATED BASE (DC) TY D GR 1-2
- (E) ITEM 275: 10" CEMENT TREATED SUBGRADE

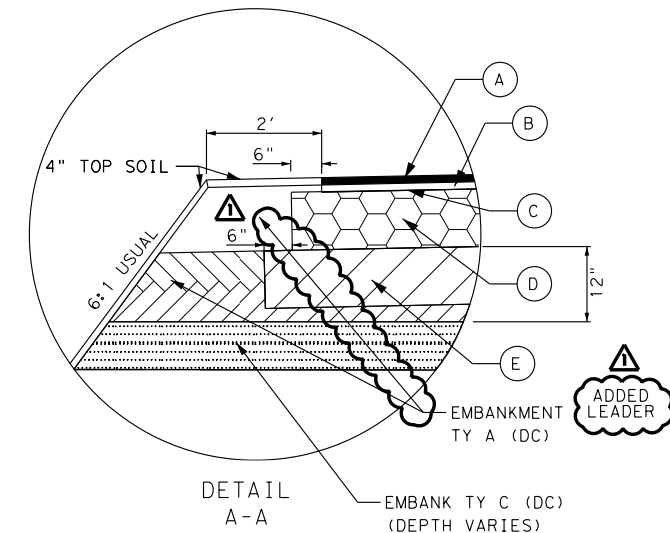

DETAIL A-A

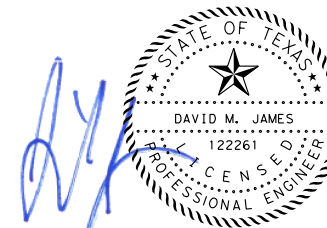

DAVID M. JAMES, P.E. 1/4/2023 DATE

REV. No.	DATE	REVISION	BY
1	1/4/23	ADDENDUM #1	DMJ



FM 1735 & SH 49
 TYPICAL SECTIONS

NOT TO SCALE SHEET 5 OF 8

FED. RD DIV. No.	STATE	PROJECT No.	HIGHWAY No.		
19	TEXAS		FM 1735		
STATE DISTRICT	COUNTY	CONTROL No.	SECTION No.	JOB No.	SHEET No.
ATL	TITUS	1226	02	016	8

DATE: 1/4/2023 TIME: 10:28:03 AM

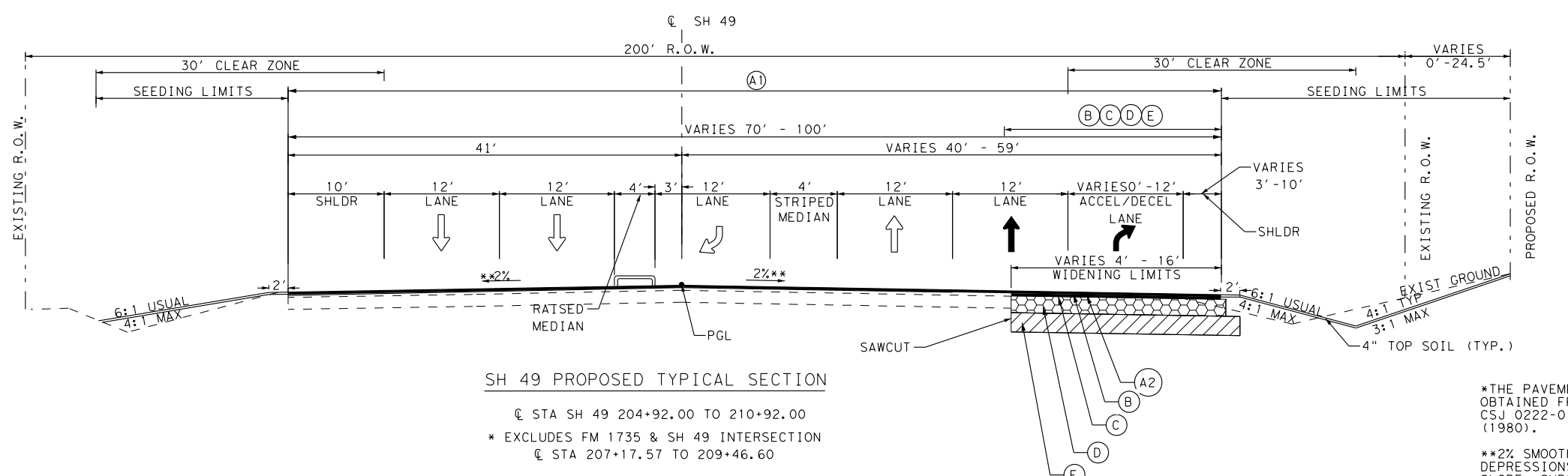
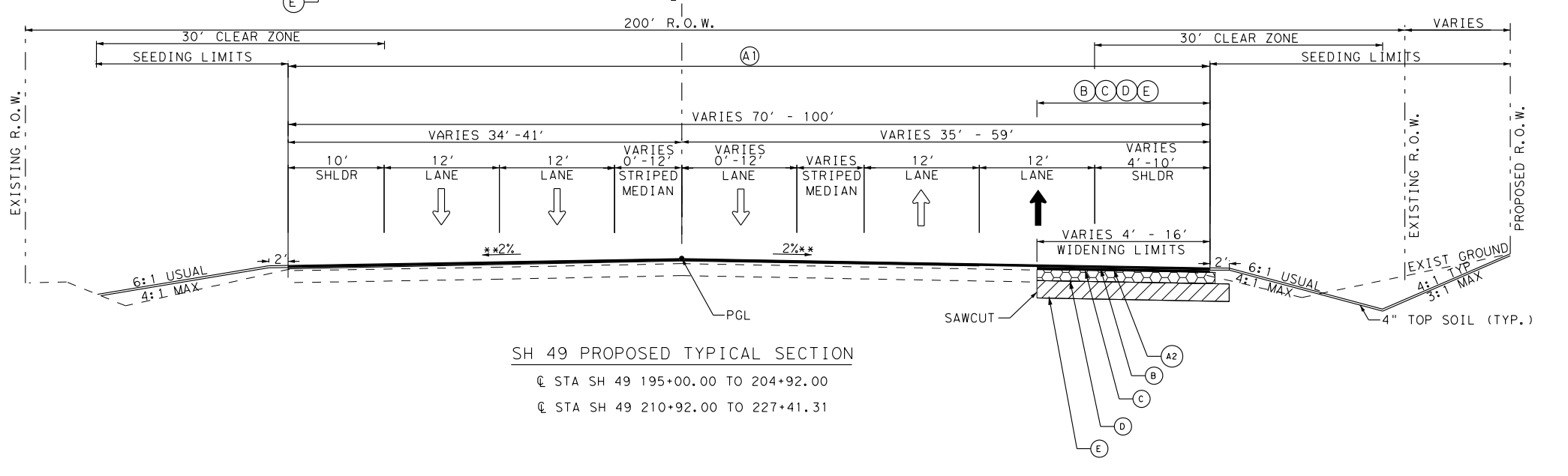
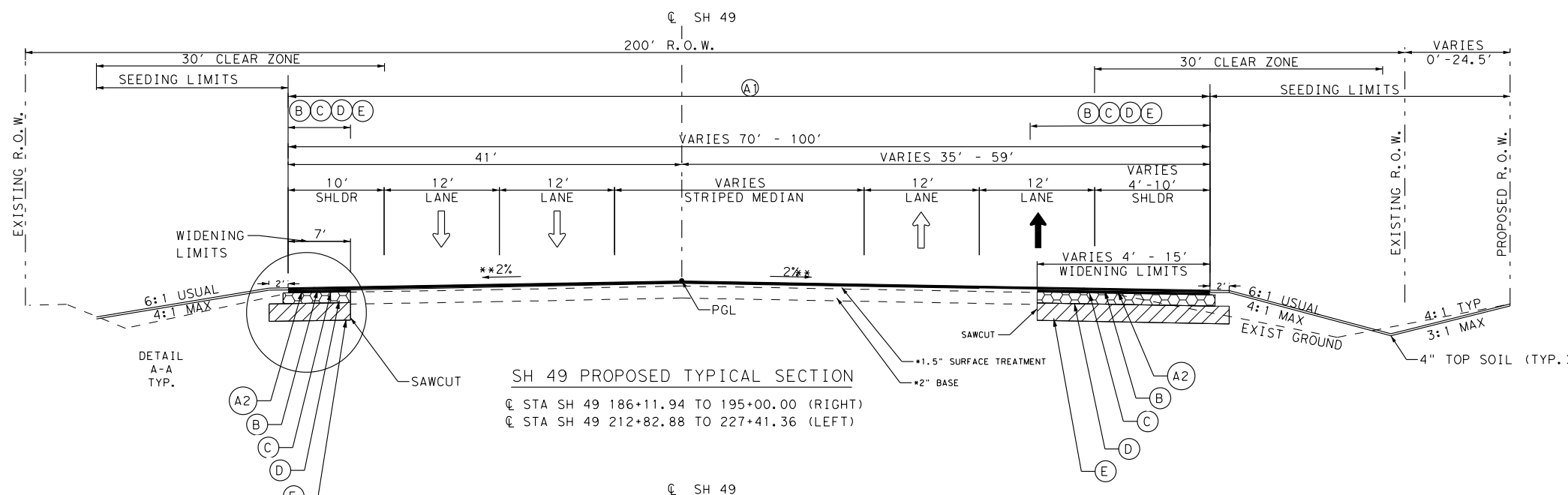

- LEGEND
- (A1) ITEM 316: OCST TY PB GR 4
 - (A2) 2" PROPOSED ACP TO MATCH EXISTING ROADWAY
 - (B) ITEM 316: OCST TY B GR 3
 - (C) ITEM 310: PRIME COAT MC-30
 - (D) ITEM 247: 8" CEMENT TREATED BASE (DC) TY D GR 1-2
 - (E) ITEM 275: 10" CEMENT TREATED SUBGRADE

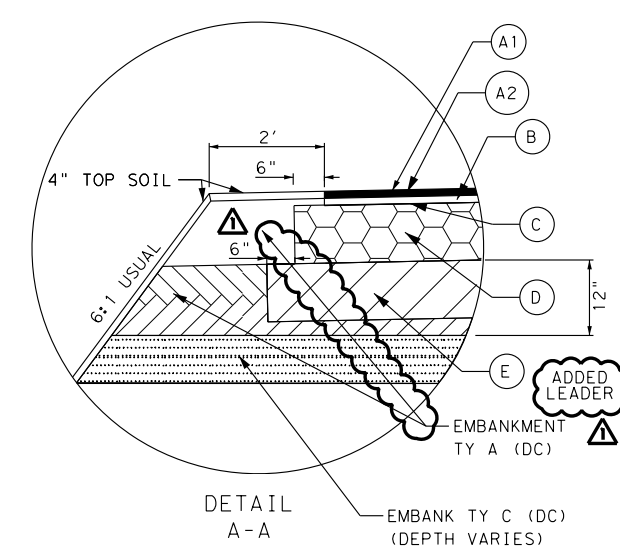

STATE OF TEXAS
 DAVID M. JAMES
 122261
 PROFESSIONAL ENGINEER

1/4/2023
 DATE

DAVID M. JAMES, P.E.

REV. No.	DATE	REVISION	BY
1	1/4/23	ADDENDUM #1	DMJ

ATKINS
 MEMBER OF THE SNC-LAVALIN GROUP
 TBPE REG. # F-474

Texas Department of Transportation
 ©2022

FM 1735 & SH 49
 TYPICAL SECTIONS

NOT TO SCALE SHEET 6 OF 8

FED. RD DIV. No.	STATE	PROJECT No.	HIGHWAY No.		
19	TEXAS		FM 1735		
STATE DISTRICT	COUNTY	CONTROL No.	SECTION No.	JOB No.	SHEET No.
ATL	TITUS	1226	02	016	9

*THE PAVEMENT STRUCTURE OBTAINED FROM THE AS-BUILT CSJ 0222-01-032 SH 49 (1980).
 **2% SMOOTH SURFACE. FILL EXISTING DEPRESSIONS TO ACHIEVE CONTINUOUS SLOPE. SUBSIDIARY TO ACP OVERLAY (A1).

PLOT DRIVER: RD_11x17_PDF.plt
 PEN TABLE: FM1735_--transportation.tbl
 FILE: FM1735_04_TYPICALS.dgn

DATE: 1/4/2023 TIME: 10:28:30 AM

LEGEND

- (A) ITEM 3077: 2" SP MIXES SP-D SAC-A PG 76-22
- (B) ITEM 316: OCST TY B GR 3
- (C) ITEM 310: PRIME COAT MC-30
- (D) ITEM 247: 8" CEMENT TREATED BASE (DC) TY D GR 1-2
- (E) ITEM 275: 10" CEMENT TREATED SUBGRADE

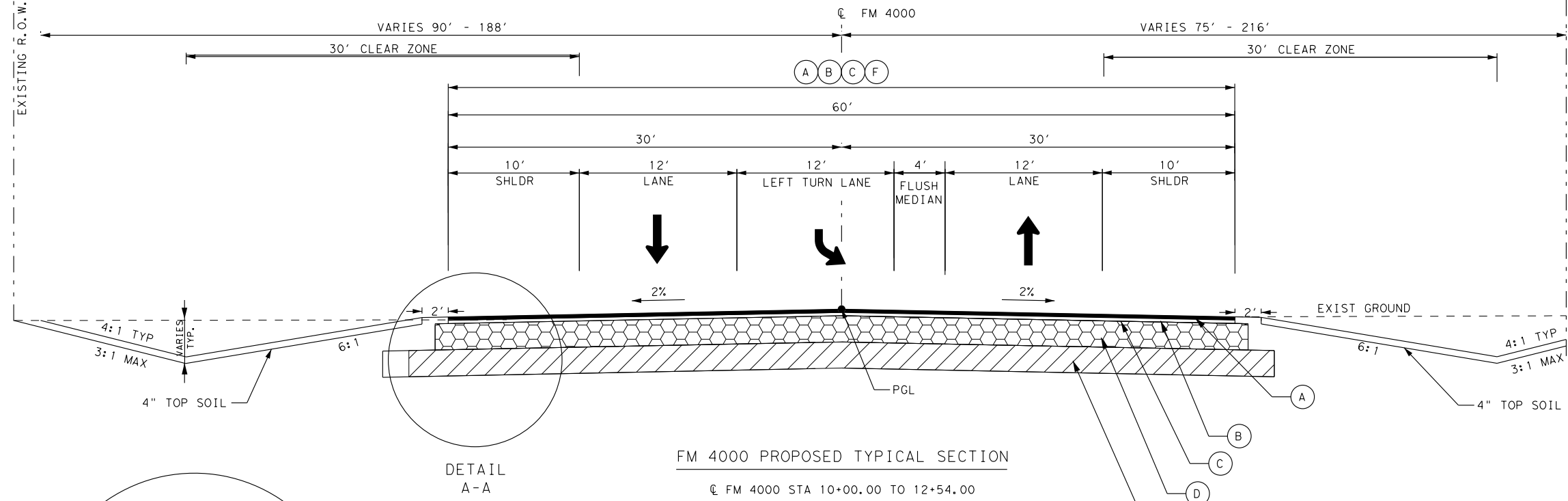

DETAIL A-A

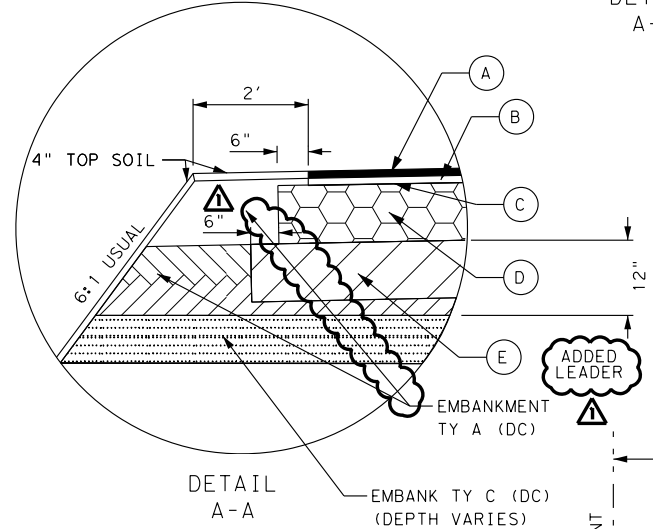

PROPOSED CONSTRUCTION EASEMENT

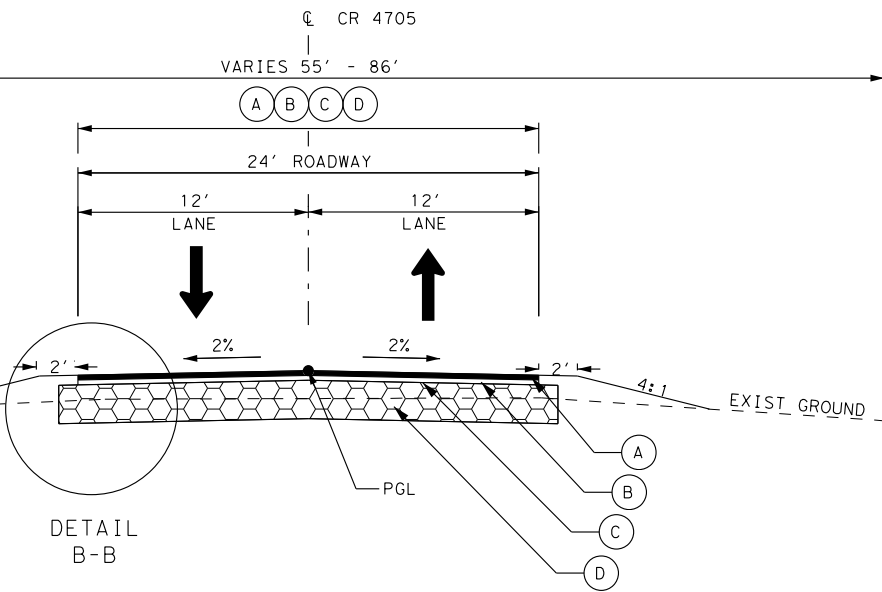

DETAIL B-B

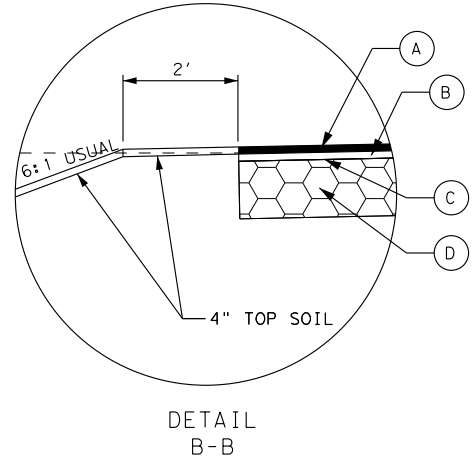

PROPOSED CONSTRUCTION EASEMENT

STATE OF TEXAS
 DAVID M. JAMES
 122261
 PROFESSIONAL ENGINEER
 1/4/2023
 DAVID M. JAMES, P.E. DATE

REV. No.	DATE	REVISION	BY
1	1/4/23	ADDENDUM #1	DMJ

ATKINS
 MEMBER OF THE SNC-LAVALIN GROUP
 TBPE REG. # F-474

Texas Department of Transportation
 ©2022

FM 1735 & SH 49
 TYPICAL SECTIONS

NOT TO SCALE SHEET 7 OF 8

FED. RD DIV. No.	STATE	PROJECT No.	HIGHWAY No.		
19	TEXAS		FM 1735		
STATE DISTRICT	COUNTY	CONTROL No.	SECTION No.	JOB No.	SHEET No.
ATL	TITUS	1226	02	016	10

PLOT DRIVER: RD_11x17_PDF.plt
 PEN TABLE: FM1735_--Transportation.tbl
 FILE: FM1735_04_TYPICALS.dgn

ITEM 105 – Removing Treated and Untreated Base and Asphalt Pavement:

Dispose of material in accordance with all applicable State and Local laws and regulations.



ITEM 110 - Excavation:

Compact subgrade in earth cut sections, in accordance with section 132.3.4.2 **Density Control**

As cut slopes are constructed, round off the tops of back slopes to blend into the natural ground.

Excavation of existing stabilized materials will be measured and paid for as excavation (roadway).

Remove abandoned underground utility lines encountered. This work will be subsidiary to the pertinent bid items.

Flare ditches to prevent erosion of the toe of slope in areas of transition from cut to fill.

Excavated materials not meeting the requirements for Type A or Type C embankment will be considered waste. Dispose of as directed.

ITEM 132 – Embankment:

Furnish material with an organic content less than 1.0%. The Engineer will test using UV-VIS equipment and procedure determined by TxDOT. Allow two weeks for testing.

Compact subgrade in earth cut sections, in accordance with section 132.3. 4.2 **Density Control.**

Test borrow sources and furnish results to the Engineer.

Where fill height is 5 feet or more above natural ground, the specified density will not be required on the first 2 feet of embankment, unless otherwise directed.

Remove deleterious material, organic matter, and sediment, etc., from all ponds, lakes, sloughs, channels, and existing roadway ditches prior to placement of embankment. This work will be subsidiary to this item.

Ensure that the final 12 inches of embankment to be treated has a minimum PI of 4 and a maximum PI of 15.

This item will be used to cover foundations from ground level to the three-inch minimum level below the top of foundations.



Drill or dig one or more holes for thickness measurement, refill, and re-compact material at the location and frequency as directed. This work is considered subsidiary to this item.

Beginning with the final lift of embankment, measure the cross slope during pavement structure operations, at the completion of each land, and prior to covering with another course or lift to ensure that the cross slope is uniform and in compliance with the cross slope shown in the plans. Measure the cross slope at a minimum frequency of one measurement every 100 feet. The number of measurements may be reduced by demonstrating consistently acceptable results, with the approval of the Engineer. Furnish a digital measuring device approved by the Engineer for the measurement of cross slope. Make this measuring device available at the jobsite for the Engineer's use. Report the cross slope to the nearest 0.1%. Record all measurements on an approved form signed and dated certifying correct and submit to the Engineer the next working day for documentation. The Engineer will determine the number of verification measurements.

ITEM 160 – Topsoil:

Finish slopes with a tracked vehicle running vertically up and down the slope.



ITEM 164 – Seeding for Erosion Control:

PERMANENT PLANTING MIXTURE
Species and Rates
(lb. PLS/ac.)

(Season: February 1 to May 15)	
Green Sprangletop	0.4
Bermudagrass	2.4
Sand Lovegrass	1.0
Lance-Leaf Coreopsis	1.25

(Season: September 1 to November 30)	
Bermuda (Unhulled)	12
Crimson Clover	10

TEMPORARY SEEDING FOR EROSION CONTROL

Warm Season
(Season: May 15 to August 31)



Bermudagrass	6
Foxtail Millet	34
Cool Season (Season: September 1 to November 30)	
Tall Fescue	4.5
Oats	24
Wheat	34

Adjust the seeding mixture and rates if directed.

Inoculate crimson clover seed with a legume inoculant. Sow inoculated seed dry, with either hand operated or mechanical equipment, after the fertilizer is placed.

Do not use Bahia grass.

Use crimper immediately after spreading mulch. Apply ballast to machine to achieve an anchoring depth of 2 to 3 inches to form soil-binding mulch and to prevent loss or bunching of the mulch by wind. Anchor the machine to prevent the formation of ridges and ruts. Use coulters at least ten inches in diameter. Traverse slopes horizontally. The number of passes needed, not to exceed three, will be as directed. In areas where an anchoring machine cannot be used, the Department will require a tacking agent be used in the mulch as directed.

Use broadcast seeding for temporary erosion control, when and as directed. This will not be paid for directly but is subsidiary to the various bid items.

Use additional temporary seeding if permanent seeding is placed outside the optimum growing season shown for this item, if directed.

Finish slopes with a tracked vehicle running vertically up and down the slope.

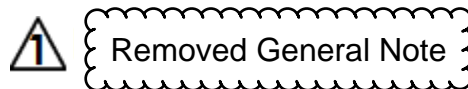

Mow tall growing vegetation as directed, to provide optimum growing conditions for temporary or permanent seeded areas in accordance with Item 730 "Roadside Mowing" except for measurement and payment. This work will be subsidiary to pertinent bid items.

Repair mulch sod, damaged by causes other than the Contractor's operations, as directed using mulch sod, seeding, and fertilizer. This work will be measured and paid for in accordance with the applicable bid items of the contract.

 REVISED 1/04 /2023

ITEM 166 - Fertilizer:

When seeding between September 1 and January 1, place one-half of the amount of fertilizer specified for seeding with the seeds and place the remainder the following spring unless otherwise directed. When seeding is placed between January 1 and June 1, place one-half the amount of fertilizer specified for seeding with the seeds and place the remainder 30 days later unless otherwise directed.

Apply fertilizer (13-13-13) at a rate of 300 lbs. /5000 sq. yds.

ITEM 247 – Flexible Base:

Drill or dig one or more holes for thickness measurement, refill, and re-compact material at the location and frequency as directed. This work is considered subsidiary to this item.

Furnish material with an organic content less than 1.0%. The Engineer will test using UV-VIS equipment and procedure determined by TxDOT. Allow two weeks for testing.

The Engineer will test each stockpile. A minimum of 14 days will be required for testing after stockpile has been sampled.

Target grading required.

Correct 0.1-mi. sections having an average international roughness index (IRI) value greater than 125.0 in. per mile to an IRI value of 125.0 in. per mile or less for each wheel path.

Beginning with the final lift of embankment, measure the cross slope during pavement structure operations, at the completion of each land, and prior to covering with another course or lift to ensure that the cross slope is uniform and in compliance with the cross slope shown in the plans. Measure the cross slope at a minimum frequency of one measurement every 100 feet. The number of measurements may be reduced by demonstrating consistently acceptable results, with the approval of the Engineer. Furnish a digital measuring device approved by the Engineer for the measurement of cross slope. Make this measuring device available at the jobsite for the Engineer's use. Report the cross slope to the nearest 0.1%. Record all measurements on an approved form signed and dated certifying correct and submit to the Engineer the next working day for documentation. The Engineer will determine the number of verification measurements.

Moist cure the layer by sprinkling in accordance with ITEM 204, "Sprinkling" until primed or the next successive course is placed. The Engineer will measure the moisture content in the upper two inches of the layer using Tex-115E Part I, Nuclear Gauge Method. When the moisture content at any location within a land is more than 2 percent points below optimum the Contractor will prime or cover with the next successive course within three days unless approved otherwise.



Estimate & Quantity Sheet

CONTROLLING PROJECT ID 1226-02-016

DISTRICT Atlanta
HIGHWAY FM 1735

COUNTY Titus

CONTROL SECTION JOB				1226-02-016		TOTAL EST.	TOTAL FINAL
PROJECT ID				A00049203			
COUNTY				Titus			
HIGHWAY				FM 1735			
ALT	BID CODE	DESCRIPTION	UNIT	EST.	FINAL		
	100-6002	PREPARING ROW	STA	177.000		177.000	
	104-6009	REMOVING CONC (RIPRAP)	SY	202.000		202.000	
	104-6017	REMOVING CONC (DRIVEWAYS)	SY	610.000		610.000	
	104-6022	REMOVING CONC (CURB AND GUTTER)	LF	803.000		803.000	
	105-6021	REMOVING STAB BASE AND ASPH PAV (0-4")	SY	1,651.000		1,651.000	
	105-6023	REMOVING STAB BASE AND ASPH PAV (5")	SY	52,277.000		52,277.000	
	110-6001	EXCAVATION (ROADWAY)	CY	120,259.000		120,259.000	
	110-6002	EXCAVATION (CHANNEL)	CY	247.000		247.000	
	132-6002	EMBANKMENT (FINAL)(DENS CONT)(TY A)	CY	22,945.000		22,945.000	
	132-6006	EMBANKMENT (FINAL)(DENS CONT)(TY C)	CY	48,835.000		48,835.000	
	160-6003	FURNISHING AND PLACING TOPSOIL (4")	SY	195,177.000		195,177.000	
	164-6009	BROADCAST SEED (TEMP) (WARM)	SY	97,588.000		97,588.000	
	164-6011	BROADCAST SEED (TEMP) (COOL)	SY	97,588.000		97,588.000	
	164-6054	BOND FBR MTRX SEED (PERM)(RURAL)(SAND)	SY	195,177.000		195,177.000	
	168-6001	VEGETATIVE WATERING	MG	6,246.000		6,246.000	
	169-6005	SOIL RETENTION BLANKETS (CL 2) (TY E)	SY	300.000		300.000	
	247-6312	FL BS (CMP IN PLC)(TY D GR1-2)(8")	SY	84,745.000		84,745.000	
	275-6001	CEMENT	TON	2,494.000		2,494.000	
	275-6009	CEMENT TREAT (NEW BASE) (8")	SY	84,745.000		84,745.000	
	275-6063	CEMENT TREAT (SUBGRADE)(10")	SY	84,319.000		84,319.000	
	310-6021	PRIME COAT & BLOTTER (MC-30)	GAL	29,649.000		29,649.000	
	316-6017	ASPH (AC-20-5TR)	GAL	96,112.000		96,112.000	
	316-6173	AGGR(TY-B GR-3 SAC-B)	CY	760.000		760.000	
	316-6224	AGGR(TY-PB GR-4 SAC-B)	CY	765.000		765.000	
	354-6021	PLANE ASPH CONC PAV(0" TO 2")	SY	2,213.000		2,213.000	
	400-6005	CEM STABIL BKFL	CY	1,209.000		1,209.000	
	400-6006	CUT & RESTORING PAV	SY	202.000		202.000	
	400-6009	CEMENT STAB BACKFILL (INLET OR MH)	CY	116.000		116.000	
	402-6001	TRENCH EXCAVATION PROTECTION	LF	770.000		770.000	
	416-6029	DRILL SHAFT (RDWY ILL POLE) (30 IN)	LF	230.000		230.000	
	432-6001	RIPRAP (CONC)(4 IN)	CY	430.000		430.000	
	432-6006	RIPRAP (CONC)(CL B)	CY	8.000		8.000	
	432-6031	RIPRAP (STONE PROTECTION)(12 IN)	CY	155.000		155.000	
	462-6018	CONC BOX CULV (7 FT X 7 FT)	LF	474.000		474.000	
	464-6012	RC PIPE (CL III)(60 IN)	LF	7.000		7.000	
	464-6017	RC PIPE (CL IV)(18 IN)	LF	763.000		763.000	
	465-6006	JCTBOX(COMPL)(PJB)(4FTX4FT)	EA	2.000		2.000	

⚠ Revised Quantity
⚠ Revised Quantity

⚠ REVISED 1/04 /2023



DISTRICT	COUNTY	CCSJ	SHEET
Atlanta	Titus	1226-02-016	13



Estimate & Quantity Sheet

CONTROLLING PROJECT ID 1226-02-016

DISTRICT Atlanta
HIGHWAY FM 1735

COUNTY Titus

CONTROL SECTION JOB				1226-02-016		TOTAL EST.	TOTAL FINAL
PROJECT ID				A00049203			
COUNTY				Titus			
HIGHWAY				FM 1735			
ALT	BID CODE	DESCRIPTION	UNIT	EST.	FINAL		
	560-6025	RELOCATE EXISTING MAILBOX	EA	27.000		27.000	
	610-6304	IN RD IL (TY AL) 50T-10 (400W EQ) LED	EA	23.000		23.000	
	618-6023	CONDT (PVC) (SCH 40) (2")	LF	4,920.000		4,920.000	
	618-6024	CONDT (PVC) (SCH 40) (2") (BORE)	LF	715.000		715.000	
	618-6033	CONDT (PVC) (SCH 40) (4")	LF	15.000		15.000	
	618-6047	CONDT (PVC) (SCH 80) (2") (BORE)	LF	120.000		120.000	
	618-6059	CONDT (PVC) (SCH 80) (4") (BORE)	LF	95.000		95.000	
	620-6008	ELEC CONDR (NO.8) INSULATED	LF	430.000		430.000	
	620-6009	ELEC CONDR (NO.6) BARE	LF	7,930.000		7,930.000	
	620-6010	ELEC CONDR (NO.6) INSULATED	LF	10,345.000		10,345.000	
	624-6002	GROUND BOX TY A (122311)W/APRON	EA	6.000		6.000	
	628-6004	ELC SRV TY A 120/240 060(NS)AL(E)SP(O)	EA	1.000		1.000	
	644-6002	IN SM RD SN SUP&AM TY10BWG(1)SA(P-BM)	EA	4.000		4.000	
	644-6004	IN SM RD SN SUP&AM TY10BWG(1)SA(T)	EA	4.000		4.000	
	644-6007	IN SM RD SN SUP&AM TY10BWG(1)SA(U)	EA	1.000		1.000	
	644-6028	IN SM RD SN SUP&AM TYS80(1)SA(P-BM)	EA	2.000		2.000	
	644-6033	IN SM RD SN SUP&AM TYS80(1)SA(U)	EA	2.000		2.000	
	644-6060	IN SM RD SN SUP&AM TYTWT(1)WS(P)	EA	38.000		38.000	
	644-6076	REMOVE SM RD SN SUP&AM	EA	47.000		47.000	
	658-6060	REMOVE DELIN & OBJECT MARKER ASSMS	EA	15.000		15.000	
	658-6098	INSTL OM ASSM (OM-1)(WFLX)GND	EA	12.000		12.000	
	662-6004	WK ZN PAV MRK NON-REMOV (W)4"(SLD)	LF	40,892.000		40,892.000	
	662-6045	WK ZN PV MK NON-REM (Y)4"(SLD) W/MRKR	LF	37,171.000		37,171.000	
	668-6076	PREFAB PAV MRK TY C (W) (24") (SLD)	LF	271.000		271.000	
	668-6077	PREFAB PAV MRK TY C (W) (ARROW)	EA	45.000		45.000	
	668-6083	PREFAB PAV MRK TY C (W) (LNDP ARROW)	EA	4.000		4.000	
	668-6085	PREFAB PAV MRK TY C (W) (WORD)	EA	17.000		17.000	
	668-6092	PREFAB PAV MRK TY C (W) (36")(YLD TRI)	EA	7.000		7.000	
	668-6108	PREFAB PAV MRK TY C (Y) (24") (SLD)	LF	1,341.000		1,341.000	
	672-6007	REFL PAV MRKR TY I-C	EA	297.000		297.000	
	672-6009	REFL PAV MRKR TY II-A-A	EA	1,534.000		1,534.000	
	672-6010	REFL PAV MRKR TY II-C-R	EA	10.000		10.000	
	677-6001	ELIM EXT PAV MRK & MRKS (4")	LF	52,261.000		52,261.000	
	680-6004	REMOVING TRAFFIC SIGNALS	EA	1.000		1.000	
	684-6031	TRF SIG CBL (TY A)(14 AWG)(5 CONDR)	LF	760.000		760.000	
	690-6009	REMOVAL OF CABLES	LF	1,265.000		1,265.000	
	3077-6065	SP MIXESSP-DSAC-A PG76-22	TON	12,774.000		12,774.000	



Revised Quantity



REVISED 1/04 /2023

DISTRICT	COUNTY	CCSJ	SHEET
Atlanta	Titus	1226-02-016	13B



Estimate & Quantity Sheet

CONTROLLING PROJECT ID 1226-02-016

DISTRICT Atlanta
HIGHWAY FM 1735

COUNTY Titus

CONTROL SECTION JOB				1226-02-016		TOTAL EST.	TOTAL FINAL
PROJECT ID				A00049203			
COUNTY				Titus			
HIGHWAY				FM 1735			
ALT	BID CODE	DESCRIPTION	UNIT	EST.	FINAL		
	3077-6075	TACK COAT	GAL	11,480.000		11,480.000	
	6001-6002	PORTABLE CHANGEABLE MESSAGE SIGN	EA	2.000		2.000	
	6027-6008	GROUND BOX (PREPARE)	EA	2.000		2.000	
	6056-6002	PREFORMED CENTERLINE RUMBLE STRIP	LF	7,361.000		7,361.000	
	6149-6004	REFL PAV MRK AWT (W) 6" (SLD) (100MIL)	LF	37,723.000		37,723.000	
	6149-6005	REFL PAV MRK AWT (W) 6" (BRK) (100MIL)	LF	2,899.000		2,899.000	
	6149-6006	REFL PAV MRK AWT (W) 6" (DOT) (100MIL)	LF	125.000		125.000	
	6149-6010	REFL PAV MRK AWT (Y) 6" (SLD) (100MIL)	LF	45,386.000		45,386.000	
	6149-6011	REFL PAV MRK AWT (Y) 6" (BRK) (100MIL)	LF	4,379.000		4,379.000	
	6149-6025	REFL PAV MARK AWT (W) 8" (SLD) (100 MIL	LF	2,274.000		2,274.000	
	6149-6026	REFL PAV MRK AWT (W) 8" (DOT) (100MIL)	LF	577.000		577.000	
	6185-6002	TMA (STATIONARY)	DAY	276.000		276.000	
	18	EROSION CONTROL MAINTENANCE: CONTRACTOR FORCE ACCOUNT WORK (PART)	LS	1.000		1.000	
		SAFETY CONTINGENCY: CONTRACTOR FORCE ACCOUNT WORK (PARTICIPATING)	LS	1.000		1.000	
1	464-6003	RC PIPE (CL III)(18 IN)	LF	1,114.000		1,114.000	
	464-6005	RC PIPE (CL III)(24 IN)	LF	3,384.000		3,384.000	
1A	464-6005	RC PIPE (CL III)(24 IN)	LF	3,161.000		3,161.000	
	4122-6010	THERMOPLASTIC PIPE(24 IN)(PP)(TYPE III)	LF	223.000		223.000	
	4122-6014	THERMOPLASTIC PIPE(18 IN)(PP)(TYPE III)	LF	1,114.000		1,114.000	

Revised Quantity

REVISED 1/04 /2023

DISTRICT	COUNTY	CCSJ	SHEET
Atlanta	Titus	1226-02-016	13C

SUMMARY OF REMOVAL ITEMS											
PLAN SHEET NO.	BEGIN STA	END STA	104	104	104	105	105	542	544	658	680
			6009	6017	6022	6021	6023	6001	6003	6060	6004
			† REMOVING CONC (RIPRAP)	REMOVING CONC (DRIVEWAYS)	REMOVING CONC (CURB AND GUTTER)	REMOVING STAB BASE AND ASPH PAV (0-4")	REMOVING STAB BASE AND ASPH PAV (5")	REMOVE METAL BEAM GUARD FENCE	GUARDRAIL END TREATMENT (REMOVE)	REMOVE DELIN & OBJECT MARKER ASSMS	REMOVING TRAFFIC SIGNALS
			SY	SY	LF	SY	SY	LF	EA	EA	EA
FM 1735											
1 OF 6	1000+00.00	1022+00.00		119		289	6,554			6	
2 OF 6	1022+00.00	1044+00.00		195		257	5,282	290	4	2	
3 OF 6	1044+00.00	1066+00.00		226			13,290			2	
4 OF 6	1066+00.00	1088+00.00				256	6,857			2	
5 OF 6	1088+00.00	1110+00.00			620	324	7,584			2	
6 OF 6	1110+00.00	1132+00.00			183	49	8,237				
SH 49											
1 OF 2	186+11.94	209+50.00	93	70		85	1,094			1	1
2 OF 2	209+50.00	227+41.31	90			391	1,694				
FM 4000											
3 OF 6	1044+00.00	1066+00.00					1,685				
TOTAL			183	610	803	1,651	52,277	290	4	15	1

 **ADDED NOTE**  * IT IS THE INTENT THAT ALL STAB BASE AND ASPH PAV TO BE REMOVED UNDER THESE ITEMS.

† BID ITEM USED IN MULTIPLE SUMMARY TABLES.

REV. No.	DATE	REVISION	BY
1	1/4/23	ADDENDUM #1	DMJ

ATKINS
MEMBER OF THE SNC-LAVALIN GROUP
TBP REG. # F-474

 **Texas Department of Transportation**
©2022

FM 1735 & SH 49

SUMMARY OF QUANTITIES REMOVALS

FED. RD DIV. No.	STATE	PROJECT No.	HIGHWAY No.		
19	TEXAS		FM 1735		
STATE DISTRICT	COUNTY	CONTROL No.	SECTION No.	JOB No.	SHEET No.
ATL	TITUS	1226	02	016	15

DATE: 1/4/2023 TIME: 11:55:21 AM

PLOT DRIVER: RD_11x17_PDF.plt
 PEN TABLE: FM1735_09_TRANSPORTATION.tbl
 FILE: FM1735_09_QTY_RDWY.dgn

SUMMARY OF ROADWAY ITEMS

PLAN SHEET NO.	BEGIN STA	END STA	100	110	132	132	247	275	275	275	275	310	316	316
			6002	6001	6006	6002	6312	6001	6001	6009	6063	6021	6017	6017
Basis of Estimate			PREPARING ROW	EXCAVATION (ROADWAY)	EMBANKMENT (FINAL) (DENS CONT) (TY C)	EMBANKMENT (FINAL) (DENS CONT) (TY A)	† FL BS (CMP IN PLC) (TY D GR1-2) (8")	CEMENT	CEMENT	† CEMENT TREAT (NEW BASE) (8")	CEMENT TREAT (SUBGRADE) (10")	† PRIME COAT & BLOTTER (MC-30)	ASPH (AC-20-5TR)	ASPH (AC-20-5TR)
								25 LB/SY	34 LB/SY			0.35 GAL/SY	1ST APPLICATION 0.50 GAL/SY	2ND APPLICATION 0.40GAL/SY
FM 1735			STA	CY	CY	CY	SY	TON	TON	SY	SY	GAL	GAL	GAL
1 OF 11	1000+00.00	1011+00.00	11	25,705	1,669	2,094	7,415	93	128	7,415	7,537	2,595	3,708	2,966
2 OF 11	1011+00.00	1022+00.00	11	20,743	1,519	2,105	7,456	93	129	7,456	7,578	2,610	3,728	2,982
3 OF 11	1022+00.00	1033+00.00	11	14,851	5,517	2,105	7,456	93	129	7,456	7,578	2,610	3,728	2,982
4 OF 11	1033+00.00	1044+00.00	11	9,036	26,652	2,105	7,456	93	129	7,456	7,578	2,610	3,728	2,982
5 OF 11	1044+00.00	1055+00.00	11	7,756	1,679	2,105	7,455	93	129	7,455	7,578	2,609	3,728	2,982
6 OF 11	1055+00.00	1066+00.00	11	5,839	1,072	2,105	7,455	93	129	7,455	7,577	2,609	3,728	2,982
7 OF 11	1066+00.00	1077+00.00	11	6,517	1,550	2,105	7,456	93	129	7,456	7,578	2,610	3,728	2,982
8 OF 11	1077+00.00	1088+00.00	11	5,955	299	2,105	7,455	93	129	7,455	7,577	2,609	3,728	2,982
9 OF 11	1088+00.00	1099+00.00	11	2,789	1,961	2,105	7,456	93	129	7,456	7,578	2,610	3,728	2,982
10 OF 11	1099+00.00	1110+00.00	11	5,002	1,428	2,105	7,456	93	129	7,456	7,578	2,610	3,728	2,982
11 OF 11	1110+00.00	1111+01.14	1	740	1	193	685	9	12	685	696	240	343	274
FM 1735 SUB-TOTAL			111	104,935	43,347	21,232	75,201	939	1,301	75,201	76,433	26,322	37,603	30,078
SH 49														
1 OF 4	174+20.00	185+00.00	11											3,917
2 OF 4	185+00.00	209+50.00	25	6,758	2,534	819	2,700	34	50	2,700	2,948	945	1,350	9,587
3 OF 4	209+50.00	234+50.00	25	8,567	2,954	894	3,099	39	55	3,099	3,219	1,085	1,550	8,653
4 OF 4	234+50.00	240+60.00	6											1,844
SH 49 SUB-TOTAL			66	15,325	5,488	1,713	5,799	73	105	5,799	6,167	2,030	2,900	24,001
FM 4000														
6 OF 11		1056+75.18					1,699	21	29	1,699	1,719	595	850	680
FM 4000 SUB-TOTAL			0	0	0	0	1,699	21	29	1,699	1,719	595	850	680
TOTAL			177	120,259	48,835	22,945	82,699	1,033	1,435	82,699	84,319	28,947	41,353	54,759

UPDATED QUANTITY

SUMMARY OF ROADWAY ITEMS

PLAN SHEET NO.	BEGIN STA	END STA	316	316	354	432	529	529	536	560	3077	3077
			6173	6224	6021	6001	6002	6008	6002	6025	6065	6075
Basis of Estimate			† AGGR (TY-B GR-3 SAC-B)	AGGR (TY-PB GR-4 SAC-B)	PLANE ASPH CONC PAV (0" TO 2")	RIPRAP (CONC) (4 IN)	CONC CURB (TY II)	CONC CURB & GUTTER (TY II)	CONC MEDIAN	RELOCATE EXISTING MAILBOX	† SP MIXES SP-D SAC-A PG76-22	† TACK COAT
			1ST APPLICATION 1CY/110 SY	2ND APPLICATION 1CY/130 SY							220 LB/SY	0.1 GAL/SY OF ACP
FM 1735			CY	CY	SY	CY	LF	LF	SY	EA	TON	GAL
1 OF 11	1000+00.00	1011+00.00	67	57		88				2	816	729
2 OF 11	1011+00.00	1022+00.00	67	57		85				4	820	733
3 OF 11	1022+00.00	1033+00.00	67	57						4	820	733
4 OF 11	1033+00.00	1044+00.00	67	57						0	820	733
5 OF 11	1044+00.00	1055+00.00	67	57						1	820	733
6 OF 11	1055+00.00	1066+00.00	67	57						1	820	733
7 OF 11	1066+00.00	1077+00.00	67	57						0	820	733
8 OF 11	1077+00.00	1088+00.00	67	57						2	820	733
9 OF 11	1088+00.00	1099+00.00	67	57		167				4	820	733
10 OF 11	1099+00.00	1110+00.00	67	57		70		1,800		1	820	733
11 OF 11	1110+00.00	1111+01.14	7	23	2,213			202		2	75	67
FM 1735 SUB-TOTAL			677	593	2,213	410	0	2,002	0	21	8,271	7,393
SH 49												
1 OF 4	174+20.00	185+00.00		75						2		
2 OF 4	185+00.00	209+50.00	23	8		20	923		154	4	2,525	2,295
3 OF 4	209+50.00	234+50.00	26	41			291		48		1,791	1,628
4 OF 4	234+50.00	240+60.00		35								
SH 49 SUB-TOTAL			49	159	0	20	1,214	0	202	6	4,316	3,923
FM 4000												
6 OF 11		1056+75.18	15	13							187	164
FM 4000 SUB-TOTAL			15	13	0	0	0	0	0	0	187	164
TOTAL			741	765	2,213	430	1,214	2,002	202	27	12,774	11,480

UPDATED QUANTITY

UPDATED QUANTITIES

† BID ITEM USED IN MULTIPLE SUMMARY TABLES.

REV. No.	DATE	REVISION	BY
1	1/4/23	ADDENDUM #1	DMJ



FM 1735 & SH 49
 SUMMARY OF QUANTITIES
 ROADWAY

FED. RD DIV. No.	STATE	PROJECT No.	HIGHWAY No.		
19	TEXAS		FM 1735		
STATE DISTRICT	COUNTY	CONTROL No.	SECTION No.	JOB No.	SHEET No.
ATL	TITUS	1226	02	016	16

LEGEND

- EXISTING ROW
- - - PROPOSED ROW
- ← PROPOSED TRAFFIC DIRECTION
- [Hatched Box] PROPOSED PAVEMENT (OVERLAY)
- [Cross-hatched Box] PROPOSED SH 49 WIDENING
- [Dark Grey Box] PROPOSED DRIVEWAY
- [Stippled Box] PROPOSED 4" CONCRETE RIPRAP
- [XXX-X] CURVE ID LABEL
- [DXXX] DRIVEWAY ID LABEL
- ← · · · ← PROPOSED DITCH LEFT FLOW LINE
- ← · · · ← PROPOSED DITCH RIGHT FLOW LINE

- NOTES:
- SEE "HORIZONTAL ALIGNMENT DATA" AND "PROJECT LAYOUT" FOR MORE INFORMATION.
 - SEE "CULVERT LAYOUT" AND "DRIVEWAY DRAINAGE DETAILS" SHEETS FOR ADDITIONAL INFORMATION.
 - UTILITIES SHOWN ARE PROVIDED FOR INFORMATIONAL PURPOSES ONLY AND SHOULD BE FIELD VERIFIED PRIOR TO CONSTRUCTION.

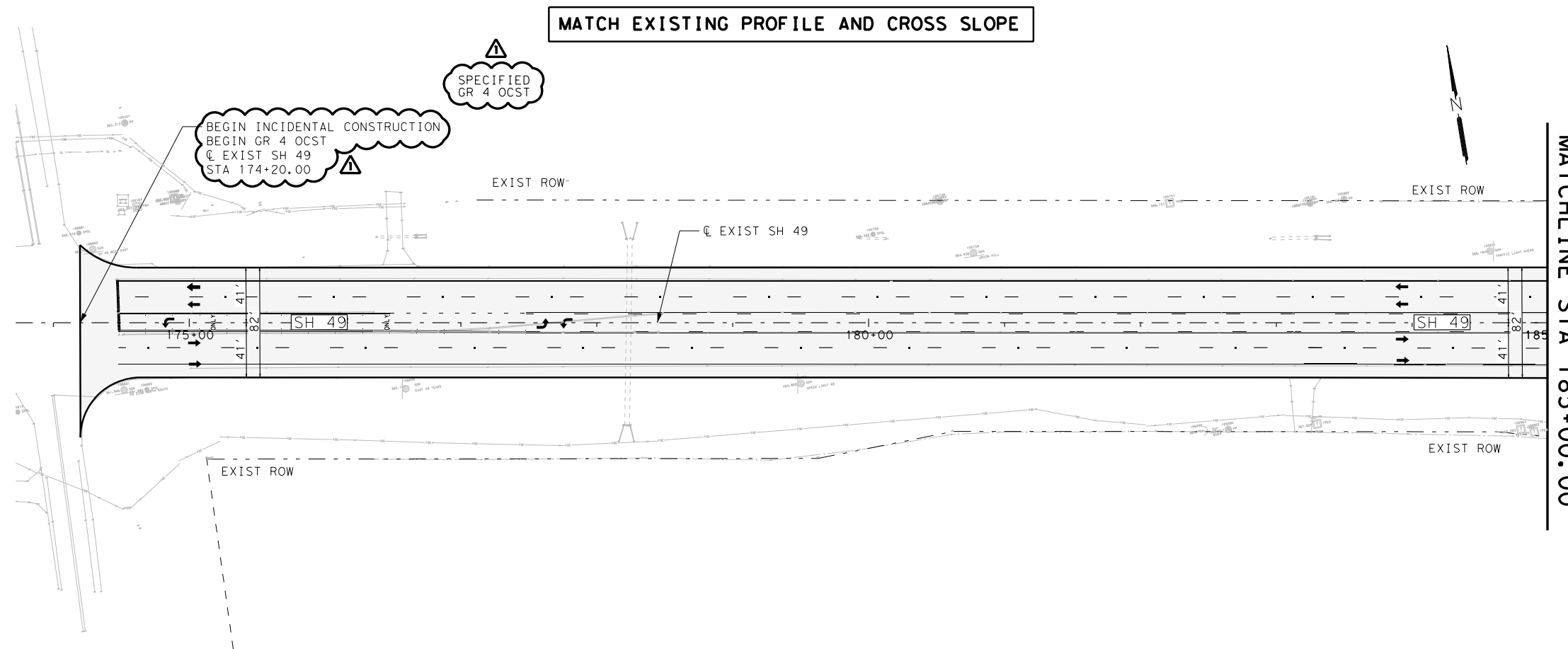
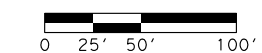

1/4/2023
DATE

DAVID M. JAMES, P.E.

REV. No.	DATE	REVISION	BY
1	1/4/23	ADDENDUM #1	DMJ

ATKINS
 MEMBER OF THE SNC-LAVALIN GROUP
 TBPE REG. # F-474

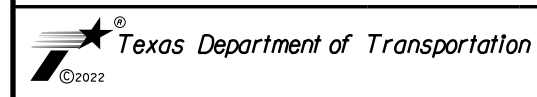

**SH 49
 PLAN
 BEG IN OF PROJECT
 TO STA 185+00.00**

SCALE: 1"=100' SHEET 1 OF 4

FED. RD DIV. No.	STATE	PROJECT No.	HIGHWAY No.		
19	TEXAS		FM 1735		
STATE DISTRICT	COUNTY	CONTROL No.	SECTION No.	JOB No.	SHEET No.
ATL	TITUS	1226	02	016	114

DATE: 1/4/2023 TIME: 10:56:15 AM

MATCH EXISTING PROFILE AND CROSS SLOPE

LEGEND

- - - - - EXISTING ROW
- - - - - PROPOSED ROW
- ← PROPOSED TRAFFIC DIRECTION
- [Hatched Box] PROPOSED PAVEMENT (OVERLAY)
- [Cross-hatched Box] PROPOSED SH 49 WIDENING
- [Dark Hatched Box] PROPOSED DRIVEWAY
- [Dotted Box] PROPOSED 4" CONCRETE RIPRAP
- [XXX-X] CURVE ID LABEL
- [DXXX] DRIVEWAY ID LABEL
- PROPOSED DITCH LEFT FLOW LINE
- PROPOSED DITCH RIGHT FLOW LINE

- NOTES:
- SEE "HORIZONTAL ALIGNMENT DATA" AND "PROJECT LAYOUT" FOR MORE INFORMATION.
 - SEE "CULVERT LAYOUT" AND "DRIVEWAY DRAINAGE DETAILS" SHEETS FOR ADDITIONAL INFORMATION.
 - UTILITIES SHOWN ARE PROVIDED FOR INFORMATIONAL PURPOSES ONLY AND SHOULD BE FIELD VERIFIED PRIOR TO CONSTRUCTION.

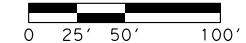

MATCHLINE STA 185+00.00

MATCHLINE STA 197+50.00

END INCIDENTAL CONSTRUCTION
 END GR 4 OCST
 BEGIN 2" ACP OVERLAY
 BEGIN PROJECT
 CSJ: 1226-02-016
 STA 186+11.94
 SH 49
 N: 7116224.4634
 E: 3065627.9506

SPECIFIED
 GR 4 OCST
 AND ACP

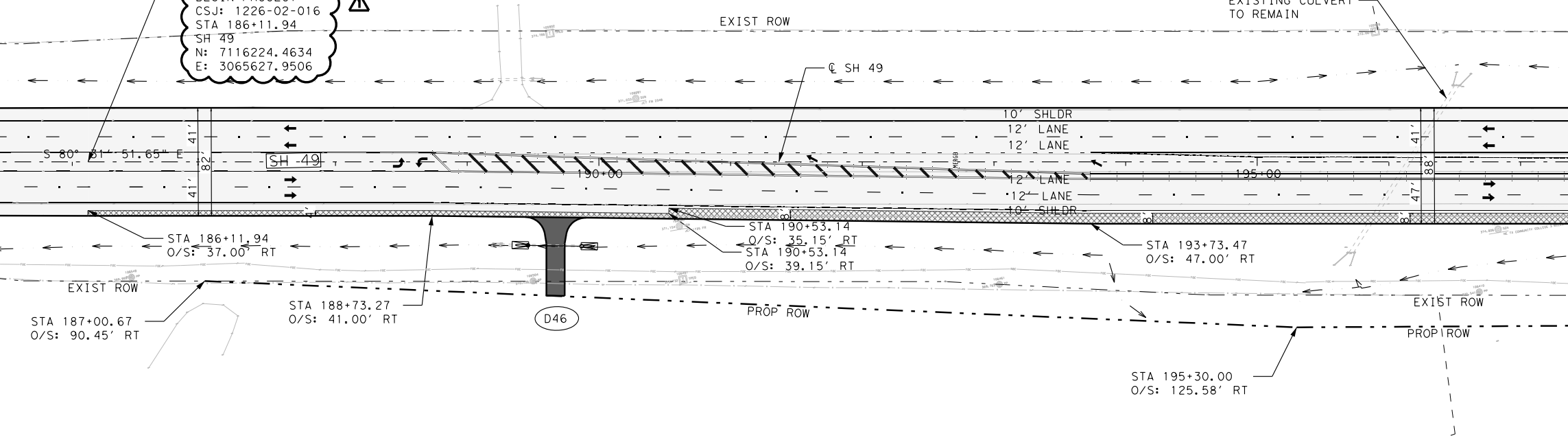

SH 49-CL-3

PI STATION	= 206+06.04
DELTA	= 0° 30' 07.17" (LT)
DEGREE OF CURVE	= 0° 02' 20.24"
TANGENT	= 644.34
LENGTH	= 1,288.67
RADIUS	= 147,084.50
PC STATION	= 199+61.70
PT STATION	= 212+50.37

MATCHLINE STA 197+50.00

MATCHLINE STA 209+50.00

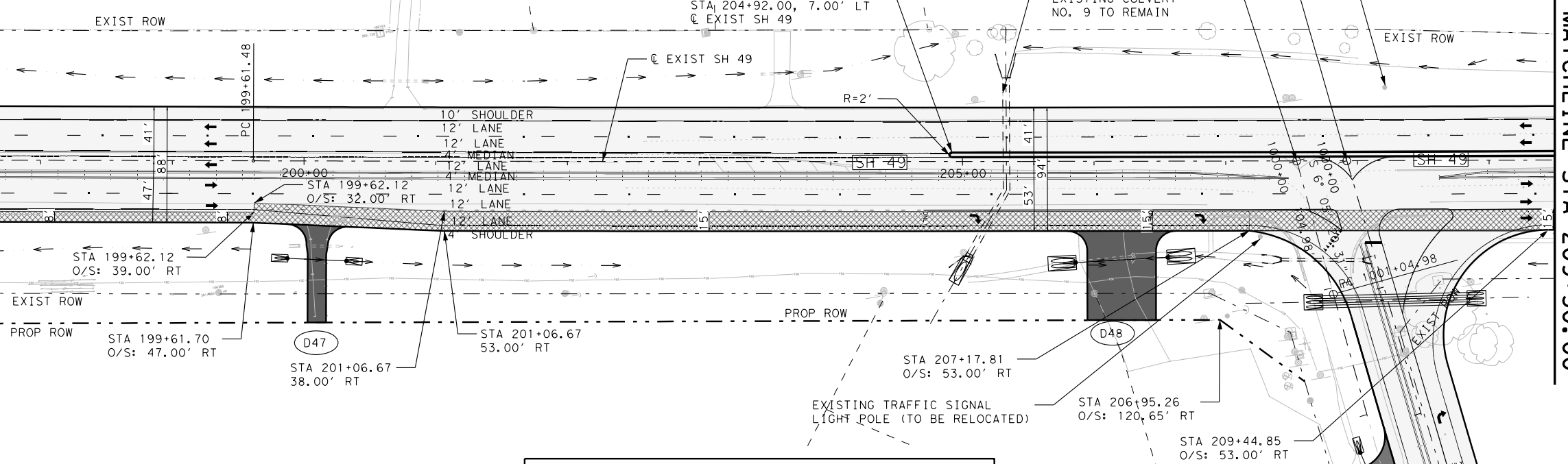

MATCH EXISTING PROFILE AND CROSS SLOPE

STATE OF TEXAS
 DAVID M. JAMES
 122261
 PROFESSIONAL ENGINEER
 1/4/2023
 DATE

REV. No.	DATE	REVISION	BY
1	1/4/23	ADDENDUM #1	DMJ

ATKINS
 MEMBER OF THE SNC-LAVALIN GROUP
 TBPE REG. # F-474



SH 49
 PLAN
 STA 185+00.00
 TO STA 209+50.00

SCALE: 1"=100' SHEET 2 OF 4

FED. RD DIV. No.	STATE	PROJECT No.	HIGHWAY No.		
19	TEXAS		FM 1735		
STATE DISTRICT	COUNTY	CONTROL No.	SECTION No.	JOB No.	SHEET No.
ATL	TITUS	1226	02	016	115

PLOT DRIVER: RD_11x17_PDF.plt
 PEN TABLE: FMI735--transportation.tbl
 FILE: FMI735_15_SH49_DBLP01.dgn

MATCH EXISTING PROFILE AND CROSS SLOPE

LEGEND

- EXISTING ROW
- - - PROPOSED ROW
- ← PROPOSED TRAFFIC DIRECTION
- ▨ PROPOSED PAVEMENT (OVERLAY)
- ▩ PROPOSED SH 49 WIDENING
- ▧ PROPOSED DRIVEWAY
- ▤ PROPOSED 4" CONCRETE RIPRAP
- XXX-X CURVE ID LABEL
- DXXX DRIVEWAY ID LABEL
- ← . . . ← PROPOSED DITCH LEFT FLOW LINE
- ← . . . → PROPOSED DITCH RIGHT FLOW LINE

- NOTES:
- SEE "HORIZONTAL ALIGNMENT DATA" AND "PROJECT LAYOUT" FOR MORE INFORMATION.
 - SEE "CULVERT LAYOUT" AND "DRIVEWAY DRAINAGE DETAILS" SHEETS FOR ADDITIONAL INFORMATION.
 - UTILITIES SHOWN ARE PROVIDED FOR INFORMATIONAL PURPOSES ONLY AND SHOULD BE FIELD VERIFIED PRIOR TO CONSTRUCTION.

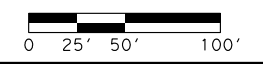

1/4/2023
DATE

DAVID M. JAMES, P.E.

REV. No.	DATE	REVISION	BY
1	1/4/23	ADDENDUM #1	DMJ

ATKINS
MEMBER OF THE SNC-LAVALIN GROUP
TBP REG. # F-474



**SH 49
PLAN**
STA 209+50.00 TO
STA 234+50.00

SCALE: 1"=100' SHEET 3 OF 4

FED. RD DIV. No.	STATE	PROJECT No.	HIGHWAY No.		
19	TEXAS		FM 1735		
STATE DISTRICT	COUNTY	CONTROL No.	SECTION No.	JOB No.	SHEET No.
ATL	TITUS	1226	02	016	116

MATCHLINE STA 209+50.00

MATCHLINE STA 221+50.00

MATCHLINE STA 221+50.00

MATCHLINE STA 234+50.00

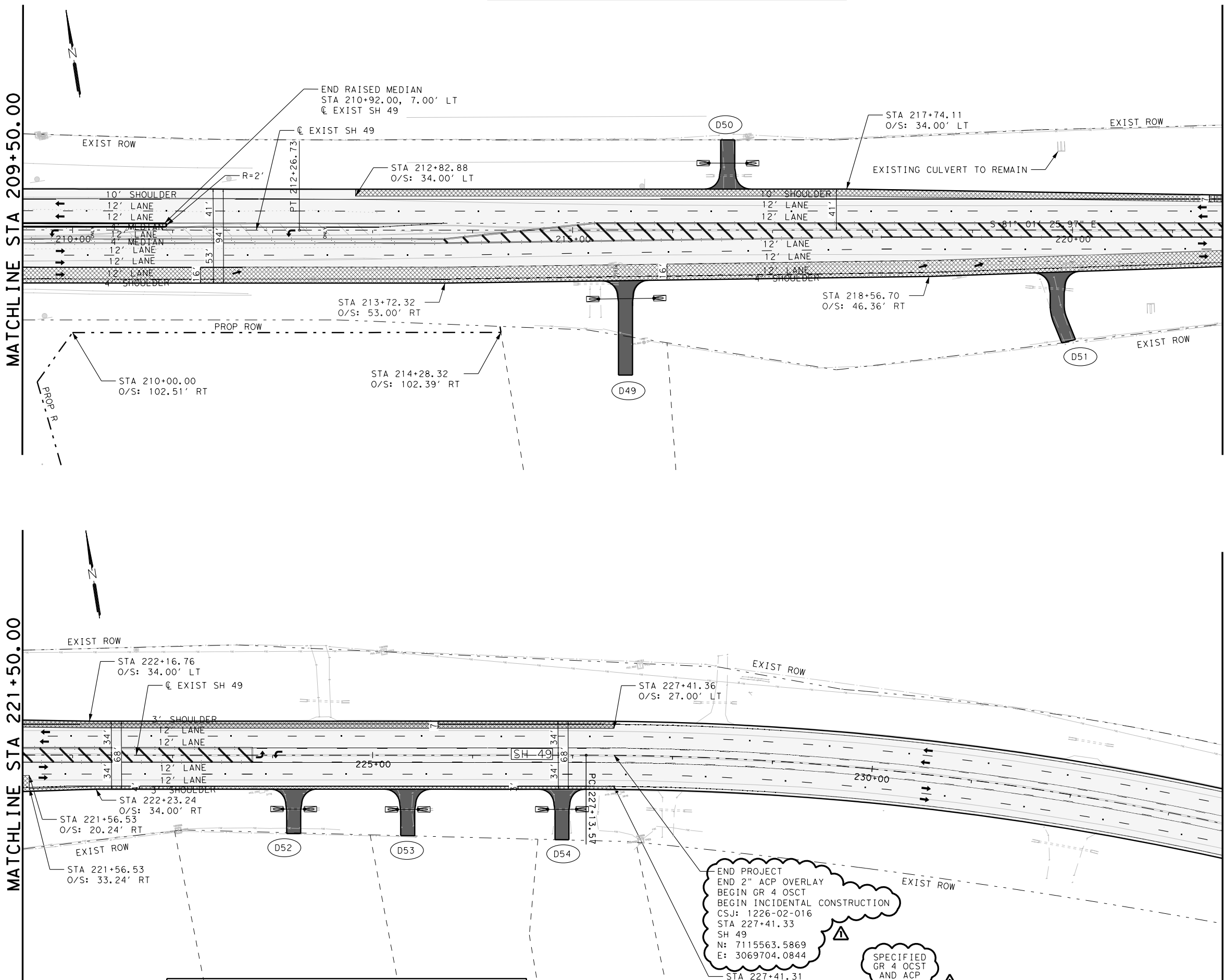

END PROJECT
END 2" ACP OVERLAY
BEGIN GR 4 OCST
BEGIN INCIDENTAL CONSTRUCTION
CSJ: 1226-02-016
STA 227+41.33
SH 49
N: 7115563.5869
E: 3069704.0844

SPECIFIED
GR 4 OCST
AND ACP

MATCH EXISTING PROFILE AND CROSS SLOPE

DATE: 1/4/2023 TIME: 10:57:48 AM
PLOT DRIVER: RD_11x17_PDF.plt
PEN TABLE: FMI735_--transportation.tbl
FILE: FMI735_16_SH49_DBLP02.dgn

MATCH EXISTING PROFILE AND CROSS SLOPE

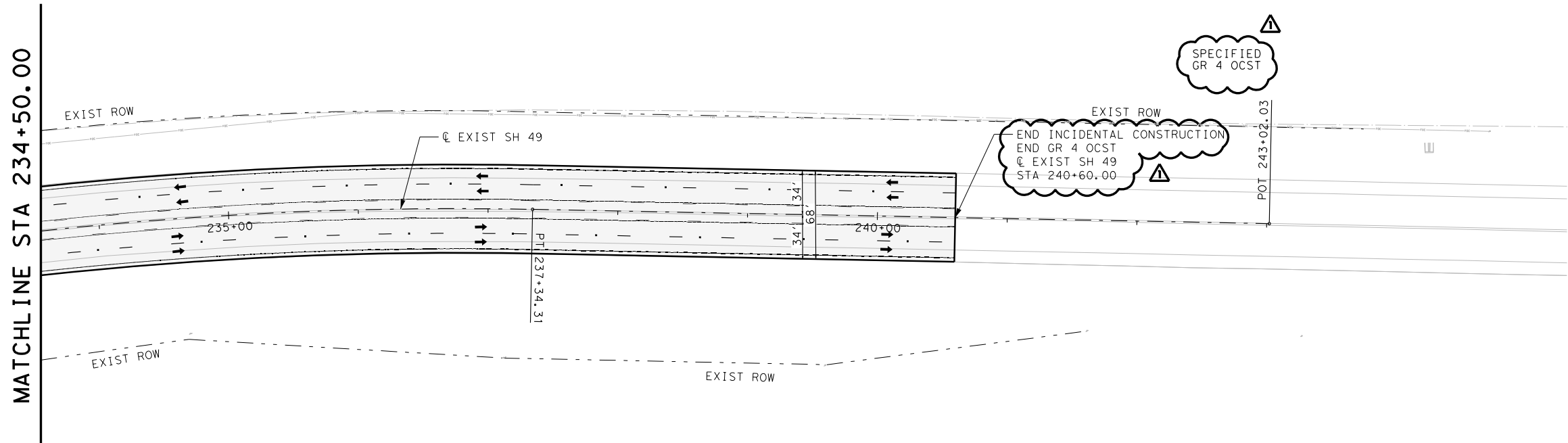

LEGEND

- EXISTING ROW
- - - PROPOSED ROW
- ← PROPOSED TRAFFIC DIRECTION
- ▨ PROPOSED PAVEMENT (OVERLAY)
- ▩ PROPOSED SH 49 WIDENING
- PROPOSED DRIVEWAY
- ▤ PROPOSED 4" CONCRETE RIPRAP
- XXX-X CURVE ID LABEL
- DXXX DRIVEWAY ID LABEL
- ← . . ← PROPOSED DITCH LEFT FLOW LINE
- ← . . ← PROPOSED DITCH RIGHT FLOW LINE

- NOTES:
- SEE "HORIZONTAL ALIGNMENT DATA" AND "PROJECT LAYOUT" FOR MORE INFORMATION.
 - SEE "CULVERT LAYOUT" AND "DRIVEWAY DRAINAGE DETAILS" SHEETS FOR ADDITIONAL INFORMATION.
 - UTILITIES SHOWN ARE PROVIDED FOR INFORMATIONAL PURPOSES ONLY AND SHOULD BE FIELD VERIFIED PRIOR TO CONSTRUCTION.

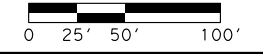

1/4/2023
DATE

DAVID M. JAMES, P.E.

REV. No.	DATE	REVISION	BY
1	1/4/23	ADDENDUM #1	DMJ

ATKINS
MEMBER OF THE SNC-LAVALIN GROUP
T&E REG. # F-474



**SH 49
PLAN
STA 209+50.00 TO
END OF PROJECT**

SCALE: 1"=100' SHEET 4 OF 4

FED. RD DIV. No.	STATE	PROJECT No.	HIGHWAY No.		
19	TEXAS		FM 1735		
STATE DISTRICT	COUNTY	CONTROL No.	SECTION No.	JOB No.	SHEET No.
ATL	TITUS	1226	02	016	117