

SUBJECT: PLANS AND PROPOSAL ADDENDUMS
PROJECT: STP 1902(308)MM CONTROL: 0912-72-386
COUNTY: HARRIS
LETTING: 09/07/2022
REFERENCE NO: 0826

PROPOSAL ADDENDUMS

-
- ___ PROPOSAL COVER
- X BID INSERTS (SH. NO.: ALL)
- ___ GENERAL NOTES (SH. NO.:)
- ___ SPEC LIST (SH. NO.:)
- ___ SPECIAL PROVISIONS:)
- ___ ADDED:
- DELETED:
- ___ SPECIAL SPECIFICATIONS:
- ___ ADDED:
- DELETED:
- X OTHER: PLAN SHEET AND OTHER CHANGES

DESCRIPTION OF ABOVE CHANGES
(INCLUDING PLANS SHEET CHANGES)

*****BID INSERTS*****

BID INSERTS ARE REPLACED DUE TO THE ABOVE CHANGES AND LINE SHIFTS
REVISED QUANTITIES FOR ITEM: 508-6001
DELETED BID ITEM: 400-6006

*****PLAN SHEETS*****

SHEET 029 (ESTIMATE AND QUANTITY): DELETED BID ITEM 400-6006
SHEET 030 (ESTIMATE AND QUANTITY): REVISED QUANTITY FOR ITEM 508-6001
SHEETS 29-33: REVISED DUE TO LINE SHIFTS
SHEET 045 (SUMMARY OF TRAFFIC CONTROL PLAN QUANTITIES): DELETED BID ITEM
400-6006 AND REVISED QUANTITY FOR ITEM 508-6001
SHEET 060 (PROPOSED TRAFFIC CONTROL TYPICAL SECTIONS PHASE 2): UPDATED
DESCRIPTION OF ABOVE CHANGES (CONTINUED)
(INCLUDING PLANS SHEET CHANGES)

TYPICAL SECTIONS TO INCLUDE TEMPORARY ASPHALT DETAILS

SHEET 062 (PROPOSED TRAFFIC CONTROL TYPICAL SECTIONS PHASE 3): UPDATED
TYPICAL SECTIONS TO INCLUDE TEMPORARY ASPHALT DETAILS

SHEET 066 (PROPOSED TRAFFIC CONTROL TYPICAL SECTIONS PHASE 4): UPDATED
TYPICAL SECTIONS TO INCLUDE TEMPORARY ASPHALT DETAILS

SHEET 067 (TRAFFIC CONTROL PLAN PHASE 5): UPDATED SHEET TO ALIGN THE
ORIENTATION WITH ACTUAL TCP TYPICAL SECTIONS



Estimate & Quantity Sheet

CONTROLLING PROJECT ID 0912-72-386

DISTRICT Houston
HIGHWAY NAVIGATION

COUNTY Harris

CONTROL SECTION JOB				0912-72-386		0912-72-648		TOTAL EST.	TOTAL FINAL
PROJECT ID				A00123353		R00009075			
COUNTY				Harris					
HIGHWAY				NAVIGATION					
ALT	BID CODE	DESCRIPTION	UNIT	EST.	FINAL	EST.	FINAL		
	100-6002	PREPARING ROW	STA	19.000				19.000	
	100-6006	PREP ROW (TREE)(LESS THAN 24" DIA)	EA	15.000				15.000	
	104-6001	REMOVING CONC (PAV)	SY	8,429.000				8,429.000	
	104-6011	REMOVING CONC (MEDIANS)	SY	397.000				397.000	
	104-6017	REMOVING CONC (DRIVEWAYS)	SY	202.000				202.000	
	104-6029	REMOVING CONC (CURB OR CURB & GUTTER)	LF	3,711.000				3,711.000	
	104-6036	REMOVING CONC (SIDEWALK OR RAMP)	SY	905.000				905.000	
	104-6040	REMOVING CONC (PAVERS)	SY	9.000				9.000	
	104-6067	REMOVING CONC (SAWCUT)	LF	1,287.000				1,287.000	
	110-6001	EXCAVATION (ROADWAY)	CY	9,228.000				9,228.000	
	132-6005	EMBANKMENT (FINAL)(ORD COMP)(TY C)	CY	261.000				261.000	
	161-6009	EROSION CONTROL COMPOST	CY	13.400				13.400	
	161-6012	GENERAL USE COMPOST	CY	6.600				6.600	
	162-6002	BLOCK SODDING	SY	4,641.000				4,641.000	
	166-6001	FERTILIZER	AC	0.960				0.960	
	168-6001	VEGETATIVE WATERING	MG	115.000				115.000	
	170-6002	IRRIGATION SYSTEM (TY I)	LS	1.000				1.000	
	192-6025	PLANT MATERIAL (45 GAL) (TREE)	EA	11.000				11.000	
	192-6027	PLANT MATERIAL (100 GAL) (TREE)	EA	19.000				19.000	
	193-6001	PLANT MAINTENANCE	MO	3.000				3.000	
	260-6012	LIME(HYD,COM OR QK)(SLRY)OR QK(DRY)	TON	187.000				187.000	
	260-6073	LIME TRT (SUBGRADE)(8")	SY	8,566.000				8,566.000	
	260-6079	LIME TRT (SUBGRADE)(6")	SY	1,969.000				1,969.000	
	275-6001	CEMENT	TON	27.000				27.000	
	275-6010	CEMENT TREAT (SUBGRADE) (8")	SY	1,634.000				1,634.000	
	275-6019	CEMENT TREAT (SUBGRADE)(6")	SY	160.000				160.000	
	354-6041	PLANE ASPH CONC PAV (1.5")	SY	384.000				384.000	
	360-6028	CONC PAV (JOINT REINF) (6")	SY	1,489.000				1,489.000	
	360-6050	CONC PAV (CONT REINF)(FAST TRK)(11")	SY	341.000				341.000	
	360-6086	CONC PAV (JOINT REINF) (11")	SY	6,352.000				6,352.000	
	400-6005	CEM STABIL BKFL	CY	1,080.000				1,080.000	
	400-6009	CEMENT STAB BACKFILL (INLET OR MH)	CY	294.000				294.000	
	402-6001	TRENCH EXCAVATION PROTECTION	LF	2,074.000		374.000		2,448.000	
	420-6009	CL A CONC (COLLAR)	EA	2.000				2.000	
	420-6062	CL C CONC (RETAINING WALL)	CY	16.000				16.000	
	462-6006	CONC BOX CULV (5 FT X 2 FT)	LF	400.000				400.000	
	462-6099	CONC BOX CULV (6 FT X 2 FT)	LF	12.000				12.000	



ADDENDUM #1, 8/30/2022, REPLACE SHEET



Estimate & Quantity Sheet

CONTROLLING PROJECT ID 0912-72-386

DISTRICT Houston
HIGHWAY NAVIGATION

COUNTY Harris

CONTROL SECTION JOB				0912-72-386		0912-72-648		TOTAL EST.	TOTAL FINAL
PROJECT ID				A00123353		R00009075			
COUNTY				Harris					
HIGHWAY				NAVIGATION					
ALT	BID CODE	DESCRIPTION	UNIT	EST.	FINAL	EST.	FINAL		
	464-6005	RC PIPE (CL III)(24 IN)	LF	1,538.000				1,538.000	
	464-6032	RC PIPE (ARCH)(CL III)(DES 3)	LF	53.000				53.000	
	464-6033	RC PIPE (ARCH)(CL III)(DES 4)	LF	71.000				71.000	
	465-6002	MANH (COMPL)(PRM)(48IN)	EA	1.000				1.000	
	465-6004	MANH (COMPL)(PRM)(72IN)	EA	1.000				1.000	
	465-6173	MANH (COMPL)(TY A)	EA	6.000				6.000	
	465-6175	INLET (COMPL)(CURB)(TY C)	EA	17.000				17.000	
	465-6176	INLET (COMPL)(CURB)(TY C1)	EA	1.000				1.000	
	465-6177	INLET (COMPL)(TY AZ2G)	EA	2.000				2.000	
	465-6259	INLET (COMPL)(EXT TY C)	EA	7.000				7.000	
	479-6001	ADJUSTING MANHOLES	EA	5.000				5.000	
	496-6002	REMOV STR (INLET)	EA	5.000				5.000	
	496-6003	REMOV STR (MANHOLE)	EA	3.000				3.000	
	496-6007	REMOV STR (PIPE)	LF	726.000				726.000	
	496-6099	REMOVE STR (RAIL)	LF	20.000				20.000	
	500-6001	MOBILIZATION	LS	1.000				1.000	
	502-6001	BARRICADES, SIGNS AND TRAFFIC HANDLING	MO	10.000				10.000	
	506-6020	CONSTRUCTION EXITS (INSTALL) (TY 1)	SY	450.000				450.000	
	506-6024	CONSTRUCTION EXITS (REMOVE)	SY	450.000				450.000	
	506-6038	TEMP SEDMT CONT FENCE (INSTALL)	LF	213.000				213.000	
	506-6039	TEMP SEDMT CONT FENCE (REMOVE)	LF	213.000				213.000	
	506-6041	BIODEG EROSN CONT LOGS (INSTL) (12")	LF	251.000				251.000	
	506-6043	BIODEG EROSN CONT LOGS (REMOVE)	LF	251.000				251.000	
	508-6001	CONSTRUCTING DETOURS	SY	3,055.000				3,055.000	
	512-6009	PORT CTB (FUR & INST)(LOW PROF)(TY 1)	LF	400.000				400.000	
	512-6010	PORT CTB (FUR & INST)(LOW PROF)(TY 2)	LF	80.000				80.000	
	512-6033	PORT CTB (MOVE)(LOW PROF)(TY 1)	LF	340.000				340.000	
	512-6034	PORT CTB (MOVE)(LOW PROF)(TY 2)	LF	60.000				60.000	
	512-6057	PORT CTB (REMOVE)(LOW PROF)(TY 1)	LF	400.000				400.000	
	512-6058	PORT CTB (REMOVE)(LOW PROF)(TY 2)	LF	80.000				80.000	
	512-6080	PORT CTB CONNECT HARDWARE	EA	48.000				48.000	
	528-6004	LANDSCAPE PAVERS	SY	45.000				45.000	
	528-6013	COLORLED TEXTURED CONC (6"-17")	SY	576.000				576.000	
	529-6001	CONC CURB (TY I)	LF	400.000				400.000	
	529-6008	CONC CURB & GUTTER (TY II)	LF	21.000				21.000	
	529-6011	CONC CURB (DOWEL)	LF	3,541.000				3,541.000	
	529-6045	CONC CURB (DOWEL)(9")	LF	28.000				28.000	



ADDENDUM #1, 8/30/2022, REPLACE SHEET



Estimate & Quantity Sheet

CONTROLLING PROJECT ID 0912-72-386

DISTRICT Houston
HIGHWAY NAVIGATION

COUNTY Harris

CONTROL SECTION JOB				0912-72-386		0912-72-648		TOTAL EST.	TOTAL FINAL
PROJECT ID				A00123353		R00009075			
COUNTY				Harris					
HIGHWAY				NAVIGATION					
ALT	BID CODE	DESCRIPTION	UNIT	EST.	FINAL	EST.	FINAL		
	530-6025	DRIVEWAYS (CONC) (FAST TRACK)	SY	236.000				236.000	
	531-6004	CURB RAMPS (TY 1)	EA	10.000				10.000	
	531-6010	CURB RAMPS (TY 7)	EA	6.000				6.000	
	531-6016	CURB RAMPS (TY 21)	EA	4.000				4.000	
	531-6048	CONC SIDEWALKS (9")	SY	13.000				13.000	
	536-6002	CONC MEDIAN	SY	4.000				4.000	
	618-6047	CONDT (PVC) (SCH 80) (2") (BORE)	LF	817.000				817.000	
	618-6053	CONDT (PVC) (SCH 80) (3")	LF	98.000				98.000	
	636-6001	ALUMINUM SIGNS (TY A)	SF	408.000				408.000	
	644-6001	IN SM RD SN SUP&AM TY10BWG(1)SA(P)	EA	40.000				40.000	
	644-6004	IN SM RD SN SUP&AM TY10BWG(1)SA(T)	EA	3.000				3.000	
	644-6007	IN SM RD SN SUP&AM TY10BWG(1)SA(U)	EA	4.000				4.000	
	644-6040	IN SM RD SN SUP&AM TYS80(1)SB(P-BM)	EA	1.000				1.000	
	662-6048	WK ZN PAV MRK REMOV (REFL) TY I-C	EA	592.000				592.000	
	662-6050	WK ZN PAV MRK REMOV (REFL) TY II-A-A	EA	75.000				75.000	
	662-6057	WK ZN PAV MRK REMOV (TRAF BTN) TY W	LF	4,734.000				4,734.000	
	662-6059	WK ZN PAV MRK REMOV (TRAF BTN) TY Y	LF	8,527.000				8,527.000	
	662-6075	WK ZN PAV MRK REMOV (W)24"(SLD)	LF	290.000				290.000	
	662-6080	WK ZN PAV MRK REMOV (W)(ARROW)	EA	16.000				16.000	
	662-6081	WK ZN PAV MRK REMOV (W)(DBL ARROW)	EA	4.000				4.000	
	662-6088	WK ZN PAV MRK REMOV (W)(TPL ARROW)	EA	4.000				4.000	
	666-6036	REFL PAV MRK TY I (W)8"(SLD)(100MIL)	LF	89.000				89.000	
	666-6048	REFL PAV MRK TY I (W)24"(SLD)(100MIL)	LF	490.000				490.000	
	666-6138	REFL PAV MRK TY I (Y)8"(SLD)(100MIL)	LF	48.000				48.000	
	666-6306	RE PM W/RET REQ TY I (W)6"(BRK)(100MIL)	LF	238.000				238.000	
	666-6309	RE PM W/RET REQ TY I (W)6"(SLD)(100MIL)	LF	660.000				660.000	
	666-6321	RE PM W/RET REQ TY I (Y)6"(SLD)(100MIL)	LF	192.000				192.000	
	668-6077	PREFAB PAV MRK TY C (W) (ARROW)	EA	6.000				6.000	
	668-6078	PREFAB PAV MRK TY C (W) (DBL ARROW)	EA	8.000				8.000	
	668-6079	PREFAB PAV MRK TY C (W) (TPL ARROW)	EA	3.000				3.000	
	668-6085	PREFAB PAV MRK TY C (W) (WORD)	EA	3.000				3.000	
	668-6091	PREFAB PAV MRK TY C (W) (18")(YLD TRI)	EA	53.000				53.000	
	668-6096	PREFAB PAV MRK TY C (W)(BIKE SYMBOL)	EA	5.000				5.000	
	668-6128	PREFAB PAV MRK TY C (GRN)(SLD)(BLOCK)	SF	1,003.000				1,003.000	
	672-6007	REFL PAV MRKR TY I-C	EA	41.000				41.000	
	677-6001	ELIM EXT PAV MRK & MRKS (4")	LF	412.000				412.000	
	678-6002	PAV SURF PREP FOR MRK (6")	LF	4,182.000				4,182.000	



ADDENDUM #1, 8/30/2022, REPLACE SHEET



Estimate & Quantity Sheet

CONTROLLING PROJECT ID 0912-72-386

DISTRICT Houston
HIGHWAY NAVIGATION

COUNTY Harris

CONTROL SECTION JOB				0912-72-386		0912-72-648		TOTAL EST.	TOTAL FINAL
PROJECT ID				A00123353		R00009075			
COUNTY				Harris					
HIGHWAY				NAVIGATION					
ALT	BID CODE	DESCRIPTION	UNIT	EST.	FINAL	EST.	FINAL		
	678-6004	PAV SURF PREP FOR MRK (8")	LF	273.000				273.000	
	678-6008	PAV SURF PREP FOR MRK (24")	LF	1,843.000				1,843.000	
	678-6009	PAV SURF PREP FOR MRK (ARROW)	EA	6.000				6.000	
	678-6010	PAV SURF PREP FOR MRK (DBL ARROW)	EA	8.000				8.000	
	678-6011	PAV SURF PREP FOR MRK (TPL ARROW)	EA	3.000				3.000	
	678-6016	PAV SURF PREP FOR MRK (WORD)	EA	3.000				3.000	
	678-6022	PAV SURF PREP FOR MRK (18")(YLD TRI)	EA	53.000				53.000	
	678-6028	PAV SURF PREP FOR MRK (BIKE SYMBOL)	EA	5.000				5.000	
	680-6004	REMOVING TRAFFIC SIGNALS	EA	1.000				1.000	
	681-6001	TEMP TRAF SIGNALS	EA	1.000				1.000	
	730-6107	FULL - WIDTH MOWING	CYC	3.000				3.000	
	734-6002	LITTER REMOVAL	CYC	3.000				3.000	
	735-6001	DEBRIS REMOVAL (CNTR MEDIANS/MAINLANES)	CYC	18.000				18.000	
	738-6001	CLEANING / SWEEPING (CENTER MEDIAN)	CYC	9.000				9.000	
	1002-6001	LANDSCAPE AMENITY	EA	9.000				9.000	
	1002-6002	LANDSCAPE AMENITY (TY 1)	EA	9.000				9.000	
	1004-6001	TREE PROTECTION	EA	39.000				39.000	
	1006-6001	LANDSCAPE SOIL AMENDMENT (TYPE I)	SY	120.000				120.000	
	1006-6002	LANDSCAPE SOIL AMENDMENT (TYPE II)	SY	120.000				120.000	
	1006-6003	LANDSCAPE SOIL AMENDMENT (TYPE III)	SY	30.000				30.000	
	1006-6004	LANDSCAPE SOIL AMENDMENT (TYPE IV)	SY	90.000				90.000	
	3076-6035	D-GR HMA TY-D PG64-22	TON	73.000				73.000	
	3076-6066	TACK COAT	GAL	87.000				87.000	
	6001-6001	PORTABLE CHANGEABLE MESSAGE SIGN	DAY	1,080.000				1,080.000	
	6038-6004	MULTIPOLYMER PAV MRK (W)(6")(SLD)	LF	1,083.000				1,083.000	
	6038-6005	MULTIPOLYMER PAV MRK (W)(6")(BRK)	LF	112.000				112.000	
	6038-6006	MULTIPOLYMER PAV MRK (W)(6")(DOT)	LF	60.000				60.000	
	6038-6007	MULTIPOLYMER PAV MRK (W)(8")(SLD)	LF	54.000				54.000	
	6038-6009	MULTIPOLYMER PAV MRK (W)(8")(DOT)	LF	82.000				82.000	
	6038-6013	MULTIPOLYMER PAV MRK (W)(24")(SLD)	LF	350.000				350.000	
	6038-6017	MULTIPOLYMER PAV MRK (Y)(6")(SLD)	LF	1,837.000				1,837.000	
	6185-6002	TMA (STATIONARY)	DAY	40.000				40.000	
	6185-6003	TMA (MOBILE OPERATION)	HR	40.000				40.000	
	6306-6001	VIVDS PROSR SYS	EA	1.000				1.000	
	7017-6041	CASING (STEEL) (SANITARY SEWER) (12 IN)	LF			110.000		110.000	
	7017-6042	CASING (STEEL) (SANITARY SEWER) (16 IN)	LF			14.000		14.000	
	7017-6199	CASING (STEEL) (SAN SEWER) (36IN)	LF			16.000		16.000	



ADDENDUM #1, 8/30/2022, REPLACE SHEET



Estimate & Quantity Sheet

CONTROLLING PROJECT ID 0912-72-386

DISTRICT Houston
HIGHWAY NAVIGATION

COUNTY Harris

CONTROL SECTION JOB				0912-72-386		0912-72-648		TOTAL EST.	TOTAL FINAL
PROJECT ID				A00123353		R00009075			
COUNTY				Harris					
HIGHWAY				NAVIGATION					
ALT	BID CODE	DESCRIPTION	UNIT	EST.	FINAL	EST.	FINAL		
	7049-6020	WTR MAIN PIPE (PVC)(RESTRAINED JT) 8IN	LF			304.000		304.000	
	7049-6021	WTR MAIN PIPE (PVC)(RESTRAINED JT) 12IN	LF			53.000		53.000	
	7049-6052	FIRE HYDRANT BRANCH (LEAD) (6IN)	LF			17.000		17.000	
	7049-6097	TAPPING SLEEVE AND VALVE (24IN X 8IN)	EA			2.000		2.000	
	7049-6104	FIRE HYDRANT ASSEMBLY	EA			2.000		2.000	
	7049-6119	REMOVING AND SALVAGING FIRE HYDRANT	EA			10.000		10.000	
	7049-6126	CUT AND PLUG WATER MAIN (6IN)	EA			2.000		2.000	
	7049-6127	CUT AND PLUG WATER MAIN (8IN)	EA			5.000		5.000	
	7049-6129	CUT AND PLUG WATER MAIN (12IN)	EA			2.000		2.000	
	7049-6139	WET CONNECTION (6IN)	EA			2.000		2.000	
	7049-6140	WET CONNECTION (8IN)	EA			2.000		2.000	
	7049-6142	WET CONNECTION (12IN)	EA			2.000		2.000	
	7049-6158	WTR MAIN PIPE (PVC) (RESTRAINED JT) 6IN	LF			6.000		6.000	
	7049-6382	JK TN BR AG WTR MN(PVC)(8IN)(RESTR JNT)	LF			240.000		240.000	
	18	ELECTRICAL: CONTRACTOR FORCE ACCOUNT WORK (PARTICIPATING)	LS	1.000				1.000	
		EROSION CONTROL MAINTENANCE: CONTRACTOR FORCE ACCOUNT WORK (PART)	LS	1.000				1.000	
		SAFETY CONTINGENCY: CONTRACTOR FORCE ACCOUNT WORK (PARTICIPATING)	LS	1.000				1.000	
		LAW ENFORCEMENT: CONTRACTOR FORCE ACCOUNT WORK (PARTICIPATING)	LS	1.000				1.000	
	39	CITY FORCE ACCOUNT WORK (PARTICIPATING)	LS	1.000				1.000	



ADDENDUM #1, 8/30/2022, REPLACE SHEET

SUMMARY OF TRAFFIC CONTROL QUANTITIES																						
ITEM DESC. CODE	0400 6006	0500 6001	0502 6001	0508 6001	0512 6009	0512 6010	0512 6033	0512 6034	0512 6057	0512 6058	0512 6080	0662 6057	0662 6059	0662 6080	0662 6081	0662 6048	0662 6050	0662 6075	0662 6088	6001 6001	6185 6002	6185 6003
TCP PLAN SHEETS	CUT & RESTORING PAV	MOBILIZATION	BARRICADES, SIGNS AND TRAFFIC HANDLING	CONSTRUCTION DETOURS	PORT CTB (FUR & INST) (LOW PROF) (TY 1)	PORT CTB (FUR & INST) (LOW PROF) (TY 2)	PORT CTB (MOVE) (LOW PROF) (TY 1)	PORT CTB (MOVE) (LOW PROF) (TY 2)	PORT CTB (REMOVE) (LOW PROF) (TY 1)	PORT CTB (REMOVE) (LOW PROF) (TY 2)	PORT CTB CONNECT HARDWARE	WK ZN PAV MRK REMOV (TRAF BTN) TY W	WK ZN PAV MRK REMOV (TRAF BTN) TY Y	WK ZN PAV MRK REMOV (W) (ARRO W)	WK ZN PAV MRK REMOV (W) (DBL ARROW)	WK ZN PAV MRK REMOV (REFL) TY I-C	WK ZN PAV MRK REMOV (REFL) TY II-A-A	WK ZN PAV MRK REMOV (W) 24" (S LD)	WK ZN PAV MRK REMOV (W) (TFL ARROW)	PORTABLE CHANGEABLE MESSAGE SIGN	TMA (STATION ARY)	TMA (MOBILE OPERATION)
	SY	LS	MO	SY	LF	LF	LF	LF	LF	LF	EA	LF	LF	EA	EA	EA	EA	LF	EA	DAY	DAY	HR
PHASES 1 1 of 1 SUBTOTAL	2087 2087			3055 1924																		
PHASE 2 STEP 1 - 1 of 1 STEP 2 - 1 of 2 STEP 3 - 2 of 2 SUBTOTAL	0076				40 360	20 60	40 60	20 20	40 360	20 60	6 42	140 1901	2223 155	4 1		7 179	28 28	41 71	1 1			
PHASE 3 STEP 1 - 1 of 1 STEP 2 - 2 of 2 SUBTOTAL	0076				400	80	100	40	400	80	48	2196	3678	5		267	28	112	2			
PHASE 4 1 of 1 SUBTOTAL							240	20				909	1875	3		122	18	55	1			
PHASE 5 1 of 1 SUBTOTAL												500	1442	3	1	78	20	24				
PHASE 6 1 of 1 SUBTOTAL												500	1442	3	1	78	20	24				
TOTAL	2,163	1	10	1,924 3055	400	80	340	60	400	80	48	4,734	8,527	16	4	592	75	290	4	1,080	40	40

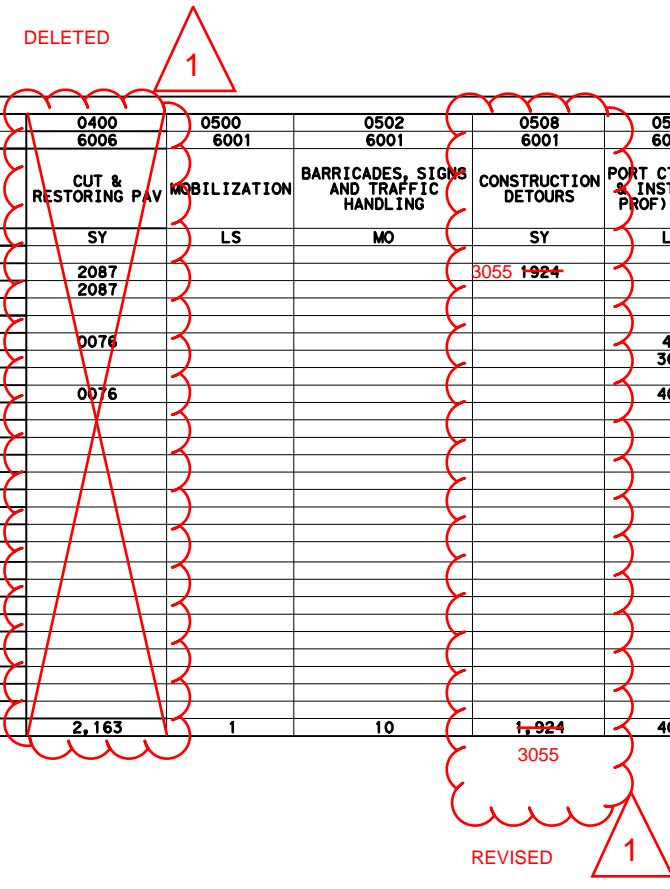

1	08/23/22	REVISED QUANTITY	KQ
REV. NO.	DATE	DESCRIPTION	BY
		11750 Katy Freeway, Suite 400 Houston, TX 77079 www.GaugeEngineering.com Texas PE Firm Reg. #F-20017	
NAVIGATION BLVD / JENSEN DR. & RUNNELS ST.			
SUMMARY OF TRAFFIC CONTROL PLAN QUANTITIES			
SHEET 1 OF 1			
DGN: MG	FED. RD. DIV. NO. 6	STATE TEXAS	PROJECT NO. STP 1902 (308) MM
CHK: DG			HIGHWAY NO. CS
DWG: MG	DIST. HOU	COUNTY HARRIS	CONT. NO. 0912
CHK: DG			SECT. NO. 72
			JOB NO. 386
			SHEET NO. 45

Pen Table: ROUNDABOUT - Copy.txt
 Plot Driver: P:\East End\1035-Nav-Roundabout\4-0-Production-Working\4-1-CAD\Resource\Plot Files\ROUNDABOUT.pltcfgr
 Plotted on: 8/23/2022 5:06:55 PM aalobal.d

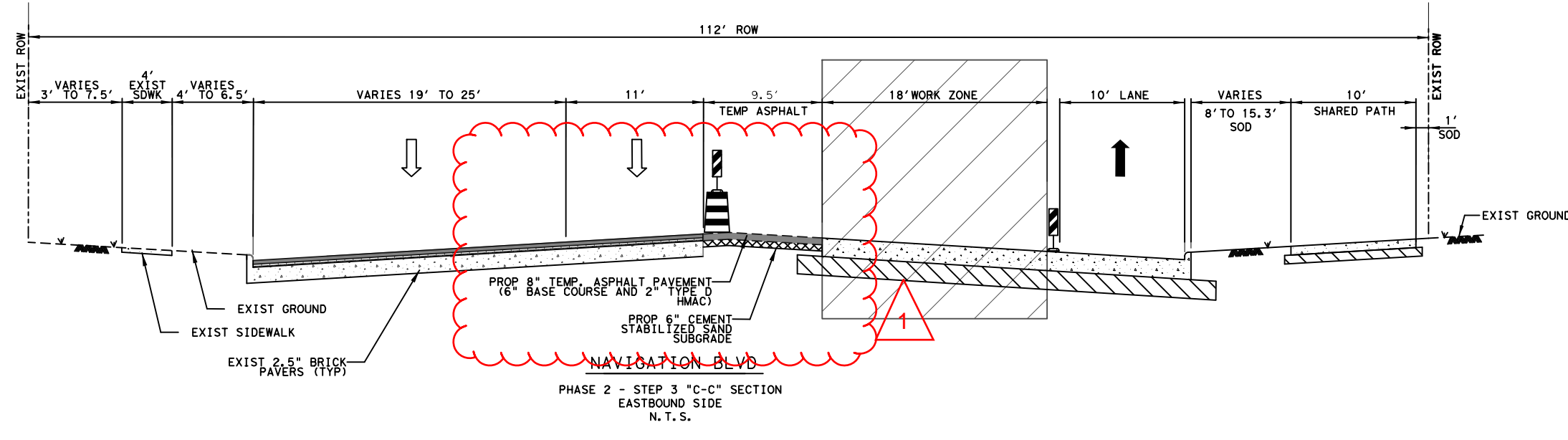
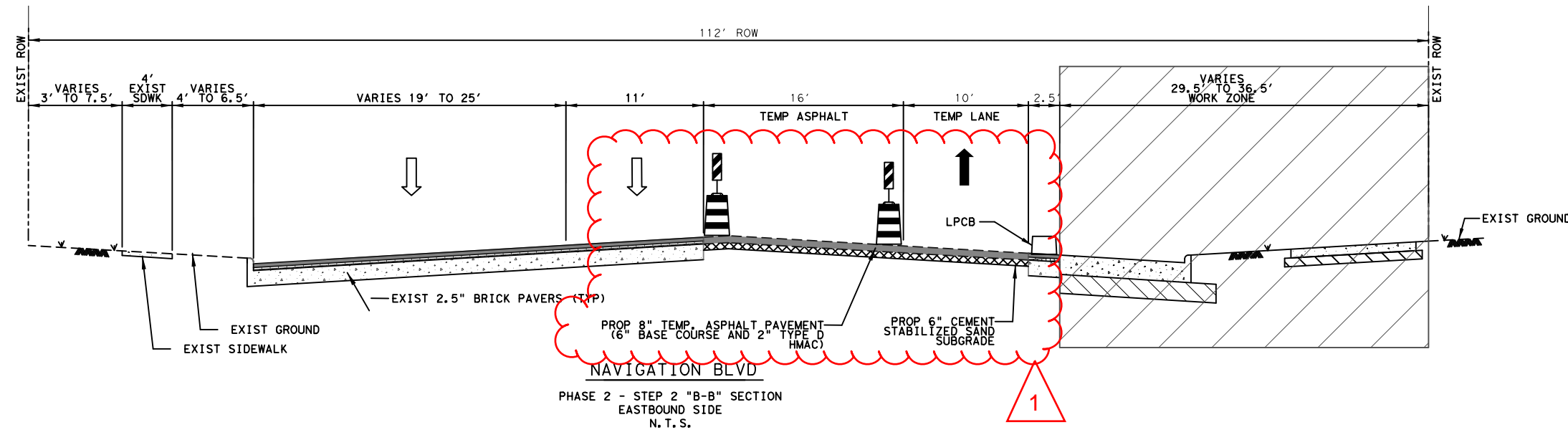
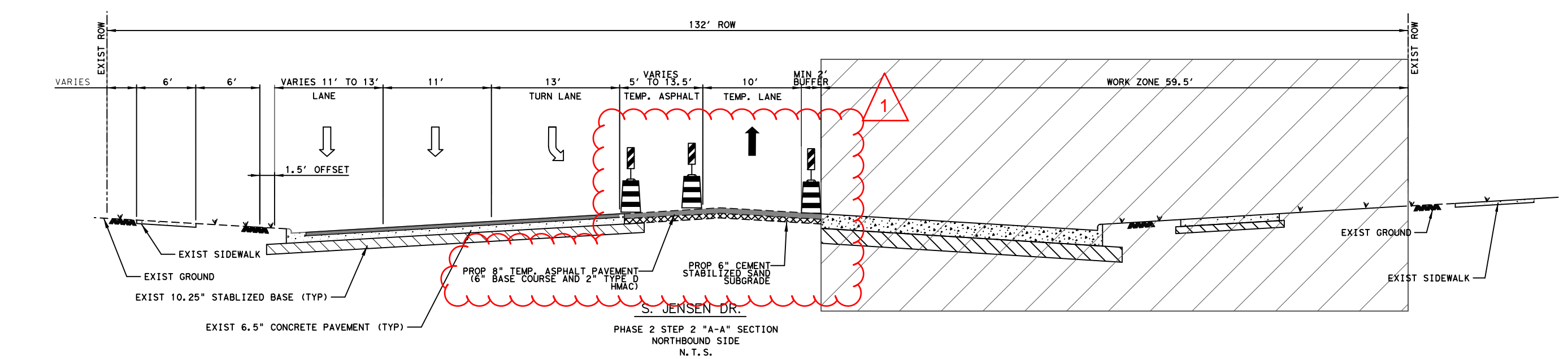

08/23/22

 KARAM M. QADDO
 125611
 LICENSED PROFESSIONAL ENGINEER
 Gauge Engineering, LLC
 Texas Registered Engineering Firm F-20017

1	08/23/22	SHEET REVISED	KQ
REV. NO.	DATE	DESCRIPTION	BY
 11750 Katy Freeway, Suite 400 Houston, TX 77079 www.GaugeEngineering.com Texas PE Firm Reg. #F-20017			
Texas Department of Transportation © 2022 NAVIGATION BLVD / JENSEN DR. & RUNNELS ST. PROPOSED TRAFFIC CONTROL TYPICAL SECTIONS PHASE 2			
SHEET 1 OF 1			
DGN: MG	FED. RD. DIV. NO.: 6	STATE: TEXAS	PROJECT NO.: STP 1902 (308) MM
CHK: DG			HIGHWAY NO.: CS
DWG: MG	DIST.: HOU	COUNTY: HARRIS	CONT. NO.: 0912
CHK: DG			SECT. NO.: 72
			JOB NO.: 386
			SHEET NO.: 60

Design Filename: P:\East End\1035-Nav-Roundabout\4-0-Production-Working\4-1-CAD\Traffic Control\PR-TYP*TCP*01.dgn

Pen Table: ROUNDABOUT - Copy.txt
 Plot Driver: P:\East\1035-Nav-Roundabout\4-0-Production-Working\4-1-CAD\Resource\Plot Files\ROUNDABOUT.pltcfgr
 Plotted on: 8/23/2022 5:07:25 PM aalobalidi

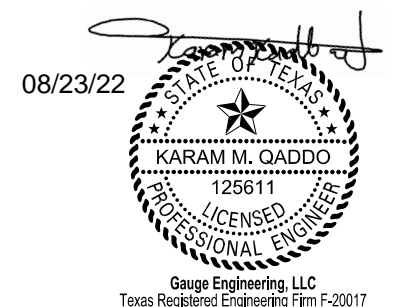
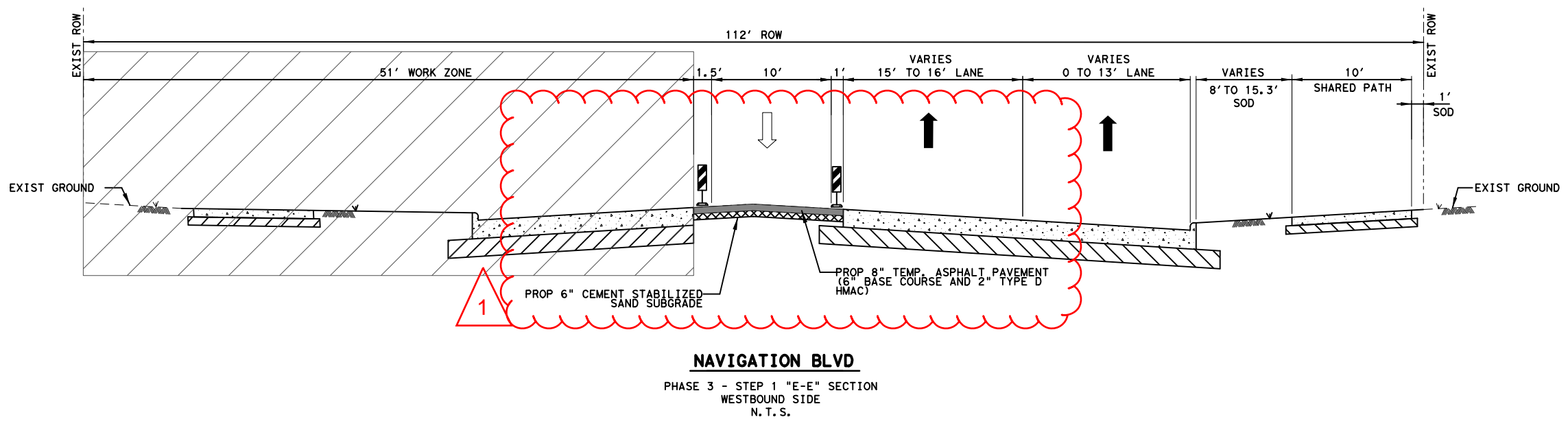
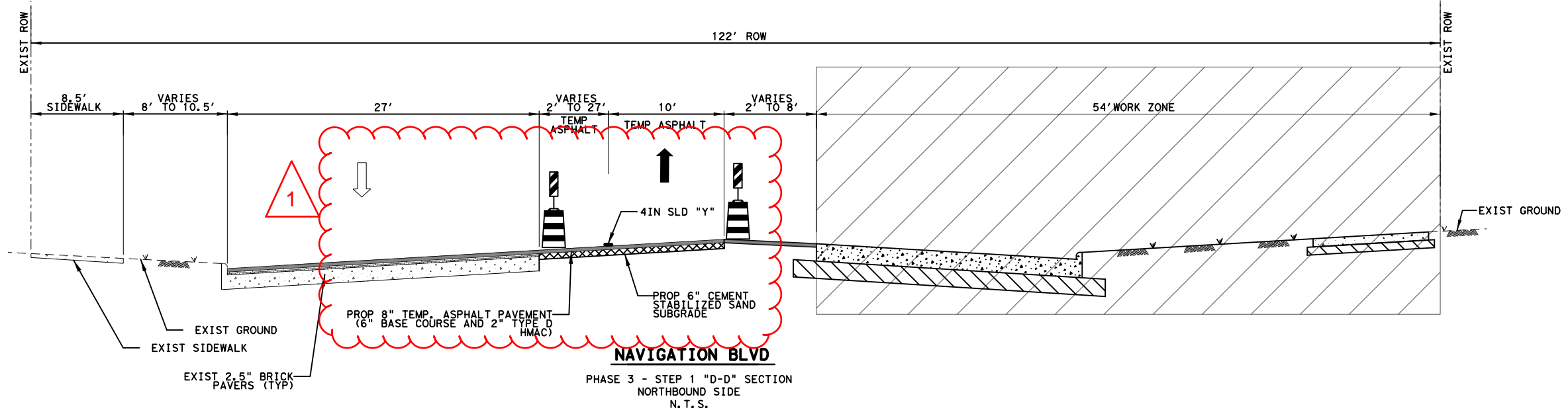

Gauge Engineering, LLC
Texas Registered Engineering Firm F-20017

1	08/23/22	SHEET REVISED	KQ
---	----------	---------------	----

REV. NO.	DATE	DESCRIPTION	BY
1	08/23/22	SHEET REVISED	KQ

Gauge
ENGINEERING

Texas Department of Transportation
© 2022
NAVIGATION BLVD / JENSEN DR.
& RUNNELS ST.

PROPOSED TRAFFIC CONTROL
TYPICAL SECTIONS
PHASE 3

SHEET 1 OF 1

DGN	MG	FED. RD. DIV. NO.	STATE	PROJECT NO.	HIGHWAY NO.		
CHK	DG	6	TEXAS	STP 1902 (308) MM	CS		
DWG	MG	DIST.	COUNTY	CONT. NO.	SECT. NO.	JOB NO.	SHEET NO.
CHK	DG	HOU	HARRIS	0912	72	386	62

Design File name: P:\East\1035-Nav-Roundabout\4-0-Production-Working\4-1-CAD\Traffic Control\PR-TYP*TCP*02.dgn

Pen Table: ROUNDABOUT - Copy.txt
 Plot Driver: P:\East End\1035-Nav-Roundabout\4-0-Production-Working\4-1-CAD\Resource\Plot Files\ROUNDABOUT.pltcfgr
 Plotted on: 8/23/2022 5:07:58 PM aalobalidi

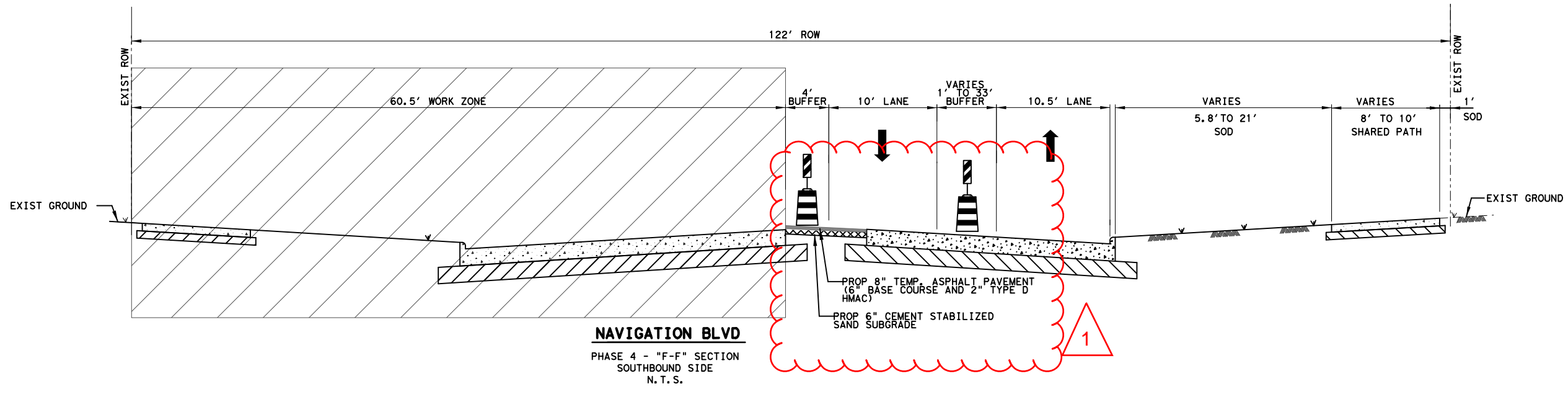

NAVIGATION BLVD
 PHASE 4 - "F-F" SECTION
 SOUTHBOUND SIDE
 N. T. S.

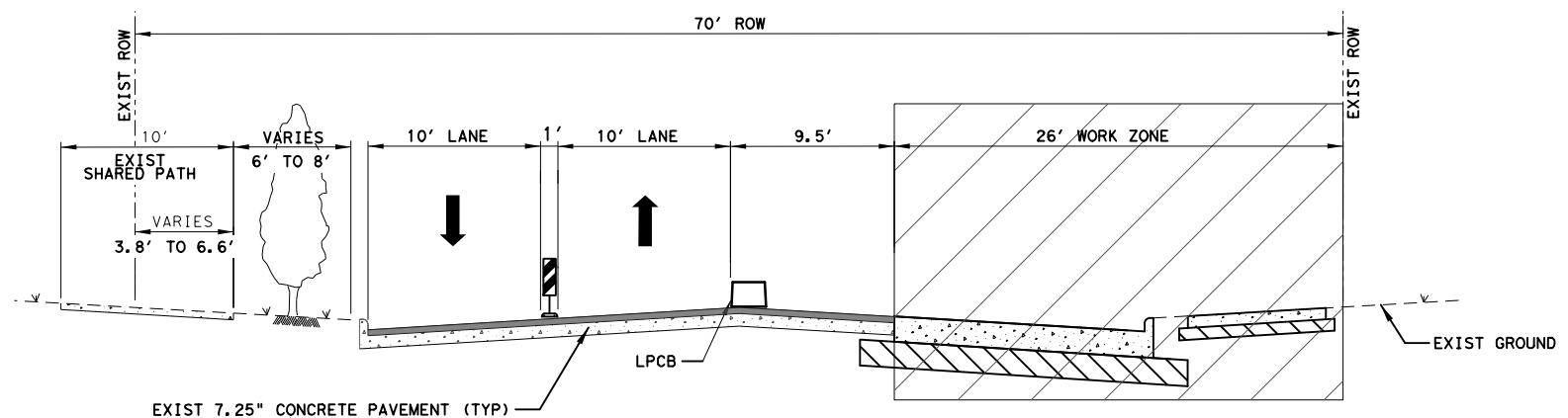

RUNNELS ST.
 PHASE 4 - "J-J" SECTION
 EASTBOUND SIDE
 N. T. S.

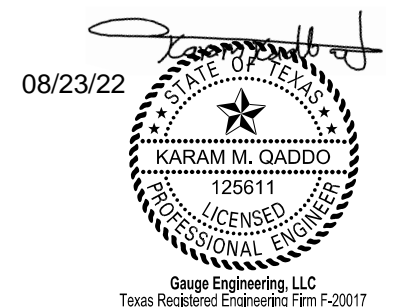

Gauge Engineering, LLC
 Texas Registered Engineering Firm F-20017

1	08/23/22	SHEET REVISED	KQ
---	----------	---------------	----

REV. NO.	DATE	DESCRIPTION	BY
1	08/23/22	SHEET REVISED	KQ

Gauge
 ENGINEERING
 11750 Katy Freeway, Suite 400
 Houston, TX 77079
 www.GaugeEngineering.com
 Texas PE Firm Reg. #F-20017

Texas Department of Transportation
 © 2022

NAVIGATION BLVD / JENSEN DR.
 & RUNNELS ST.
 PROPOSED TRAFFIC CONTROL
 TYPICAL SECTIONS
 PHASE 4

SHEET 1 OF 1

DGN	MG	FED. RD. DIV. NO.	STATE	PROJECT NO.	HIGHWAY NO.		
CHK	DG	6	TEXAS	STP 1902 (308) MM	CS		
DWG	MG	DIST.	COUNTY	CONT. NO.	SECT. NO.	JOB NO.	SHEET NO.
CHK	DG	HOU	HARRIS	0912	72	386	66

Design File Name: P:\East End\1035-Nav-Roundabout\4-0-Production-Working\4-1-CAD\Traffic Control\PR-TYP*TCP*03.dgn

Pen Table: ROUNDABOUT - Copy.txt
 Plot Driver: P:\East End\1035-Nav-Roundabout\4-0-Production-Working\4-1-CAD\Resource\Plot Files\ROUNDABOUT.plt
 Plotted on: 8/23/2022 5:08:24 PM
 aalobal.d

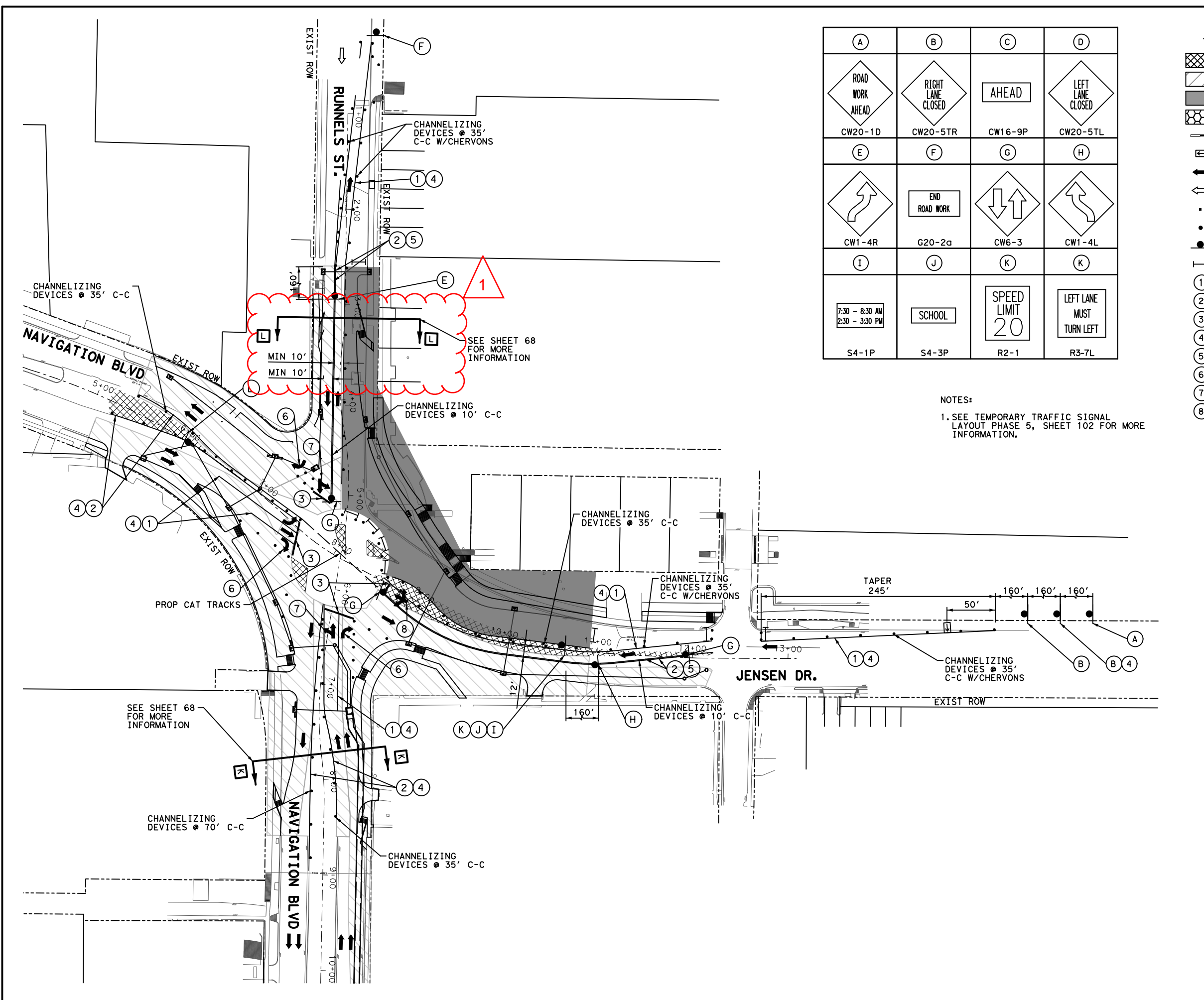

(A)	(B)	(C)	(D)
ROAD WORK AHEAD CW20-1D	RIGHT LANE CLOSED CW20-5TR	AHEAD CW16-9P	LEFT LANE CLOSED CW20-5TL
(E)	(F)	(G)	(H)
CW1-4R	G20-2a END ROAD WORK	CW6-3	CW1-4L
(I)	(J)	(K)	(K)
S4-1P 7:30 - 8:30 AM 2:30 - 3:30 PM	S4-3P SCHOOL	R2-1 SPEED LIMIT 20	R3-7L LEFT LANE MUST TURN LEFT

NOTES:
 1. SEE TEMPORARY TRAFFIC SIGNAL LAYOUT PHASE 5, SHEET 102 FOR MORE INFORMATION.

- LEGEND**
- PHASE 1 TEMP ASPHALT
 - PREVIOUS PHASES
 - PHASE 5 WORK ZONE
 - FASTTRACK PAVEMENT
 - TY I WITH TY II END TREATMENT LPCB
 - FLASHING ARROW
 - DIRECTION OF PROPOSED TRAFFIC
 - DIRECTION OF EXISTING TRAFFIC
 - VERTICAL PANEL
 - DRUM
 - SIGNS
 - TYPE III BARRICADE W/ROAD CLOSED SIGN
 - WRK ZN PAV MRK (REMOV) (TRAF BTN) TYP W
 - WRK ZN PAV MRK (REMOV) (TRAF BTN) TYP Y
 - WRK ZN PAV MRK (REMOV) 24" W SLD
 - WRK ZN PAV MRK (REMOV) (REFL) TY I-C
 - WRK ZN PAV MRK (REMOV) (REFL) TY II-A-A
 - WRK ZN PAV MRK (REMOV) ARROW
 - WRK ZN PAV MRK (REMOV) DBL ARROW
 - WRK ZN PAV MRK (REMOV) TRIPLE ARROW

0' 100' 200'
 (IN FEET)
 SCALE: PLAN 1"=100'

08/23/22

Gauge Engineering, LLC
 Texas Registered Engineering Firm F-20017

1	08/23/22	SHEET REVISED	KQ				
REV. NO.	DATE	DESCRIPTION	BY				
11750 Katy Freeway, Suite 400 Houston, TX 77079 www.GaugeEngineering.com Texas PE Firm Reg. #F-20017							
NAVIGATION BLVD / JENSEN DR. & RUNNELS ST. TRAFFIC CONTROL PLAN PHASE 5							
SHEET 1 OF 1							
DGN	MG	FED. RD. DIV. NO.	STATE	PROJECT NO.	HIGHWAY NO.		
CHK	DG	6	TEXAS	STP 1902 (308) MM	CS		
DWG	MG	DIST.	COUNTY	CONT. NO.	SECT. NO.	JOB NO.	SHEET NO.
CHK	DG	HOU	HARRIS	0912	72	386	67

Design File Name: P:\East End\1035-Nav-Roundabout\4-0-Production-Working\4-1-CAD\Traffic Control\PR*TCP*PH5.dgn