

STATE	FEDERAL AID PROJECT NO.	SHEET NO.
TEXAS	001	1
COUNTY	PROJECT NO.	
DUVAL	6455-79-001	

SHEET NO.	INDEX OF SHEETS DESCRIPTION
-----------	-----------------------------

GENERAL

- 1 TITLE SHEET
- 2 GENERAL NOTES
- 3 ESTIMATE AND QUANTITY SHEET
- 4 LOCATION MAP

STATE OF TEXAS TEXAS DEPARTMENT OF TRANSPORTATION

PLANS OF PROPOSED MATERIAL MAINTENANCE CONTRACT

PROJECT NO. MMC 6455-79-001
PROJECT LIMITS : VARIOUS
COUNTY : DUVAL COUNTY
HIGHWAY : VARIOUS
MMC# 6455-79-001

FINAL PLANS	
Letting Date :	_____
Work Began :	_____
Date Accepted :	_____
Contractor :	_____
Total Cost :	_____

FOR PURCHASE AND DELIVERY OF MATERIALS ONLY: LIMESTONE ROCK ASPHALT

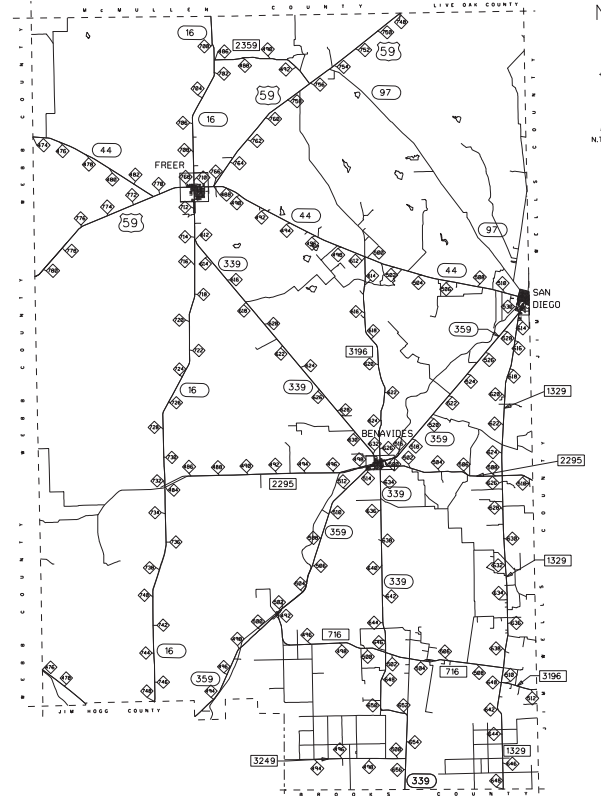

TEXAS DEPARTMENT OF TRANSPORTATION

SUBMITTED FOR LETTING: 8/28/2023

APPROVED FOR LETTING: 8/28/2023

DocuSigned by:

Vanessa Rosales-Herrera

VANESSA ROSALES-HERRERA, P.E.
DIRECTOR OF MAINTENANCE

SPECIFICATIONS ADOPTED BY THE TEXAS DEPARTMENT OF TRANSPORTATION, JUNE 1, 2014 AND SPECIFICATION ITEMS LISTED AND DATED AS FOLLOWS, SHALL GOVERN ON THIS PROJECT.

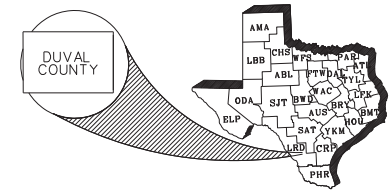

8/24/2023 oserno3 T:\LRD05T\MNT\FY 2024\MNT Contract (FY24)\MMC\LR for Duval Co\Microstation\001_Title_Sheet.dgn

Project: MMC 6455-79-001**Sheet 2****County:** Duval**Highway:** Various

Individual work order charge days shall run concurrently with contract time charges.

Liquidated damages shall be charged each day for failure to deliver the material within the specified timeframe. For this contract, the vendor will have a maximum of 30 calendar days from the date of the work order to deliver the material.

Various bid items and their associated quantities have been provided within this Contract to establish bid prices for the proposed work. Actual work performed as directed will be paid utilizing these prices with no further compensation made regardless of the final quantities.

ITEM 8040: LIMESTONE ROCK ASPHALT (MATERIALS ONLY)

This is a contract for supplying Limestone Rock Asphalt material on an as needed basis. Refer to plan sheet page 4 Location Map for the proposed initial site locations, this may include other various locations within Duval County.

For this contract the roadway maintenance supervisor in charge is:

Duval County

Servando Casas Jr.

5143 S. SH 16

Freer, TX 78357

361-394-6771

A 24-hour notice is required prior to delivery of the material.

The maintenance supervisor will make the arrangement for the materials to be delivered. An email will be sent by the TxDOT Maintenance office to the vendor's point of contact to verify the date and time of the order.

The contractor is responsible for furnishing and delivering the Limestone Rock Asphalt to the County Maintenance yard or locations indicated in the above table. The delivery hours will be Monday through Friday for 7:00AM to 5:00PM. The maintenance section will stockpile the material.

GENERAL NOTES:**General:**Plans may be obtained from one of the plan companies listed in the "Special Notice to Contractors", or viewed at Texas Department of Transportation's (TxDOT's) Internet site at <https://www.txdot.gov/business/plans-online-bid-lettings.html>.

Contractor questions on this project are to be addressed to the following individual(s):

Vanessa Rosales-Herrera Vanessa.Rosales@txdot.gov

Questions may be submitted via the Letting Pre-bid Q&A web page. This webpage can be accessed from the Notice to Contractors dashboard located at the following Address:

<https://tableau.txdot.gov/views/ProjectInformationDashboard/NoticetoContractors>

All contractor questions will be reviewed by the Engineer. All questions and any corresponding responses that are generated will be posted through the same Letting Pre-Bid Q&A web page.

The Letting Pre-Bid Q&A webpage for each project can be accessed by using the dashboard to navigate to the project you are interested in by scrolling or filtering the dashboard using the controls on the left. Hover over the blue hyperlink for the project you want to view the Q&A for and click on the link in the window that pops up.

Project Description – This project shall consist of the purchase and delivery of Limestone Rock Asphalt, (Material Only), to TxDOT maintenance yards or specified locations within the Laredo District. Request for material will be made through independent work orders.**ITEM 10.4: SCOPE OF WORK**

In Accordance with Article 10.4.3.1, this contract may be extended twice if mutually agreed.

ITEM 10.8: PROSECUTION AND PROGRESS

There are 182 calendar days on this contract. Calendar days will be charged in accordance with Article 10.8.2., "Contract Term".

Material requests shall be issued by work order. Each work order shall specify items, quantity, and location for material to be delivered.



Estimate & Quantity Sheet

CONTROLLING PROJECT ID 6455-79-001

DISTRICT Laredo
HIGHWAY SH0044

COUNTY Duval

CONTROL SECTION JOB		6455-79-001		TOTAL EST.	TOTAL FINAL
PROJECT ID		A00203903			
COUNTY		Duval			
HIGHWAY		SH0044			
ALT	BID CODE	DESCRIPTION	UNIT	EST.	FINAL
	8040-6093	LRA (TY II GR CS) (DEL) (ST1)	TON	2,500.000	
				2,500.000	

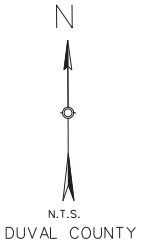
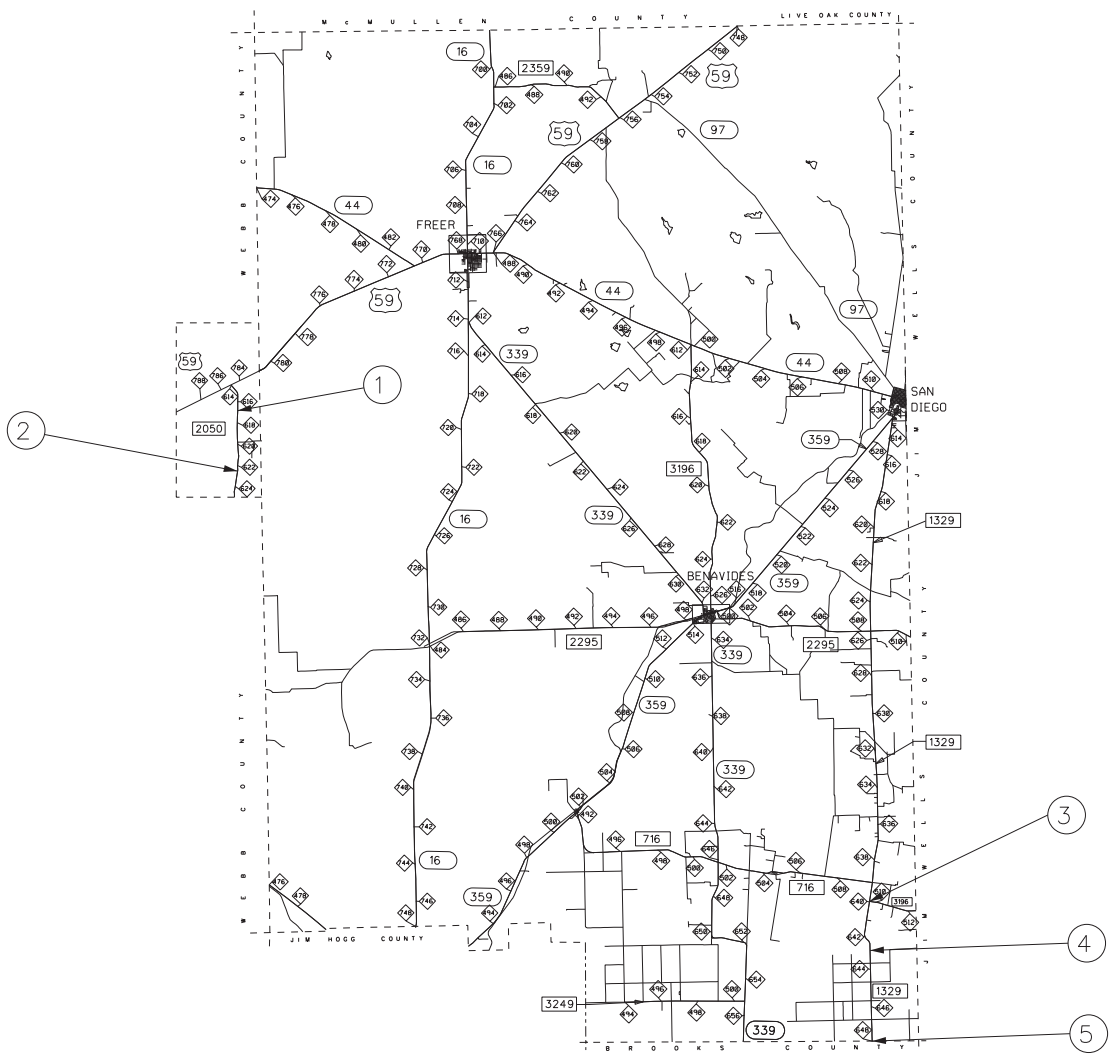

* COUNTY	ADDRESS/HIGHWAY	GPS COORDINATES		ITEM 8040-6093 LRA (TY II)(GR-CS) (DELIVERY)(SITE 1)
		LAT	LONG	
1 DUVAL	FM 250 2.8 MILES SOUTH OF US 59 (BRUNI)	27.735847	-98.836408	*
2 DUVAL	FM 2050 8.2 MILES SOUTH OF US 59 (BRUNI)	27.656200	-98.837455	*
3 DUVAL	FM 1329 INTERSECTION OF FM1329 AND FM2295 SOUTH (PREMONT)	27.372279	-98.272912	*
4 DUVAL	FM 1329 3.0 MILES SOUTH OF FM1329 AND FM716 INTERSECTION (PREMONT)	27.329221	-98.273264	*
5 DUVAL	FM 1329 INTERSECTION OF FM1329 AND SH285 (FALFURRIAS)	27.262988	-98.272635	*
6 DUVAL	LOCATIONS WITHIN DUVAL COUNTY	-	-	*
TOTAL				2,500.00

* QUANTITIES TO BE DISTRIBUTED AS REQUIRED BY THE MAINTENANCE SUPERVISOR.

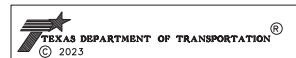

DUVAL COUNTY
LOCATION MAP

DN: A.S.	DN: A.S.	STATE	SHEET NUMBER	SHEET
DR: V.R.	DR: V.R.	TEXAS		NO.
22	DUVAL	6455	79 001	VARIOUS
				4