

|                   |                         |                 |             |
|-------------------|-------------------------|-----------------|-------------|
| FED. RD. DIV. NO. | FEDERAL AID PROJECT NO. |                 | SHEET NO.   |
| 6                 | MMC: 6397-10-001        |                 | 1           |
| STATE             | STATE DIST. NO.         | COUNTY          |             |
| TEXAS             | 22                      | VAL VERDE, ETC. |             |
| CONT.             | SECT.                   | JOB             | HIGHWAY NO. |
| 6397              | 10                      | 001             | VARIOUS     |

SHEET INDEX OF SHEETS  
NO. DESCRIPTION

- GENERAL**
- 1 TITLE SHEET
  - 2 GENERAL NOTES (SHEET 1 OF 1)
  - 3 ESTIMATE & QUANTITY SHEET
  - 4 LOCATION MAP REFERENCE

# STATE OF TEXAS TEXAS DEPARTMENT OF TRANSPORTATION

## PLANS OF PROPOSED HIGHWAY MATERIALS MAINTENANCE CONTRACT

PROJECT NO. MMC:6397-10-001

PROJECT LENGTH : VARIOUS

PROJECT LIMITS : VARIOUS

COUNTY : VAL VERDE, ETC.

HIGHWAY : VARIOUS

FOR PURCHASE AND DELIVERY OF MATERIALS ONLY: EMULSION FOR VAL VERDE,  
ZAVALA, AND LA SALLE

| FINAL PLANS     |       |
|-----------------|-------|
| Letting Date :  | _____ |
| Work Began :    | _____ |
| Date Accepted : | _____ |
| Contractor :    | _____ |
| Total Cost :    | _____ |

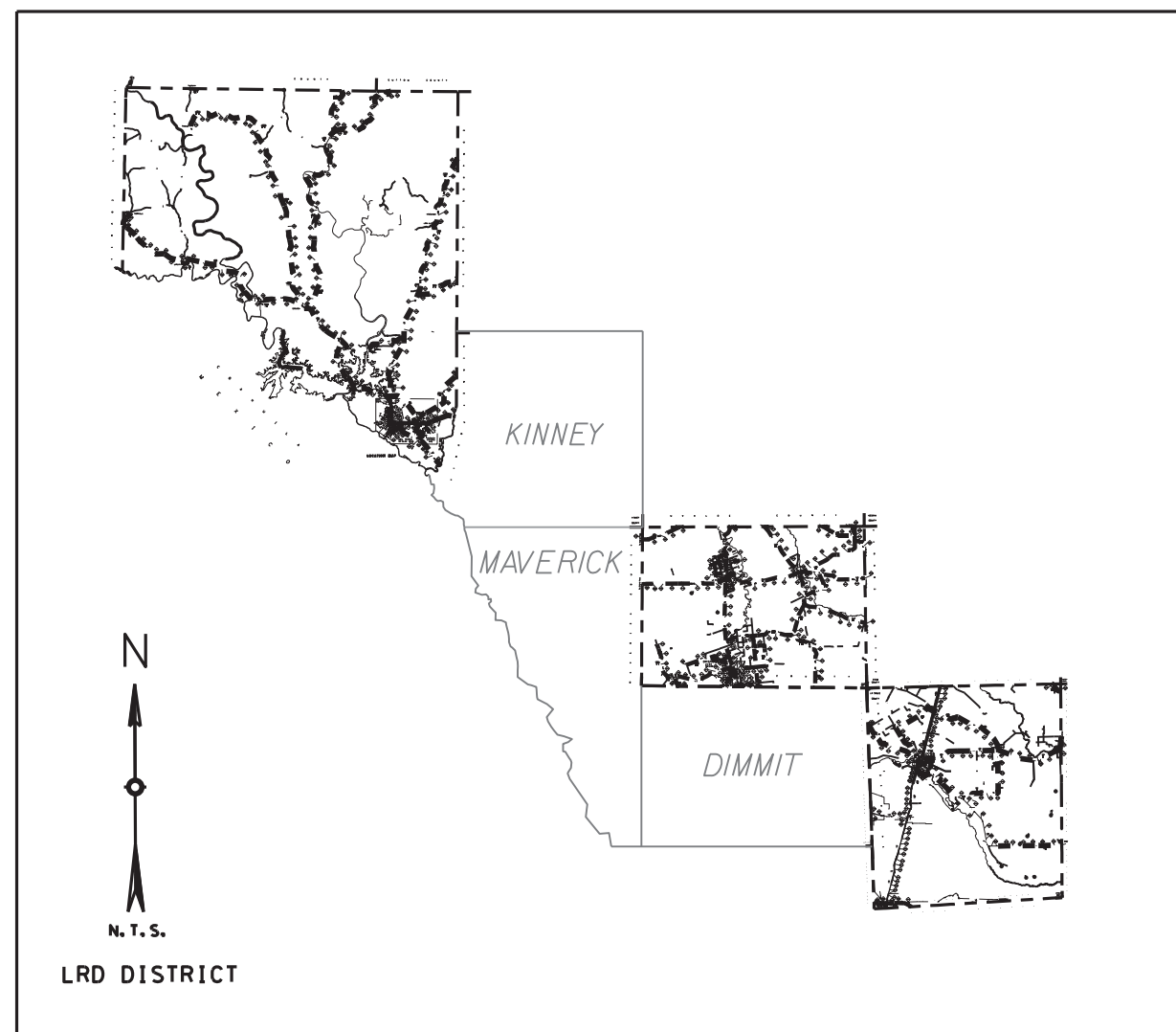

SPECIFICATIONS ADOPTED BY THE TEXAS DEPARTMENT OF TRANSPORTATION, NOVEMBER 1, 2014 AND SPECIFICATION ITEMS LISTED AND DATED AS FOLLOWS, SHALL GOVERN ON THIS PROJECT.



SUBMITTED FOR LETTING: 1/27/2022 2022      APPROVED FOR LETTING: 1/27/2022 2022

*Luis Castillo Jr.*      *Cynthia M. Saldaña*

LUIS (      CYNTHIA  
TRANSPORTATION ENGINEER      DIRECTOR OF MAINTENANCE

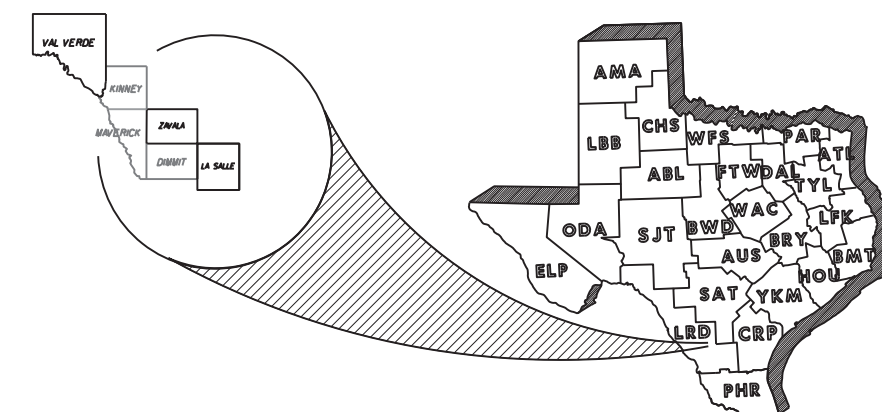



# Estimate & Quantity Sheet

CONTROLLING PROJECT ID 6397-10-001

DISTRICT Laredo  
HIGHWAY PR0067

COUNTY Val Verde

| CONTROL SECTION JOB |           |                              |      | 6397-10-001 |       | TOTAL EST. | TOTAL FINAL |
|---------------------|-----------|------------------------------|------|-------------|-------|------------|-------------|
| PROJECT ID          |           |                              |      | A00185118   |       |            |             |
| COUNTY              |           |                              |      | Val Verde   |       |            |             |
| HIGHWAY             |           |                              |      | PR0067      |       |            |             |
| ALT                 | BID CODE  | DESCRIPTION                  | UNIT | EST.        | FINAL |            |             |
|                     | 8010-6162 | EMULSION (HFRS-2P)(DELIVERY) | GAL  | 22,000.000  |       | 22,000.000 |             |
|                     | 8010-6224 | EMULS (HFRS-2P)(DEL)(SITE 1) | GAL  | 1,200.000   |       | 1,200.000  |             |
|                     | 8010-6225 | EMULS (HFRS-2P)(DEL)(SITE 2) | GAL  | 49,500.000  |       | 49,500.000 |             |

1/26/2022 SPACHICA T:\LRDDSTMT\FY 2022\MNT Contracts\Material Maintenance Contracts\Emulsion\6397-10-001\Microsoft\General Notes.dgn

**GENERAL NOTES:**

**General:**

Plans may be obtained from one of the plan companies listed in the "Special Notice to Contractors", or viewed at Texas Department of Transportation's (TxDOT's) Internet site at <http://www.do.state.tx.us/business/plansonline.htm>. Contractor questions on this project are to be addressed to the following individual(s):

Sergio Reyna [sergio.reyna@txdot.gov](mailto:sergio.reyna@txdot.gov)

Contractor questions will be accepted through email by the above individuals.

All contractor questions will be reviewed by the Engineer. Once a response is developed, it will be posted to TxDOT's Public FTP at the following Address:

[http://ftp.dot.state.tx.us/pub/txdot-info/Pre-Letting\\*Responses/](http://ftp.dot.state.tx.us/pub/txdot-info/Pre-Letting*Responses/)

All questions submitted that generate a response will be posted through this site. The site is organized by District, Project Type (Construction or Maintenance), Letting Date, and CCSJ/Project Name.

Questions concerning the specifications, work requirements, etc. of this contract should be directed to Luis Castillo Jr, P.E., Transportation Engineer at [luis.castillo@txdot.gov](mailto:luis.castillo@txdot.gov).

Contract Prosecution: Each contract awarded by the Department stands on its own and has such, is separate from other contracts. A Contractor awarded multiple contracts must be capable and sufficiently staffed to concurrently processes and/or execute all contracts at the same time.

**Project Description** - This project shall consist of the purchase and delivery of Emulsion, (Material Only), to TxDOT maintenance yards or specified locations within the Laredo District. Request for material will be made through independent work orders.

**ITEM 4: SCOPE OF WORK**

This contract may be extended per special provision 004-004

**ITEM 8: PROSECUTION AND PROGRESS**

Material requests shall be issued by work order. Each work order shall specify items, quantity, and location for material to be delivered.

Contract time charges shall begin upon issuance of "Authorization to Begin Work" letter.

One hundred and twenty (120) working days have been designated for this contract. Working days shall be computed and charged in accordance with Article 8.3.1.5 "Calendar Day."

Individual work order charge days shall run concurrently with contract time charges.

In accordance with Article 8.6 "Failure to Complete Work on Time," liquidated damages shall be charged each day for failure to deliver the material within the specified timeframe. For this contract, the vendor will have a maximum of 30 calendar days from the date of the work order to deliver the material.

The amount assessed per day for liquidated damages shall be as specified in accordance with Special Provision 000-658.

Various bid items and their associated quantities have been provided within this Contract to establish bid prices for the proposed work. Actual work performed as directed will be paid utilizing these prices with no further compensation made regardless of the final quantities.

**ITEM 8010: ASPHALTS, OILS, AND EMULSION (MATERIALS ONLY)**

This is a contract for supplying Emulsion material on an as needed basis. Minimum delivery quantity shall be 5,000 gallons. Transport truck shall be equipped with transfer pump and required hoses to transfer material from transport to TxDOT storage tanks. Details about the hose will be indicated in work order.

For this contract the roadway maintenance supervisor in charge is:

|                   |                   |                    |
|-------------------|-------------------|--------------------|
| La Salle County   | Val Verde County  | Zavala County      |
| Jimmy Lozano      | Francis Schell    | Arnulfo Longoria   |
| 900 East FM 468   | 319 E. Gibbs      | 544 West US 57,    |
| Cotulla, TX 78014 | Del Rio, TX 78840 | PO Box 280         |
| 830-879-2428      | 830-775-2440      | La Pryor, TX 78872 |
|                   |                   | 830-365-4211       |

A 24-hour notice is required prior to delivery of the material.

The maintenance supervisor will make the arrangement for the materials to be delivered. An email will be sent by the TxDOT Maintenance office to the vendor's point of contact to verify the date and time of the order.

The contractor is responsible for furnishing and delivering the Emulsion to the County Maintenance yard or locations indicated in the table on plan sheet page 4. The delivery hours will be Monday through Friday for 7:00AM to 5:00PM..

If agreed upon in writing by both parties to the contract, the contract may be extended as per special provision 004-004 for an additional period of time not to exceed the original contract time period. The extended contract may be for additional quantities up to the original bid quantities plus and quantities added by any approved change orders. The extensions shall meet the terms and conditions of the original contract plus any approved terms and conditions made by previously approved change orders.



GENERAL NOTES

|                   |                 |           |         |         |              |             |  |           |
|-------------------|-----------------|-----------|---------|---------|--------------|-------------|--|-----------|
| DN:               | SP              | DW:       | SP      | STATE   | SHEET NUMBER |             |  | SHEET NO. |
| CK:               | LC              | CK:       | LC      | TX      |              |             |  |           |
| FED. RD. DIV. NO. | STATE DIST. NO. | COUNTY    | CONTROL | SECTION | JOB          | HIGHWAY NO. |  |           |
| 6                 | 22              | VAL VERDE | 6397    | 10      | 001          | VARIOUS     |  |           |

1/26/2022 SPACHICA T:\LRDDSTMT\FY 2022\MNT Contracts\Material Maintenance Contracts\Emulsion\6397-10-001\Microstation\Location Maps Reference.dgn



N. T. S.  
LA SALLE COUNTY

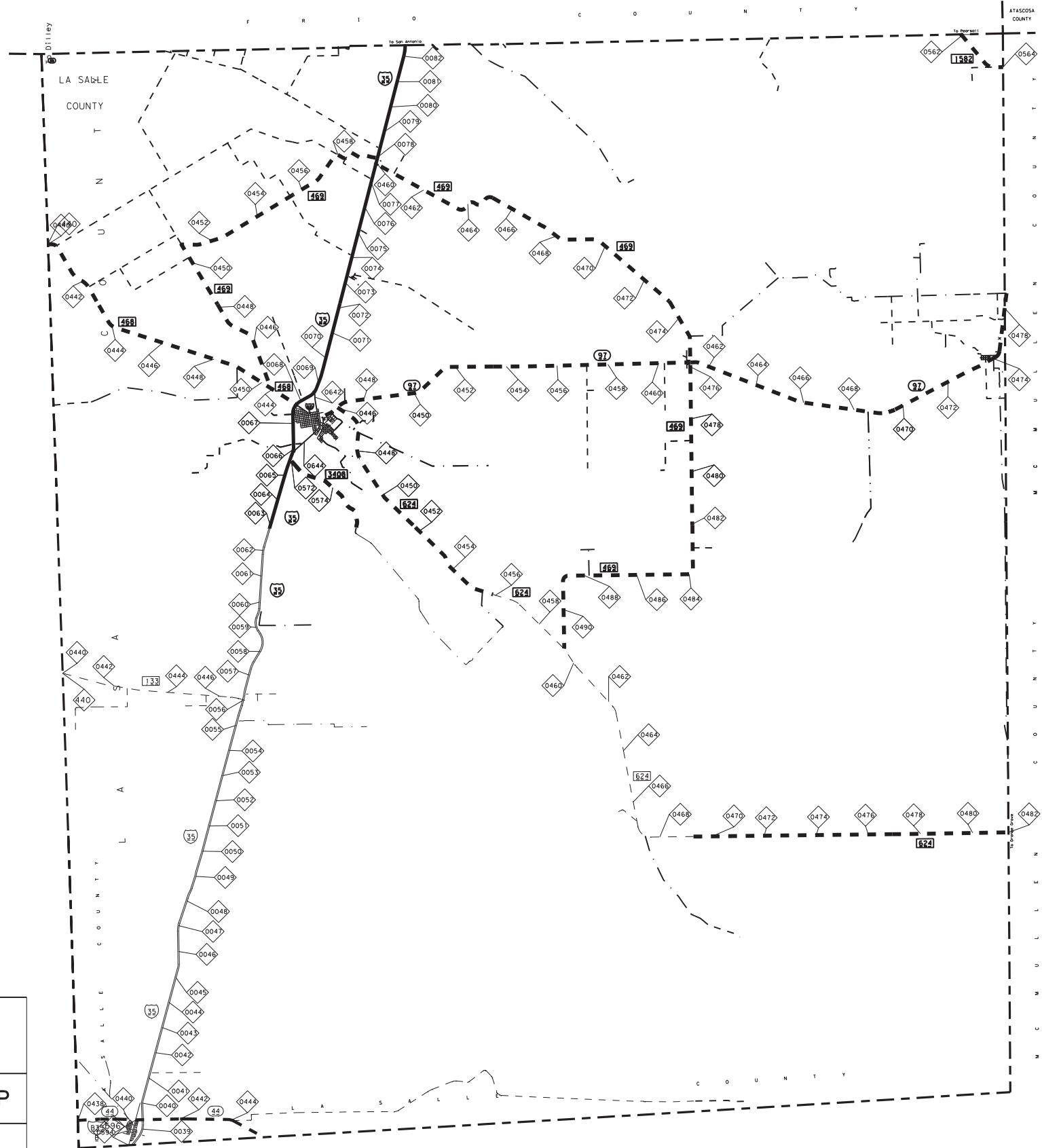

| #            | COUNTY   | ADDRESS/HIGHWAY                             | ITEM<br>8010<br>6225<br>HFRS-2P |
|--------------|----------|---|---------------------------------|
| 1            | La Salle | 900 FM 468                                  | *                               |
| 2            | La Salle | Various locations<br>within La Salle county | *                               |
| <b>Total</b> |          |   | 49500                           |

Note: Quantities to be distributed as required by the maintenance supervisor.



LA SALLE MAP  
REFERENCE

|                   |                 |           |         |         |              |             |  |           |
|-------------------|-----------------|-----------|---------|---------|--------------|-------------|--|-----------|
| DN:               | SP              | DW:       | SP      | STATE   | SHEET NUMBER |             |  | SHEET NO. |
| CK:               | LC              | CK:       | LC      | TX      | SHEET 1 OF 3 |             |  |           |
| FED. RD. DIV. NO. | STATE DIST. NO. | COUNTY    | CONTROL | SECTION | JOB          | HIGHWAY NO. |  |           |
| 6                 | 22              | VAL VERDE | 6397    | 10      | 001          | VARIOUS     |  |           |

1/26/2022 SPACHICA T:\LRDDSTMT\FY 2022\MNT Contracts\Material Maintenance Contracts\Emulsion\6397-10-001\Microstation\Location Maps Reference.dgn

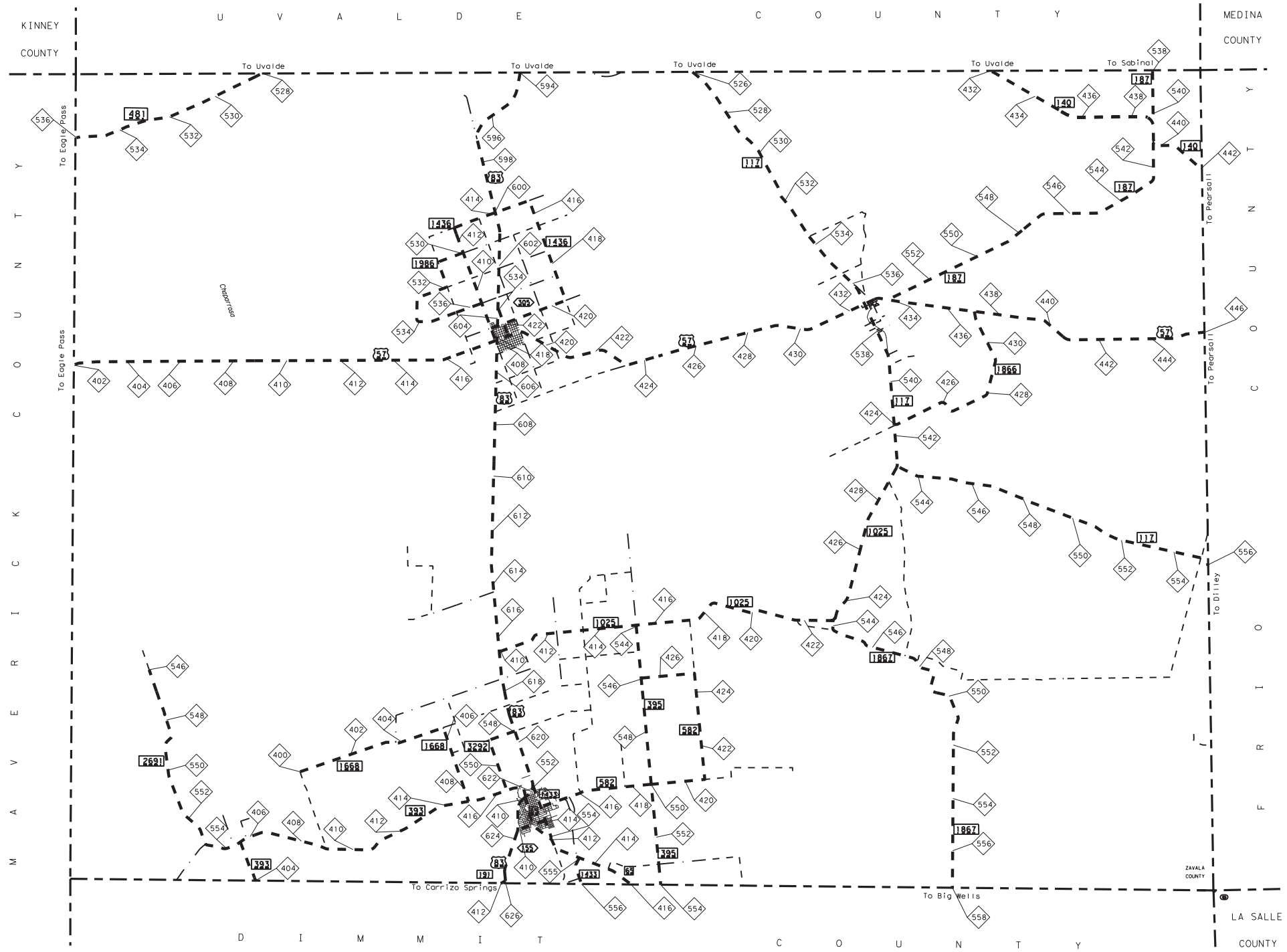
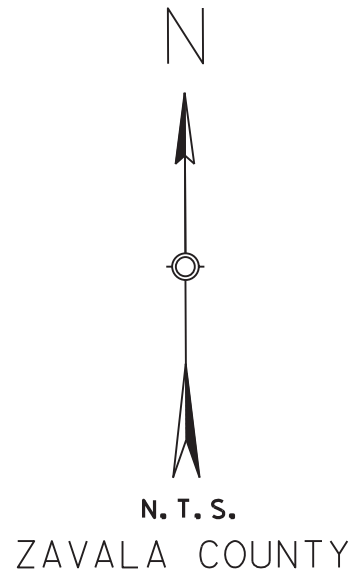

| #            | COUNTY | ADDRESS/HIGHWAY                           | ITEM<br>8010<br>6224<br>HFRS-2P |
|--------------|--------|---|---------------------------------|
| 1            | Zavala | 544 W US57                                | *                               |
| 2            | Zavala | Various locations<br>within Zavala county | *                               |
| <b>Total</b> |        |   | 1200                            |

Note: Quantities to be distributed as required by the maintenance supervisor.



ZAVALA MAP REFERENCE

|                   |                 |           |         |         |              |             |  |           |
|-------------------|-----------------|-----------|---------|---------|--------------|-------------|--|-----------|
| DN:               | SP              | DW:       | SP      | STATE   | SHEET NUMBER |             |  | SHEET NO. |
| CK:               | LC              | CK:       | LC      | TX      | SHEET 2 OF 3 |             |  |           |
| FED. RD. DIV. NO. | STATE DIST. NO. | COUNTY    | CONTROL | SECTION | JOB          | HIGHWAY NO. |  |           |
| 6                 | 22              | VAL VERDE | 6397    | 10      | 001          | VARIOUS     |  |           |

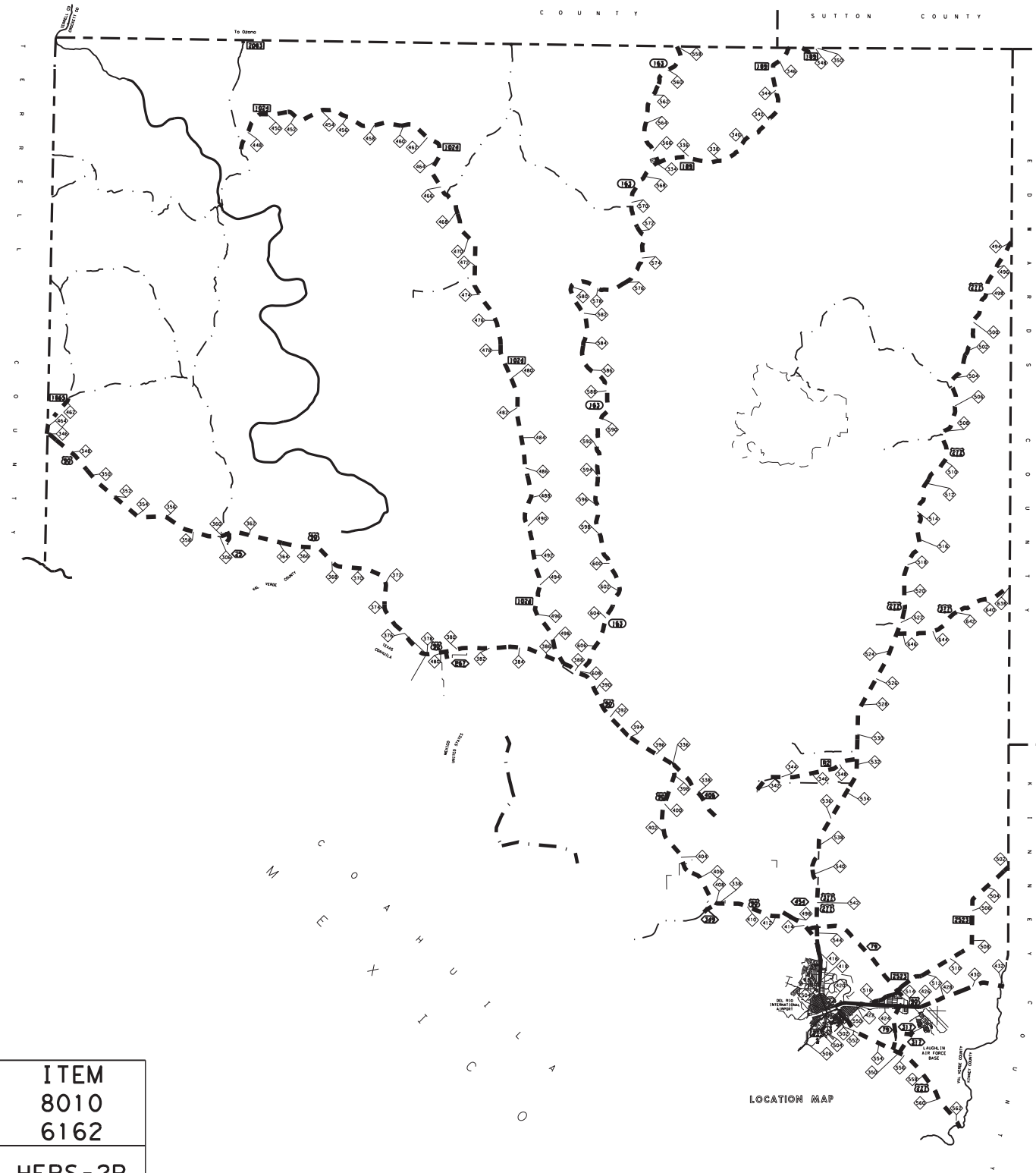
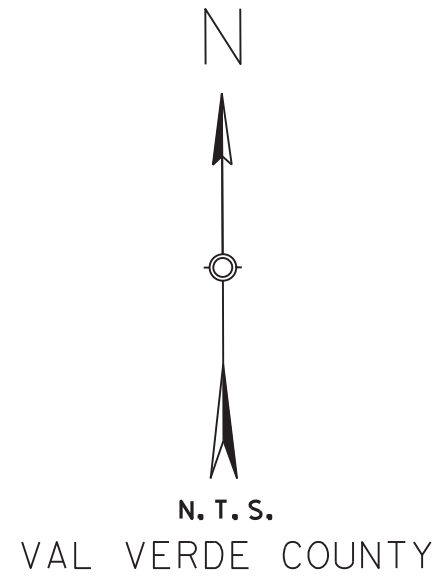

| #            | COUNTY    | ADDRESS/HIGHWAY                              | ITEM<br>8010<br>6162<br>HFRS-2P |
|--------------|-----------|--|---------------------------------|
| 1            | Val Verde | 319 E. Gibbs                                 | *                               |
| 2            | Val Verde | Various locations<br>within Val Verde county | *                               |
| <b>Total</b> |           |  | 22000                           |

Note: Quantities to be distributed as required by the maintenance supervisor.



VAL VERDE MAP REFERENCE

|                   |                 |           |         |         |              |             |  |           |
|-------------------|-----------------|-----------|---------|---------|--------------|-------------|--|-----------|
| DN:               | SP              | DW:       | SP      | STATE   | SHEET NUMBER |             |  | SHEET NO. |
| CK:               | LC              | CK:       | LC      | TX      | SHEET 3 OF 3 |             |  |           |
| FED. RD. DIV. NO. | STATE DIST. NO. | COUNTY    | CONTROL | SECTION | JOB          | HIGHWAY NO. |  |           |
| 6                 | 22              | VAL VERDE | 6397    | 10      | 001          | VARIOUS     |  |           |